



A PUBLIC HOSPITAL'S COVID-19 RESPONSE



SAN MATEO COUNTY HEALTH
**SAN MATEO
MEDICAL CENTER**



OUR VISION

Every patient will live their healthiest life.

We provide excellent healthcare for people who experience social, environmental, or economic challenges

SAFETY NET HOSPITAL & CLINIC SYSTEM

7

ICU

62

MED/SURG

64

SKILLED
NURSING

34

INPATIENT
PSYCH



MEDICAL
HOME FOR
44,000
PATIENTS



11
CLINICS
7
LOCATIONS

PATIENT DIVERSITY

- Mexican
- White
- Filipino
- Guatemalan
- Salvadoran
- African American
- Chinese
- Other

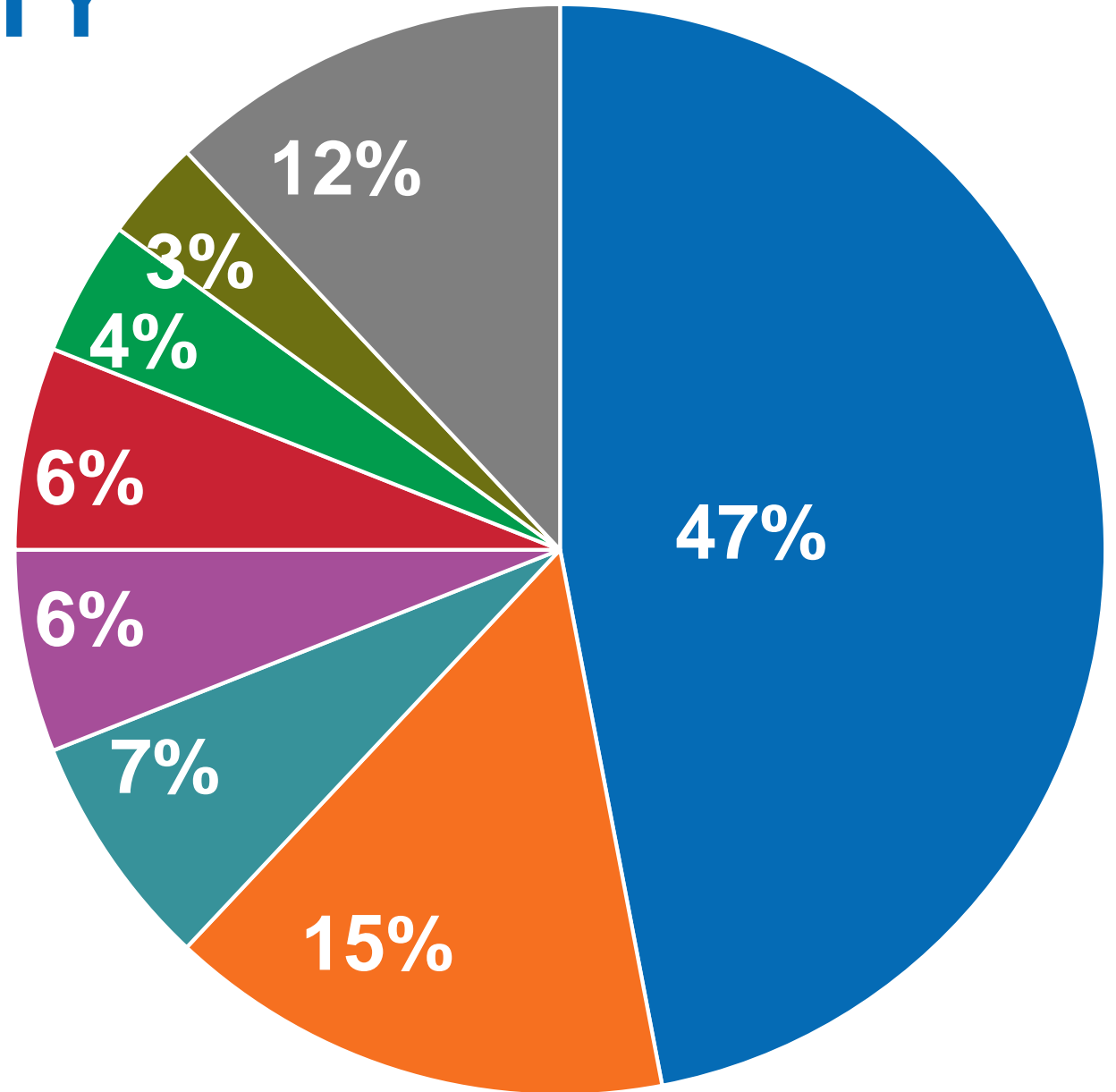

HEALTH INSURANCE

- Medi-Cal
- Medicare
- Charity Care
- Self Pay
- Other

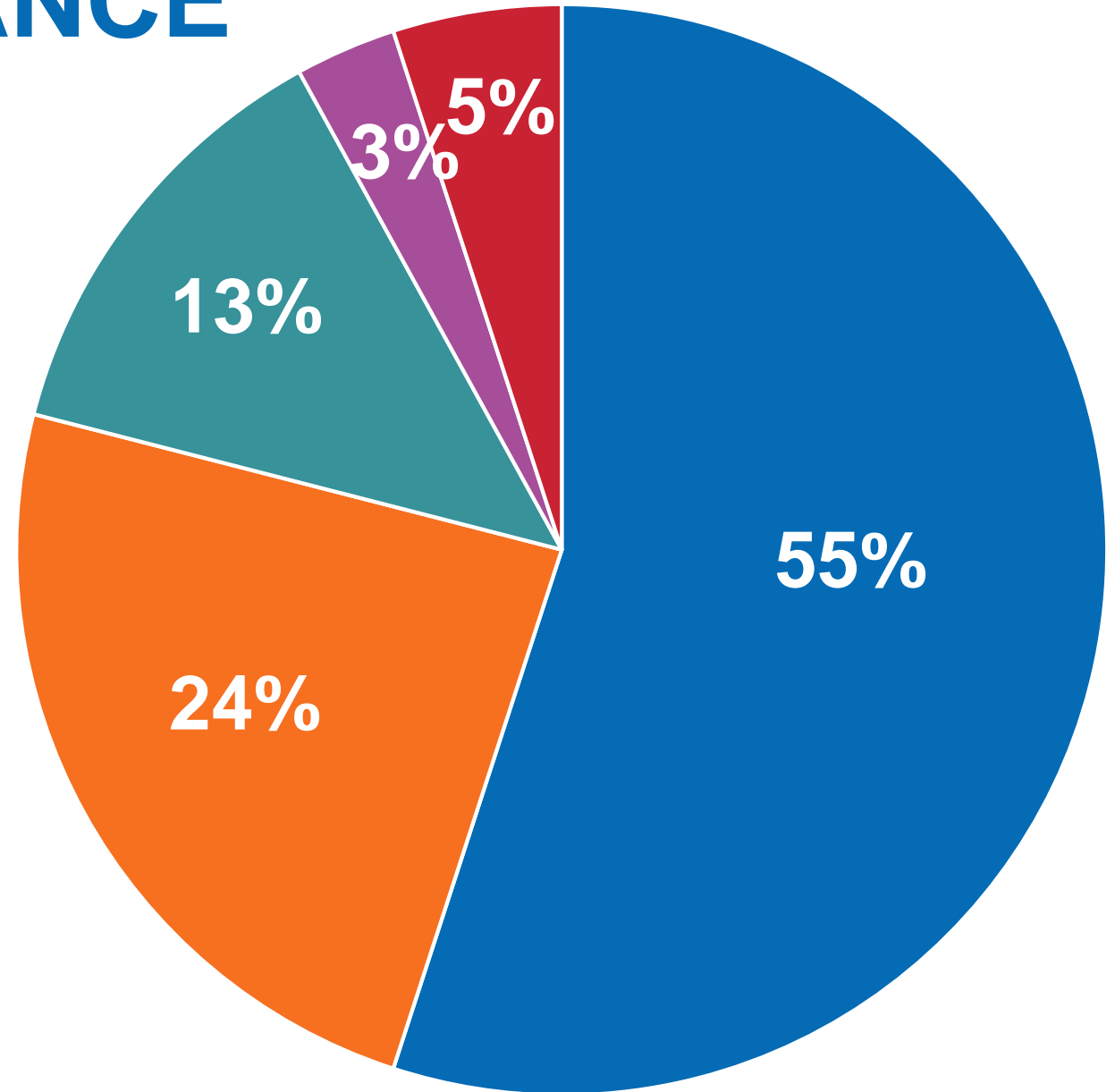

OUR BUDGET & WORKFORCE



\$351M
ANNUAL
BUDGET



487
MEDICAL
STAFF



1257
STAFF

COVID RESPONSE

OUR ROLE AS AN ESSENTIAL HOSPITAL



COVID+ PATIENTS TREATED

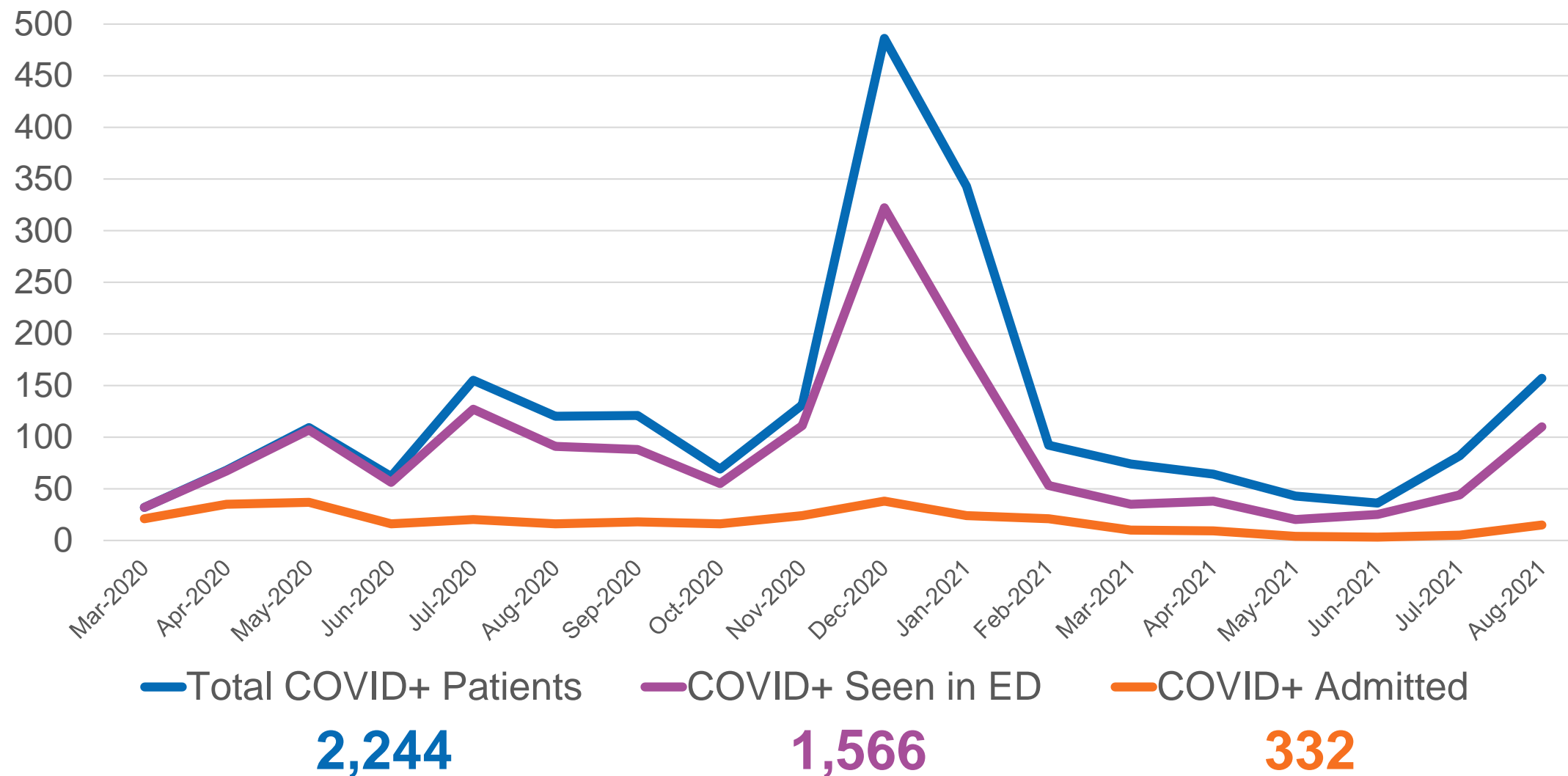



FOCUS ON SAFETY

- Screening and masking
- Physical space assessments (distancing, plexiglass, work from home)
- Telehealth
- Curbside care (testing, routine vaccinations)



SURGE PLANNING

- Expand ED capacity
- Create negative pressure rooms
- 2 surge tents
- Update surge plan (supplies, training, staffing)

COVID+ PATIENTS ADMITTED

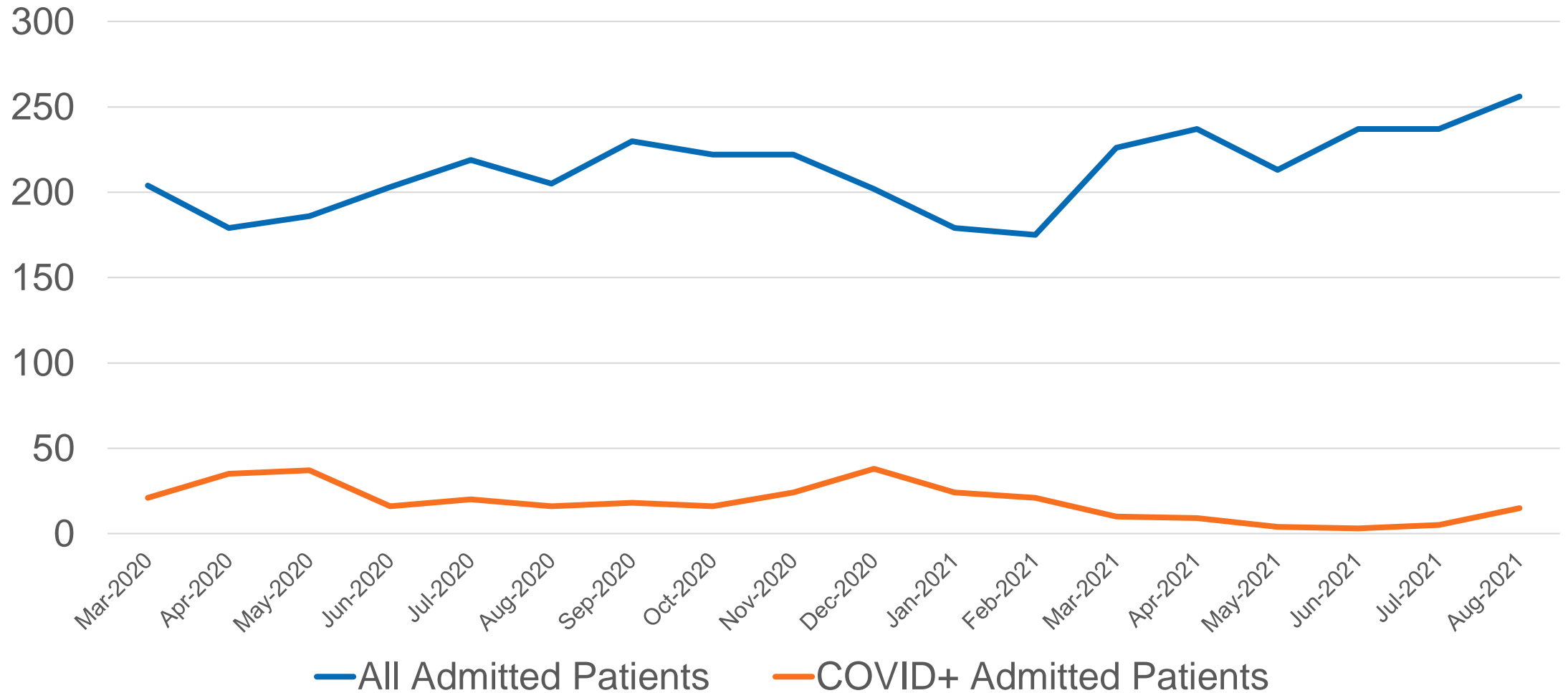

% OF ADMITTED PATIENTS W/ COVID

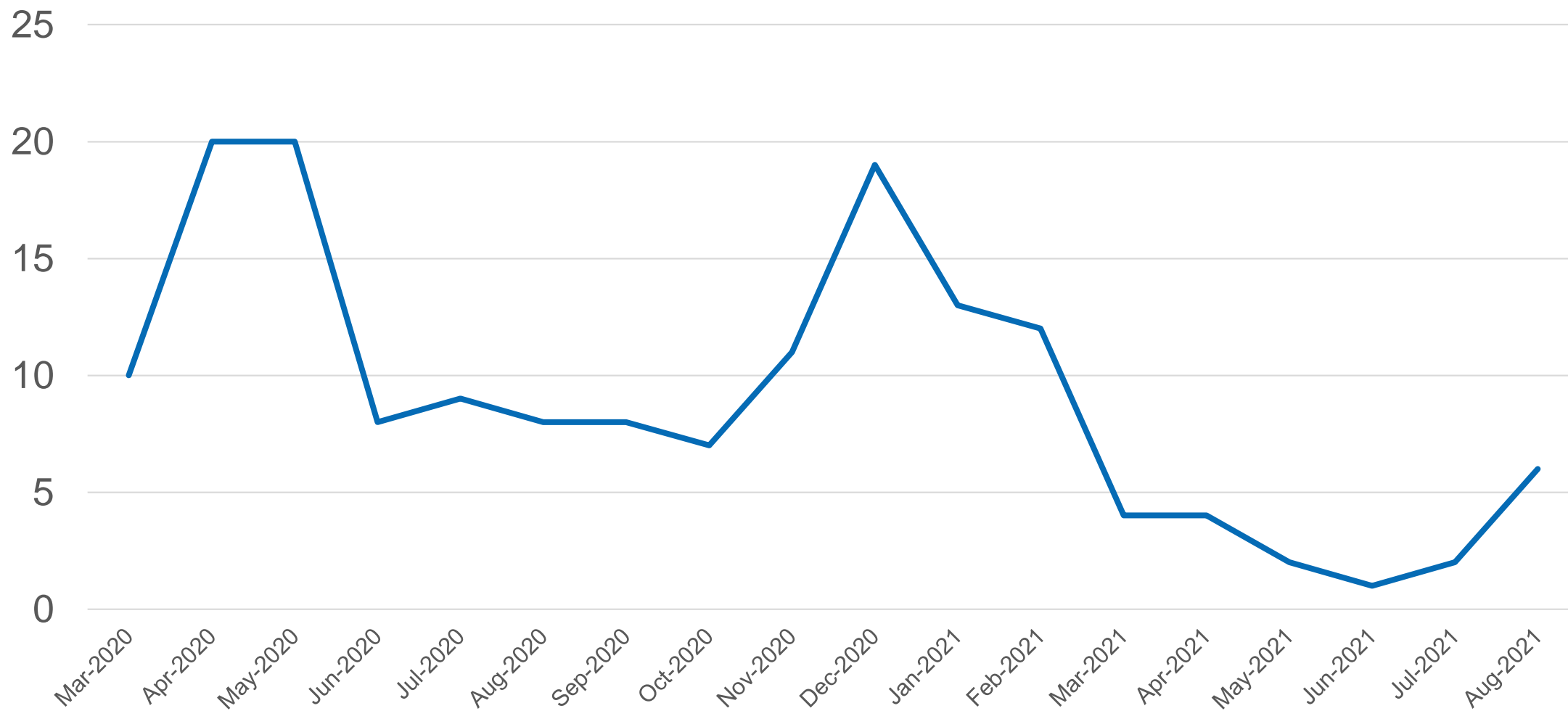



VACCINATIONS

- Dec 2020: Staff
- Jan 2021: Patients
 - During in-person clinic visits
 - Large clinics
 - Curbside clinics
- Partnering with SMC Health and County to reach at-risk patients

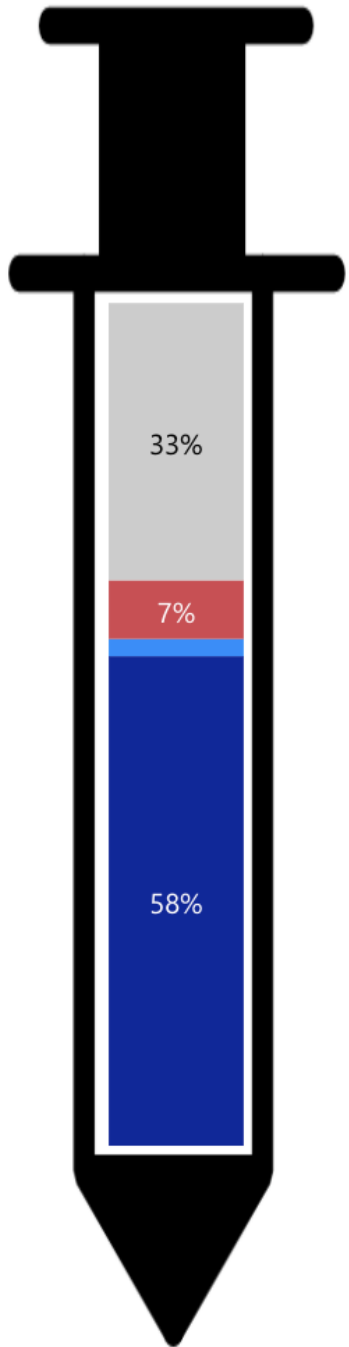

PATIENT VACCINATIONS

VACCINE STATUS	# OF PATIENTS	PERCENT
Not Vaccinated	18,375	33%
Partially Vaccinated	5,033	9%
Fully Vaccinated	32,451	58%
TOTAL	55,859	100%



REMOBILIZING

We never closed!

- Addressing delayed care needs
- Safely bringing patients and staff back on campus
- Continue vaccine efforts

SAN MATEO HEALTH CAMPUS CONSTRUCTION PROJECT



SEISMIC SAFETY REQUIREMENTS

- Hospital Seismic Safety Act (2030)
- Move acute care services out of admin to hospital (2020)
- Move MRI Unit and Mobile Dental Clinic
- Replace 1954 building (administration and entrance)
- County Project Development Unit is leading the project

PROJECT TIMELINE

CONSTRUCTION FROM Q1 2020-Q12024

2020				2021				2022				2023				2024										
Q1	Q2	Q3	Q4	Q1	Q2	Q3	Q4	Q1	Q2	Q3	Q4	Q1	Q2	Q3	Q4	Q1										
J	F	M	A	M	J	J	A	S	O	N	D	J	F	M	A	M	J	J	A	S	O	N	D	J	F	M
NURSING WING GROUND FLOOR RENNOVATION																										
CENTRAL PLANT INTERIOR RENOVATION																										
NEW BUILDING A																										
								1954 DEMOLITION																		
								HSB DEMOLITION								NEW BUILDING B AND SITE WORK										
												CUP LOADING DOCK														

NURSING WING GROUND FLOOR

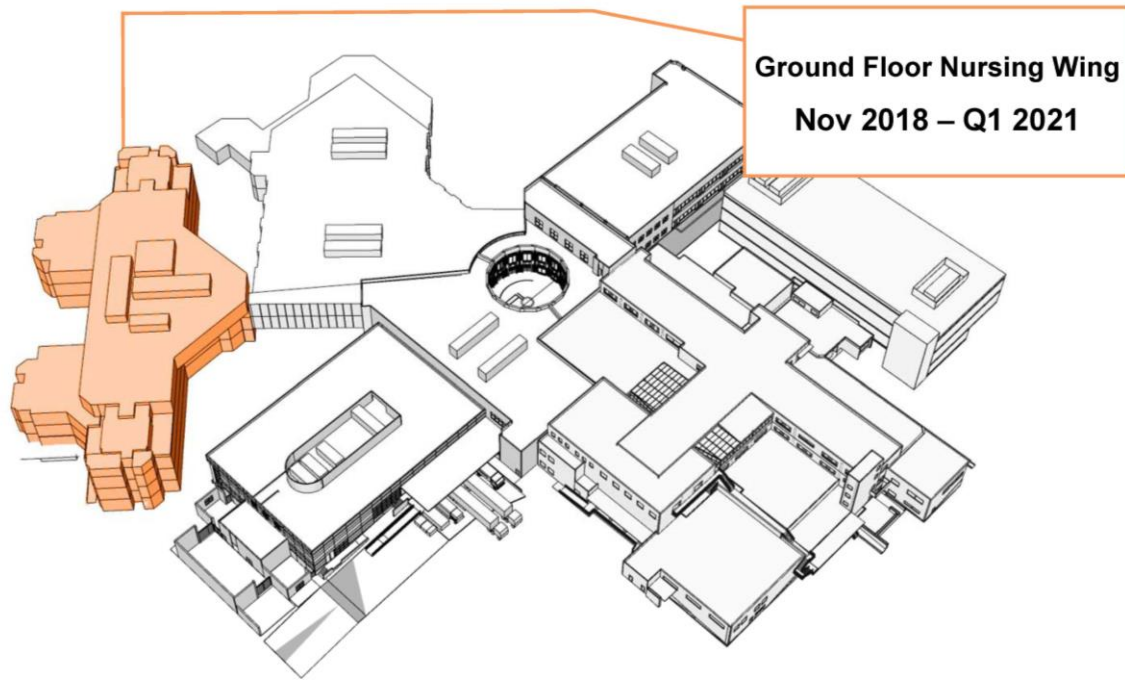

NURSING WING, GROUND FLOOR
FINAL PLAN

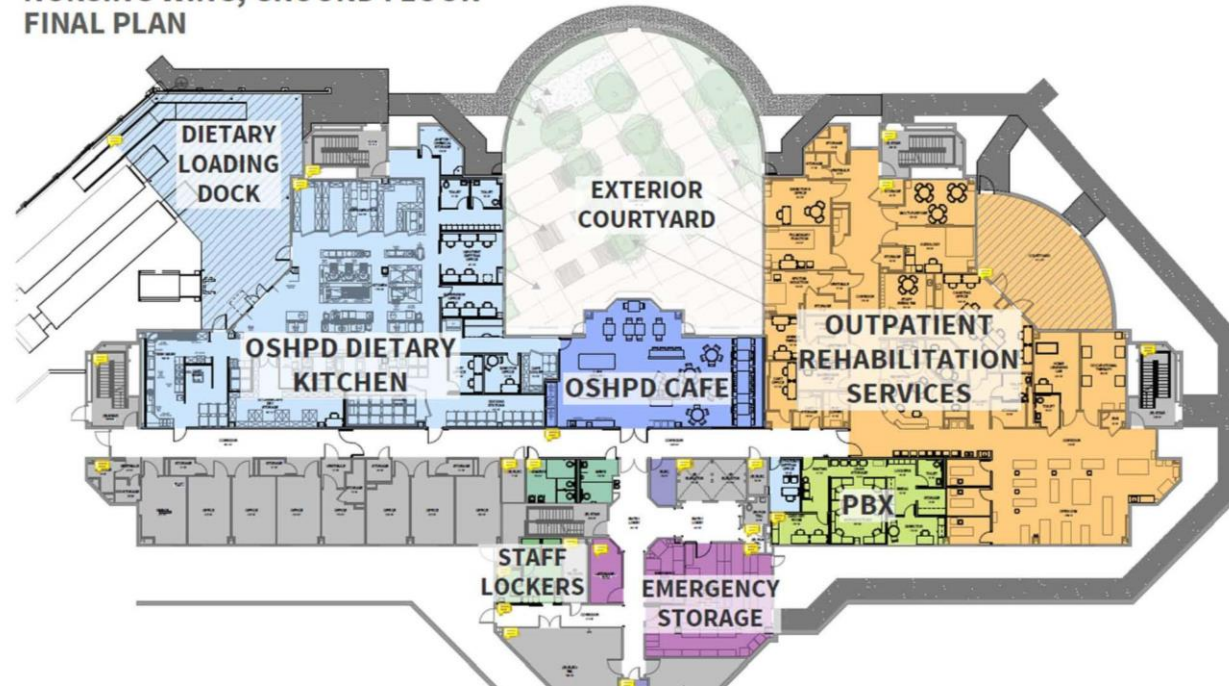

CENTRAL PLANT FIRST FLOOR

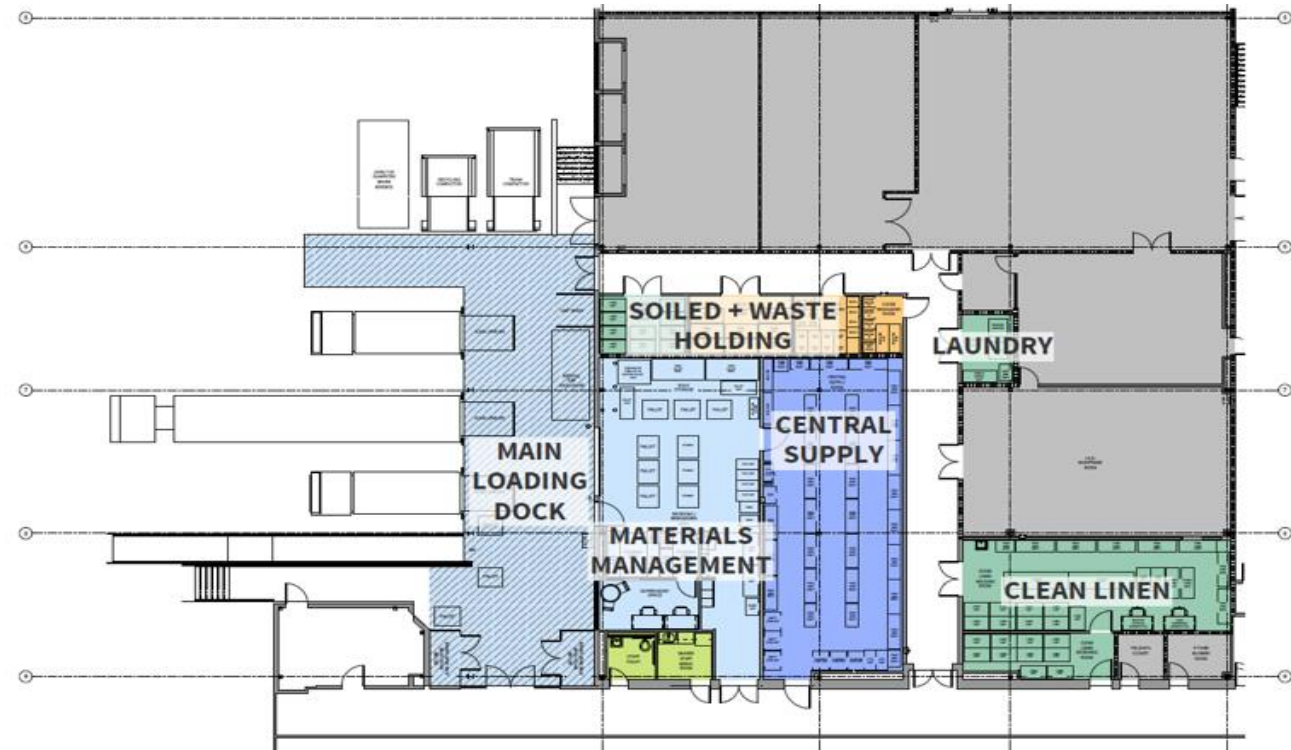
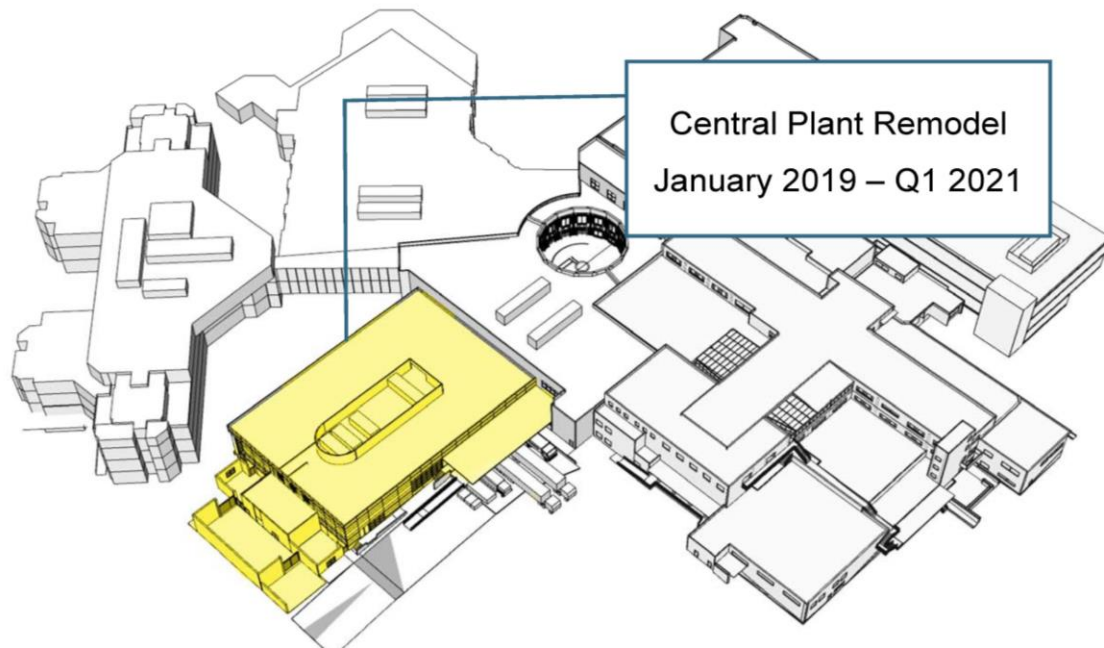

NEW ADMINISTRATION BUILDING

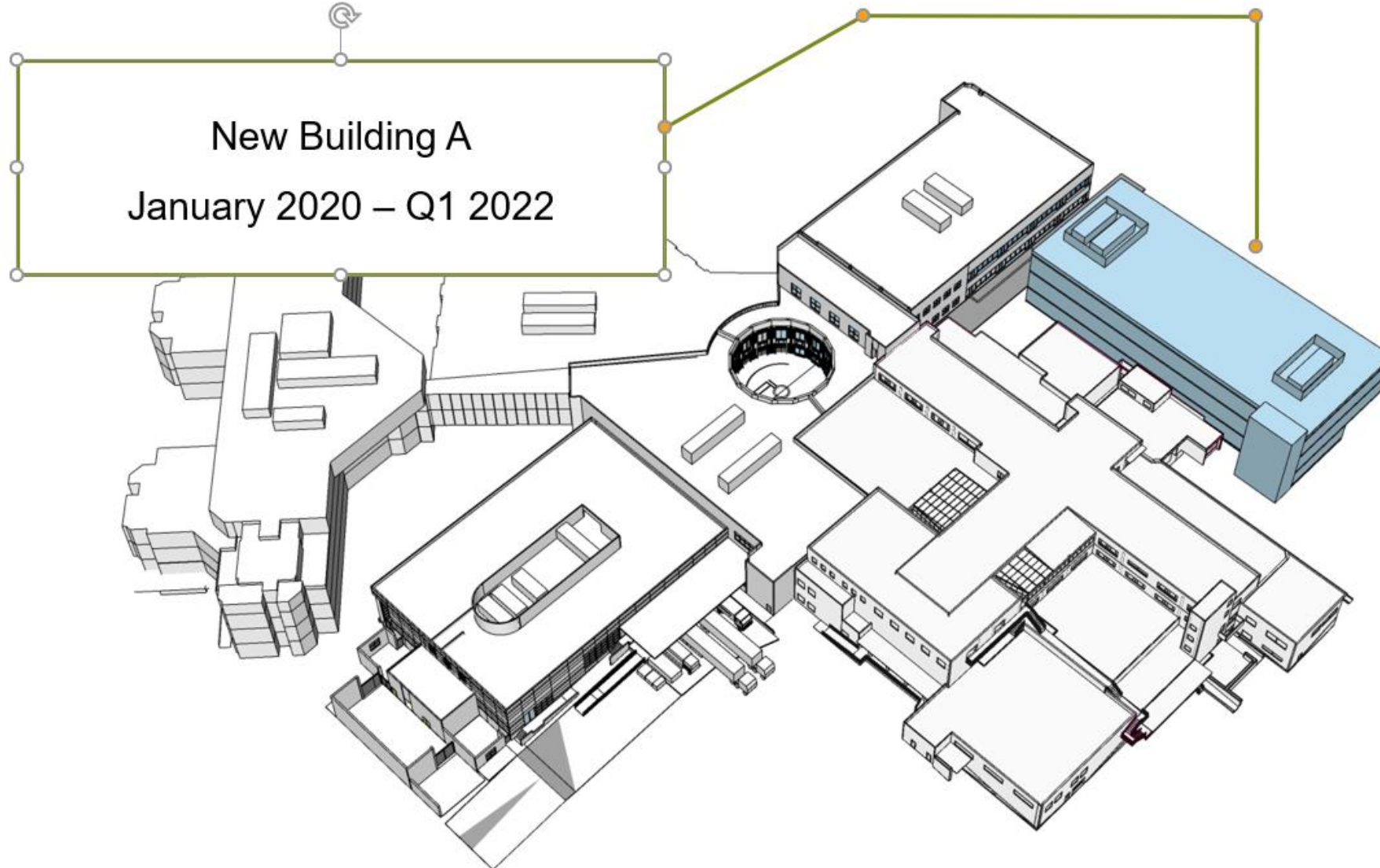

NEW ENTRANCE BUILDING (LINK)

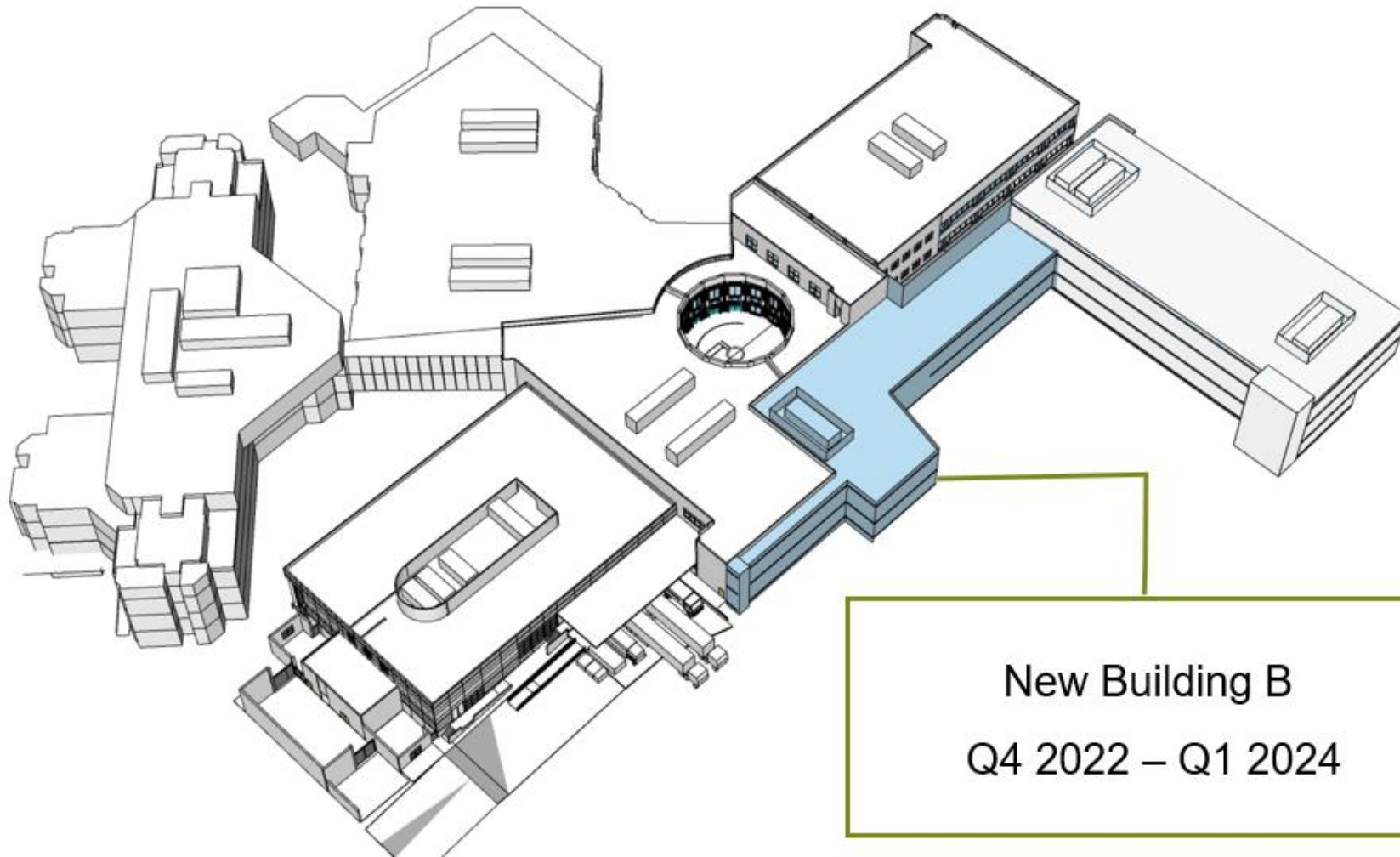

New Building B
Q4 2022 – Q1 2024

PROPOSED SITE PLAN

37 AVENUE

HACIENDA

EDISON



39 AVENUE





QUESTIONS



SAN MATEO COUNTY HEALTH
**SAN MATEO
MEDICAL CENTER**