

PROPERTY OWNERS MEETING SEWER SERVICE RATES

**Crystal Springs County Sanitation District
(District)**

*Highlands Recreation Center
Multipurpose Room
1851 Lexington Avenue
San Mateo, CA*

*May 23, 2018
6:30 P.M.*

Department of Public Works



OVERVIEW OF TONIGHT'S MEETING

- ***District Information***
- ***District Funding***
- ***What's Taken Place Since Last Rate Adjustment***
- ***Elements of the Sewer Service Rates***
 - ***In District Costs***
 - ***Out of District Costs***
- ***Proposed Rate***
- ***Rate Setting Timeline***
- ***Questions and Comments***

DISTRICT INFORMATION

SEWAGE FLOWS THROUGH TOWN OF HILLSBOROUGH AND CITY OF SAN MATEO TO THE CITY'S TREATMENT PLANT AT 2050 DETROIT DRIVE FOR TREATMENT

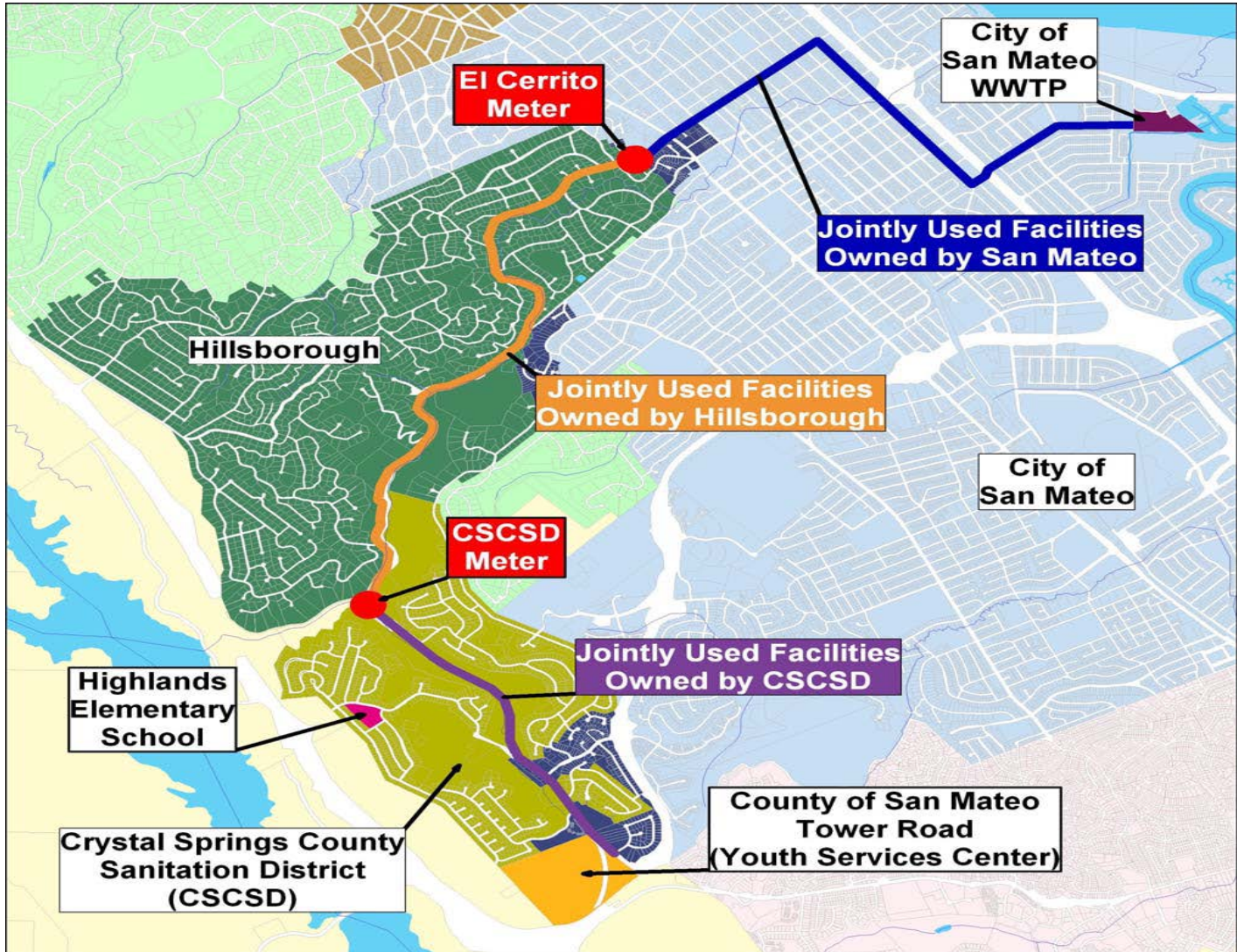

DISTRICT INFORMATION – HOW DOES A SEWER SYSTEM WORK?

EACH DISTRICT RELIES ON DOWNSTREAM AGENCIES TO TRANSPORT SEWAGE COLLECTED BY THE DISTRICT TO THE TREATMENT PLANT

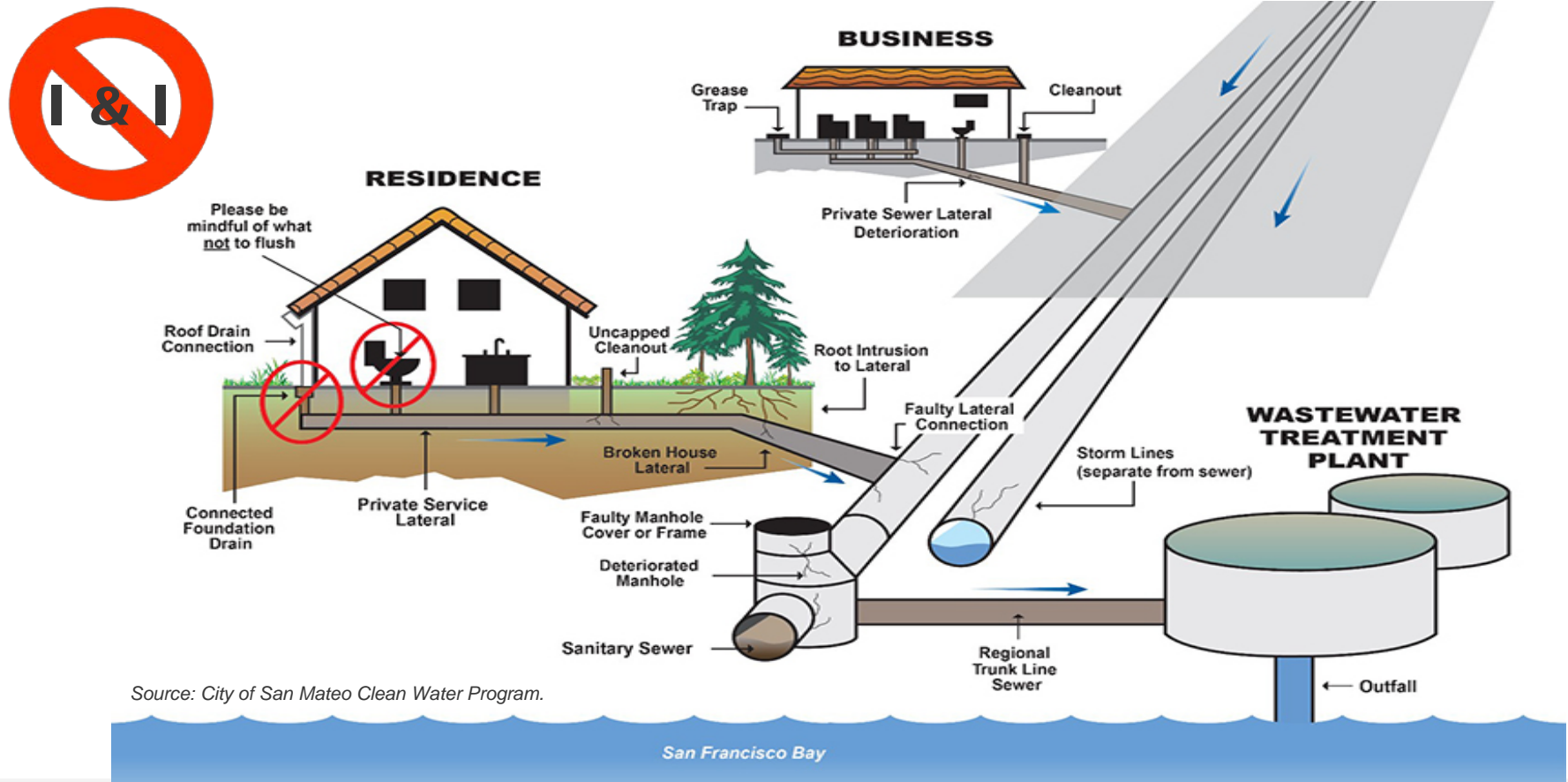

DISTRICT SPECIFIC STATISTICS

District	Age (yrs) *	Number of Connections **	Equivalent Residential Units **	Downstream Transport Agency	Treatment Facility
Crystal Springs County Sanitation District	71	1,434	1,531	City of San Mateo	City of San Mateo

**Age based on District formation date*

*** Based on 2017-18 SSC Report*

District	Miles of Pipe (Feet)	Percentage in Easements	Percentage in Streets
Crystal Springs County Sanitation District	18 (95,100 ft)	15%	85%

SEWER/SANITATION DISTRICTS IN COUNTY GOVERNMENT

EACH DISTRICT IS AN INDEPENDENT ENTITY WITH ITS OWN SEPARATE BUDGET

- Each District's Governing Board is the Board of Supervisors
- The District receives Sewer Service Charges and limited property taxes within the District boundaries to fund sewer service
- The Sewer Service Charges are a Fee For Service, Not a Tax
- The District collects Sewer Service Charges on the Tax Bill because it is least costly way to collect the fee

WHERE DOES MY PROPERTY TAX MONEY GO?

CSCSD Sample Property Tax Allocation (TRA 078-018)

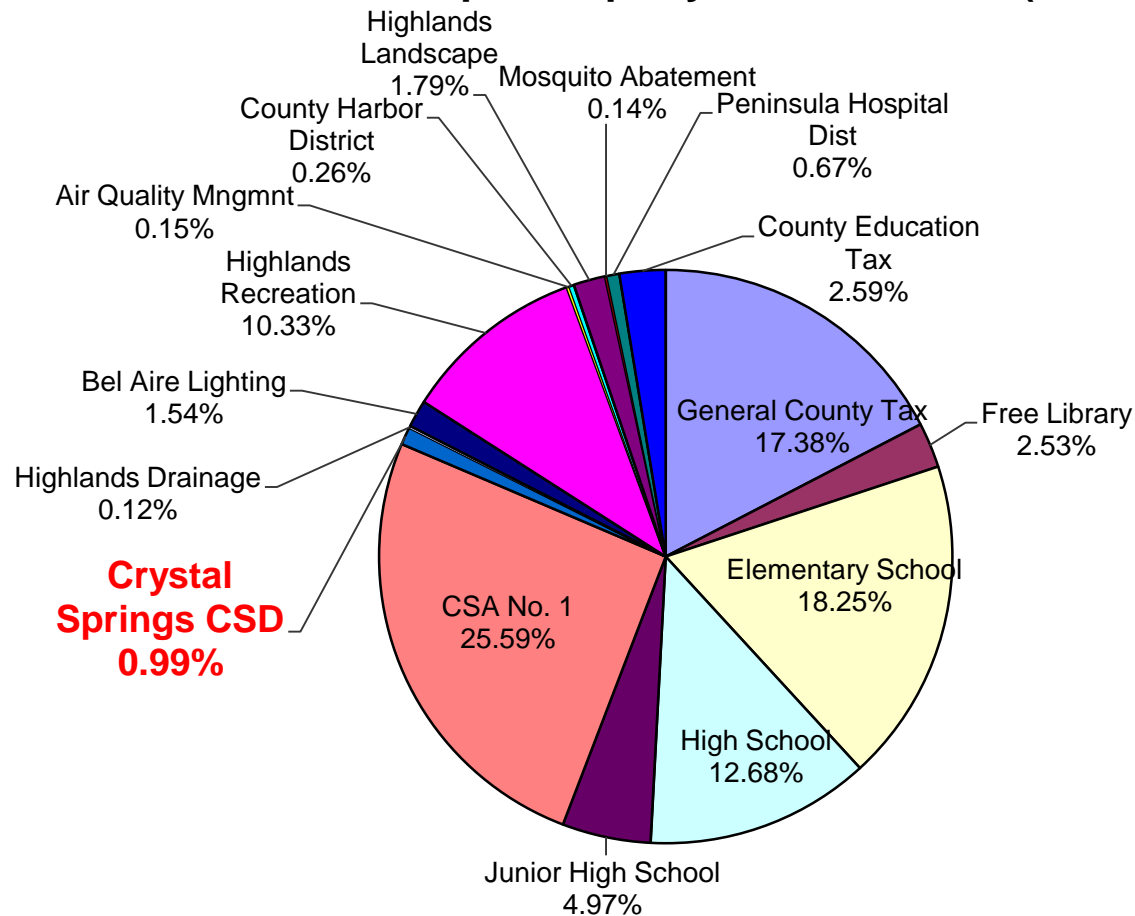

Note: CSCSD allocation of a portion (0.99%) of the property tax is approximately \$60,000 per year.

WHAT'S TAKEN PLACE SINCE LAST RATE ADJUSTMENT

- ***Completed Capital Improvement Projects in 1999 Master Plan with State Revolving Fund loan (\$1.95 million loan, 2.1%, 20 years)***
- ***Paid District's share of the Crystal Springs/El Cerrito Sewer Trunk Line projects completed by the Town of Hillsborough and City of San Mateo (\$7.3M County Loan)***
- ***Seneca Lane mudslide (2017) emergency response and temporary bypass***
- ***Contributed to the purchase of maintenance equipment (CCTV camera, flushing/vacuum trucks, pickup trucks, and dump truck)***
- ***Sanitary Sewer Overflow (SSO) Response, Reporting, Water Quality Monitoring, and Public Awareness Program***
- ***Continue to provide 24/7 emergency response to clear blockages in private laterals***

WHAT'S TAKEN PLACE SINCE LAST RATE ADJUSTMENT

1999 MASTER PLAN CAPITAL IMPROVEMENT PROJECTS COMPLETED IN 2014



Replaced 2,230 feet of pipes in easements & 8,540 feet of pipes in streets (11% of District mains) funded by State Revolving Fund Loan with 20-year term and interest rate @ 2.1%

WHAT'S TAKEN PLACE SINCE LAST RATE ADJUSTMENT

SENECA LANE MUDSLIDE EMERGENCY RESPONSE AND TEMPORARY BYPASS



Jan. 24, 2017 – Feb. 15, 2017: District maintenance staff responded to a mudslide that damaged a section of the District's sewer main in the easement behind Seneca Lane, installed temporary bypass system, and monitored the bypass pump system 24 hours/day until PG&E approved a power connection.

SENECA LANE MUDSLIDE PERMANENT REPAIR

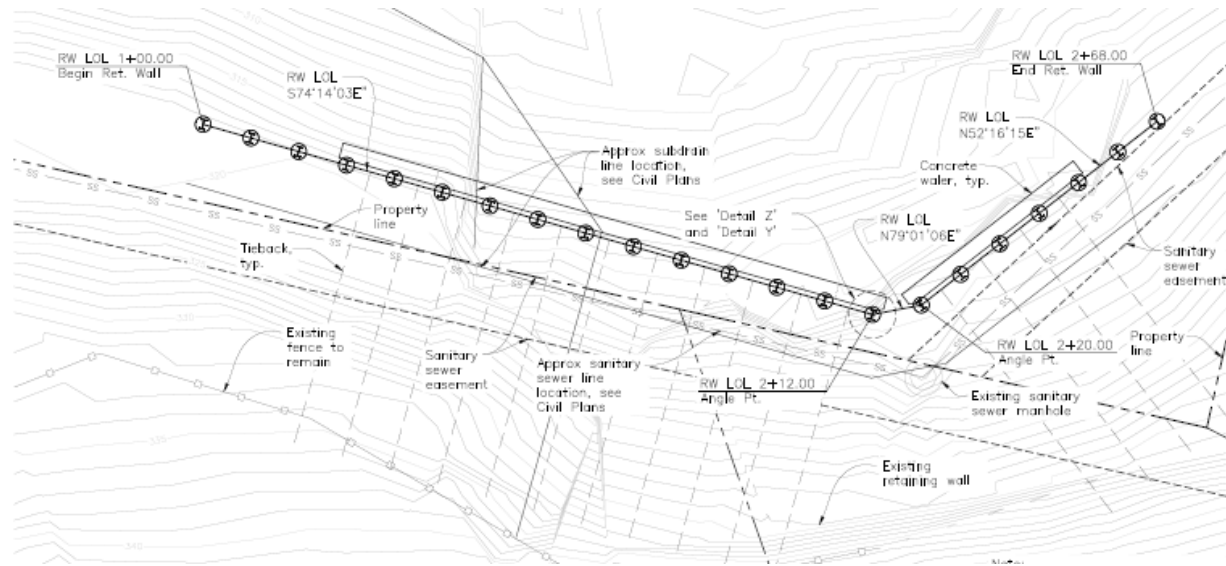
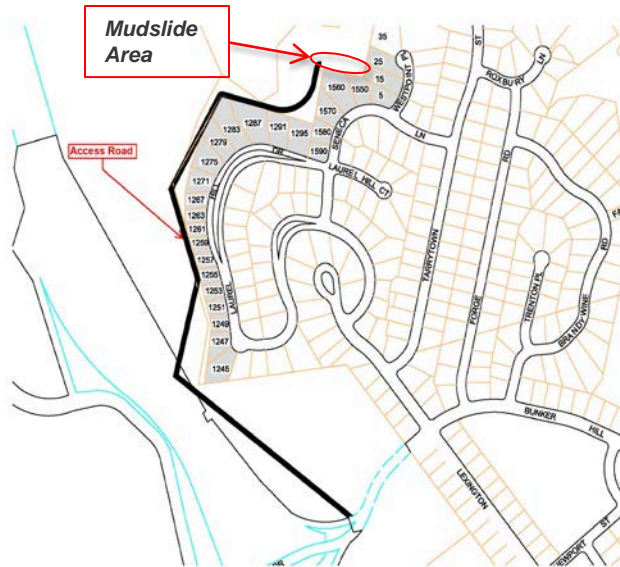

Selected Repair Option – Soldier Pile Retaining Wall with Tie-Backs

- Soldier pile wall with horizontal reinforced concrete beams between piles.
- Steel ground anchors (tie-backs) placed in drilled holes extending from the wall face to soil or bedrock.
- Estimated construction cost is \$1.9M; Total estimated cost \$2.7M.
- District is working with FEMA to seek reimbursement for eligible work associated with response, repair, design, and construction of permanent repair.

WHAT'S TAKEN PLACE SINCE LAST RATE ADJUSTMENT – OUT OF DISTRICT COSTS

CRYSTAL SPRINGS/EL CERRITO SEWER TRUNK LINE PROJECT PHASE II (TOWN OF HILLSBOROUGH)

- ***Project elements:***
 - ***Upsized 9,600 feet of 8-in. to 15-in. diameter pipes with 18-in. diameter pipes on Crystal Springs Road and El Cerrito Avenue***
- ***Project completed in Feb. 2017***
 - ***Total estimated cost - \$12,000,000***
 - ***Preliminary project closing cost - \$10,007,515***
- ***District share of project costs (paid with County loan proceeds):***
 - ***Percent – 37% of eligible costs (based on wet weather flow)***
 - ***\$3,702,780***

WHAT'S TAKEN PLACE SINCE LAST RATE ADJUSTMENT – OUT OF DISTRICT COSTS

EL CERRITO TRUNK RELIEF LINE PROJECT (CITY OF SAN MATEO)

➤ Project elements:

- ***Constructed 10,000 feet of 27-in. and 30-in. diameter pipes as relief line for wet weather flows***

➤ Project completed in May 2017

- ***Total estimated cost - \$15,000,000***
- ***Final project cost - \$11,587,347***

➤ District share of project (paid with County loan proceeds):



- ***Percent – 37% of eligible costs (based on wet weather flow)***
- ***\$3,573,657***

WHAT'S TAKEN PLACE SINCE LAST RATE ADJUSTMENT

POLLUTION PREVENTION/PUBLIC AWARENESS PROGRAM

Be Sewer Savvy:
Notes, tips & tricks to help keep your sewer pipes in tip-top shape.

- ✓ Protect your home
- ✓ Protect your business
- ✓ Avoid costly repairs

And prevent water pollution, too!



AVOID SEWER BACKUPS AND OVERFLOWS BY KEEPING TRASH OUT OF YOUR TOILET



Did you know?
Chemical wipes, baby wipes and facial wipes are one of the biggest causes for clogged sewer pipes. They are not flushable. They are not designed to be flushed. They are not designed to be flushed. NEVER be flushed. They belong in the trash.

Flush ONLY toilet paper. Put trash in the trash can.
For more information please visit our website at www.smcgov.org/sewers or call us at 650-543-4100.

WHEN IT COMES TO GARBAGE, IT BELONGS IN THE TRASH.

Your district, street and trash can. The water from your home is treated (drinking, swimming, etc.) and eventually ends up in one of the water treatment plants of our community, the San Francisco Bay.

Remember, anything other than toilet paper down the drain can cause sanitary issues and/or clogs. It will not be properly treated, may cause odors, and the potential for the treatment plant.

PROPERLY DISPOSING OF YOUR WASTE WILL HELP PROTECT PUBLIC HEALTH AND THE ENVIRONMENT.



www.smcgov.org/sewers

San Mateo Hills Sewer Maintenance District
Crystal Springs County Sanitation District
Devonshire County Sanitation District
Edgewood Sewer Maintenance District
Emerald Lake Heights Sewer Maintenance District
Fair Oaks Sewer Maintenance District
Harbor Industrial Sewer Maintenance District
Kensington Square Sewer Maintenance District
Oak Knoll Sewer Maintenance District
Science Heights County Sanitation District

Department of Public Works
111 County Center, 3rd Fl.
Redwood City, CA 94061
(650) 763-4100

For more information about
San Mateo Hills Sewer Maintenance District and the
San Mateo Countywide Water Pollution Prevention Program
visit www.smcgov.org/sewers

**RETHINK WHAT YOU FLUSH...
FLUSH GREEN**



PROTECTING WATER QUALITY
FOR OUR WATER BODIES AND US

Understanding Your Sewer System and What You Pay For

Para obtener una copia de este folleto en Español, favor de llamar al (650) 599-1443

What Is a Sanitation/Sewer District?
A sanitation/sewer district is a Special District formed for a specific area to provide sewer service to the properties within the district boundary. Each sanitation/sewer district has its own budget with money collected from the district and spent within the district. While the Board of Supervisors serves as the Governing Board for the sanitation/sewer districts operated by the County of San Mateo, the districts are separate legal entities from the County of San Mateo.

What Is Sewer Services?
Sewer service includes sewer system operation and maintenance, emergency response, construction of new sewer pipes or replacement of sewer pipes within the districts, and complying with regulatory requirements. The districts are also responsible for paying its share for sewage treatment and disposal, construction projects that carry sewage from the districts to the wastewater treatment plant and construction projects at the treatment plants. The wastewater generated from properties within the district is carried in the district sewer pipes to the sewer pipes maintained by the downstream agency, and travels to the wastewater treatment plant.

This information is being provided to inform you of the importance of a reliable sewage system. Proper maintenance of the sewer system helps protect the environment, minimizes the chances of sewer backups or service disruptions, and minimizes overall sewer system costs.

COUNTY MAINTAINED DISTRICTS:
Burlingame Hills Sewer Maintenance District
Crystal Springs County Sanitation District
Devonshire County Sanitation District
Edgewood Sewer Maintenance District
Emerald Lake Heights Sewer Maintenance District
Fair Oaks Sewer Maintenance District
Harbor Industrial Sewer Maintenance District
Kensington Square Sewer Maintenance District
Oak Knoll Sewer Maintenance District
Science Heights County Sanitation District

For more information, contact the Public Works Department at (650) 261-4100, between 8 a.m. and 5 p.m. Monday through Friday, or go to www.smcgov.org/sewers



Beginning in 2012, brochures have been distributed to customers during service calls and mailed to customers upstream of a sanitary sewer overflow. Copies are also available on website at <http://www.smcgov.org/sewers>

WHAT'S TAKEN PLACE SINCE LAST RATE ADJUSTMENT

SANITARY SEWER OVERFLOWS (SSO)

District	2012	2013	2014	2015	2016	2017	2018 (to date)
CSCSD	6	3	11	4	0	6*	2*

Basin Cleaning implemented in 2014

Primary Causes of SSOs: Roots, Paper Towels, and Heavy-duty Wipes.

* 3 (2017) and 1 (2018) SSO occurrences due to Seneca Lane mudslide site



**The toilet is only meant
to flush the three P's—
pee, poop and paper.**

WHAT'S TAKEN PLACE SINCE LAST RATE ADJUSTMENT

REGULATORY COMPLIANCE:

- ***State Water Resources Control Board***
 - ***Development and continuous updating of Sewer System Management Plan (SSMP)***
 - ***Reporting to State Office of Emergency Services certain types of SSO's within 2 hours***
 - ***Sampling of water within 48 hours when SSO enters a creek or stream***
 - ***Training maintenance staff on SSO response***
 - ***2009 Cease and Desist Order - Annual Reports due May 15th:***
 - a) ***Sewer System Cleaning and Root Control Program***
 - b) ***Infrastructure Renewal***
 - c) ***Progress of Short and Long Term Improvements***

DISTRICT EXPENSES

IN DISTRICT COSTS:

- ***Operation and Maintenance***
- ***Regulation Compliance***
- ***District Projects***



OUT OF DISTRICT COSTS:

- ***Sewage Transport and Treatment***
- ***Downstream Agency Capital Improvement Projects***



ELEMENTS OF THE SEWER SERVICE RATES **– CAPITAL IMPROVEMENT PROJECTS (CIP)**

HIGH PRIORITY CIPS IDENTIFIED THROUGH CONDITION ASSESSMENTS

- ***Improvements are recommended based on the following:***
 - ❖ ***Lack of capacity in pipe***
 - ❖ ***Excessive maintenance costs***
 - ❖ ***Structural defects in pipe***
- ***Portions of your Sewer Service Charges collected are used to pay for improvements.***

Recommended Capital Improvement Projects



Crystal Springs
County
Sanitation District

Project
Completed in
2014 (SRF Loan)

Legend

- 1999 Master Plan CIP
- Urgent Point Repairs
- Ezmt Parrott-Randall
- Ezmt Billy Goat Hill
- Ezmt Roxbury to Polhemus
- Ezmt Bel Aire to Rainbow
- Ticonderoga
- Lexington-Yorktown East
- Ezmt Ascension to Polhemus
- Lexington-Yorktown West
- Ezmt Lexington-PG&E



0 250 500 1,000
Feet

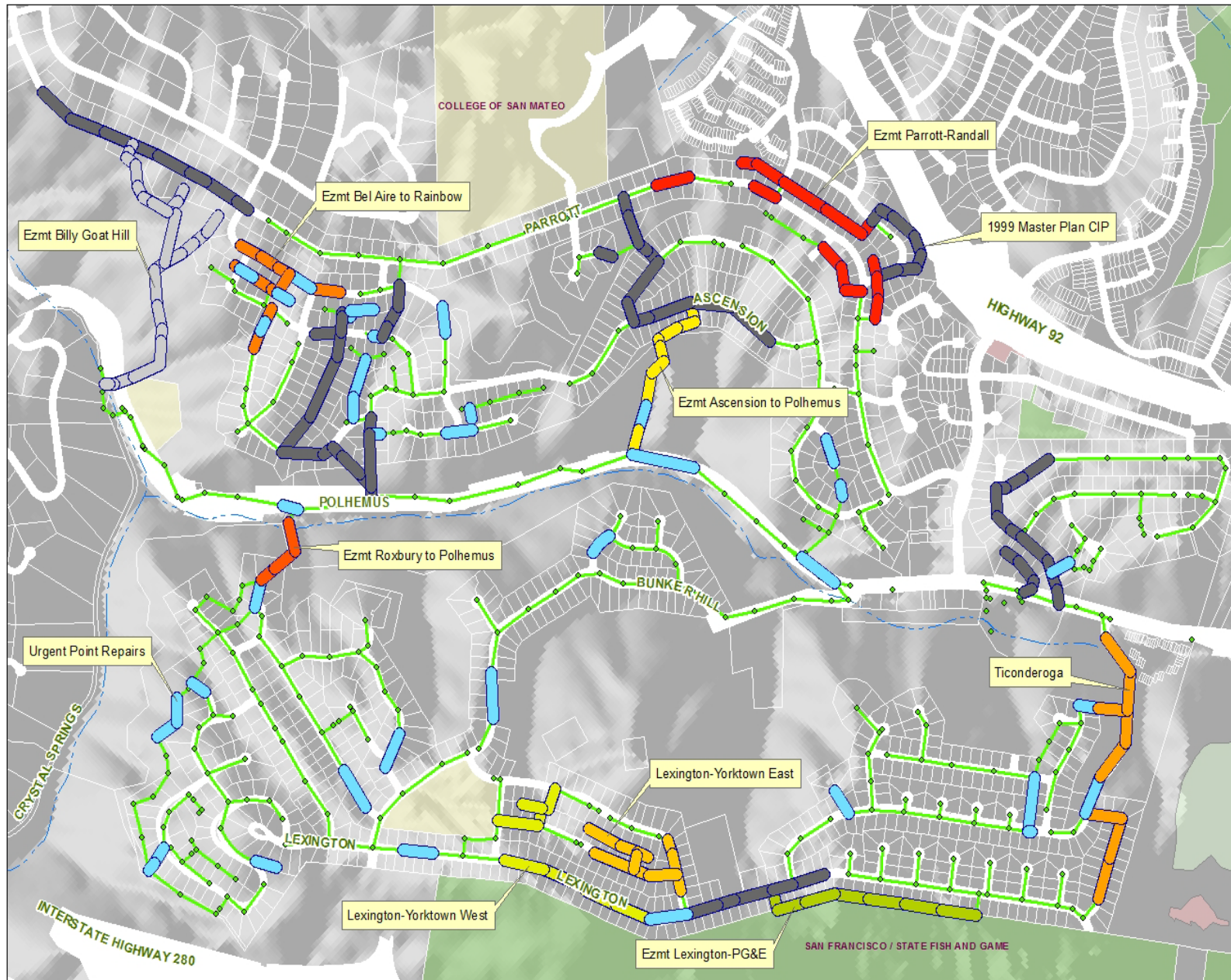

PRIORITY OF REMAINING CAPITAL IMPROVEMENT PROJECTS:

Project Location

Estimated Cost

Currently in Design

Seneca Lane Mudslide Permanent Repair (~174 ft)	\$2,700,000
Urgent Point Repairs (42 Locations)	\$275,660

Future Projects

Easement between Parrott and Randall	\$714,000
Easement along Billy Goat Hill	\$882,000
Easement from Roxbury to Polhemus	\$207,000
Easement from Bel Aire to Rainbow	\$537,000
Ticonderoga (Upper Portion)	\$741,000
Lexington-Yorktown East	\$465,000
Easement from Ascension to Polhemus	\$354,000
Lexington-Yorktown West	\$612,000
Easement between Lexington and PG&E	\$501,000

**Total Cost for Future Projects ~ 16,700 feet of Pipe
(18% of District mains)**

\$5.013 M

ELEMENTS OF THE SEWER SERVICE RATES **– OUT OF DISTRICT COSTS**

PAYING FOR SEWAGE TRANSPORT, TREATMENT, AND DISPOSAL

- ***Sewage Transport, Treatment, and Disposal***
- ***Downstream Agency Capital Improvement Projects***
 - ***City of San Mateo Clean Water Program (CWP)***
 - ***Crystal Springs CSD's share of contribution is estimated to be over \$3.5 million each for 30 years with 100% bond financing exclusively for the CWP expenses***

ELEMENTS OF THE SEWER SERVICE RATES – OUT OF DISTRICT COSTS



Source: City of San Mateo Clean Water Program.

CITY OF SAN MATEO CLEAN WATER PROGRAM (CWP) – WASTE WATER TREATMENT PLANT (WWTP) COMPONENT



Source: City of San Mateo Clean Water Program.



CITY OF SAN MATEO CLEAN WATER PROGRAM (CWP) – PROJECT COSTS

- ***Program Management - \$85,092,559***
- ***WWTP Nutrient Removal and Wet Weather Flow Management Upgrade - \$532,708,966***
- ***WWTP Immediate Action Projects 1 & 2 - \$34,631,635***
- ***Dale Avenue Pump Station (DAPS) Rehabilitation/Forcemain Replacement - \$41,629,979***
- ***South Idaho Relief Extension - \$1,129,633***

***Total Estimated District Cost Share - \$24,998,000
(based on District flows at DAPS-6.07% & WWTP-5.62%)***



City of San Mateo

Website: City of San Mateo

Mail: Clean Water Program City of San Mateo 330 W. 20th Avenue San Mateo, CA 94403

Telephone: (650) 727-6870

Email: info@CleanWaterProgramSanMateo.org



PROPOSED RATE

	Sewer Service Rate (\$/Year Per Residential Unit)	
	FY 2017-18	Proposed Rate
		FY 2018-19
Crystal Springs County Sanitation District	\$1,350	\$1,415 (+ \$65)

The proposed rate includes a 4.8% increase, equating to an \$65/equivalent residential unit or \$5.42/month/equivalent residential unit increase.

RATE SETTING TIMELINE

Key Dates	Actions
May 8	Sent all property owners information about proposed rates and timing of meetings with property owners.
May 23	Meetings with property owners to discuss the proposed rates, factors involved in establishing rates, and seek property owner input.
June 5	Introduce Ordinance with proposed sewer service rates and set Public Hearing for July 24.
June 8	Send Prop 218 notice (45 days prior to public hearing) to property owners with proposed rates.
July 24	Hold public hearing, adopt Ordinance setting rates, and adopt FY 2018-19 Sewer Service Charges Report based on the adopted rate.

Emergency Response

24 Hours a Day, 7 Days a Week

Mainline (Blockage)

Customer Sewer Laterals

**Call (650) 363-4100 to Report
Sewer Overflows**

CONTACT INFORMATION

Please e-mail your comments and questions to:

sewers@smcgov.org

Information is available on our website at:

<http://www.smcgov.org/sewers>

THANK YOU!

QUESTIONS?



**The toilet is only meant
to flush the three P's—
pee, poop and paper.**

