

SAN MATEO COUNTY DEPARTMENT

DRAWN BY: D.P.
CHECK BY: J.A.L.
APPROVED BY: N.R.C.

OF
PUBLIC WORKS

SCALE: NONE
DATE: 7/97
REVISED: _____

REDWOOD CITY
CALIFORNIA

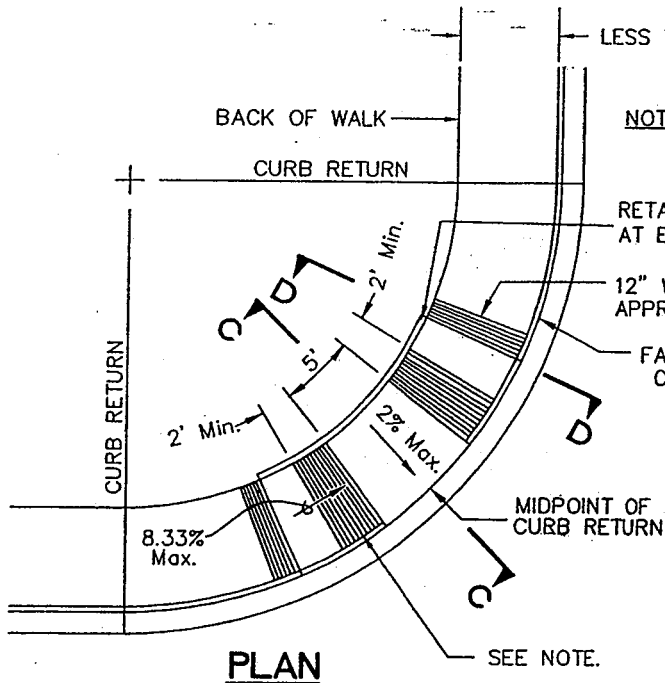

ACCESS RAMP ON CURB RETURN

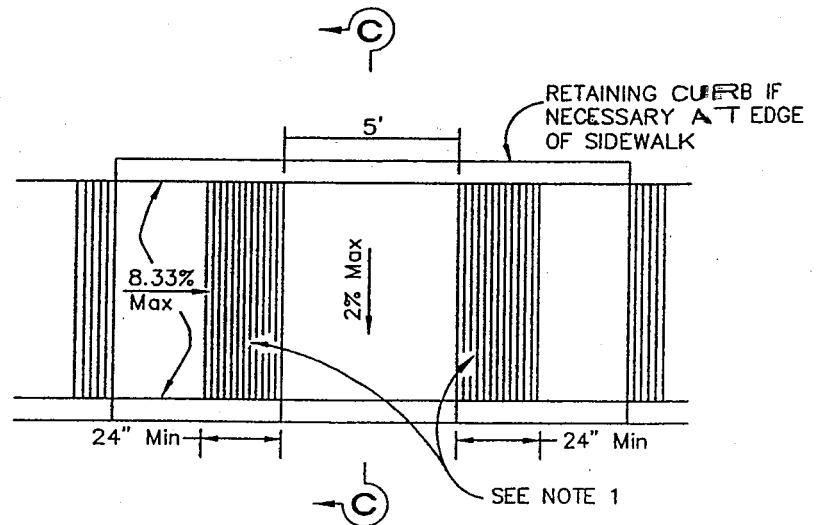

ACCESS RAMP ON TANGENT

USE WHEN SIDEWALK IS LESS THAN 6' WIDE

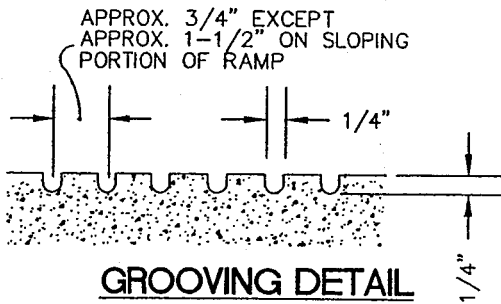

SEE NOTE 2.

SIDEWALK ACCESS RAMP FOR SIDEWALKS LESS THAN 6' WIDE

NO SCALE

(SHEET 1 OF 3)

D-4A

SAN MATEO COUNTY DEPARTMENT

OF

PUBLIC WORKS

REDWOOD CITY
CALIFORNIA

DRAWN BY: D.P.
CHECK BY: J.A.L.
APPROVED BY: N.R.C.

SCALE: NONE
DATE: 7/97
REVISED: _____

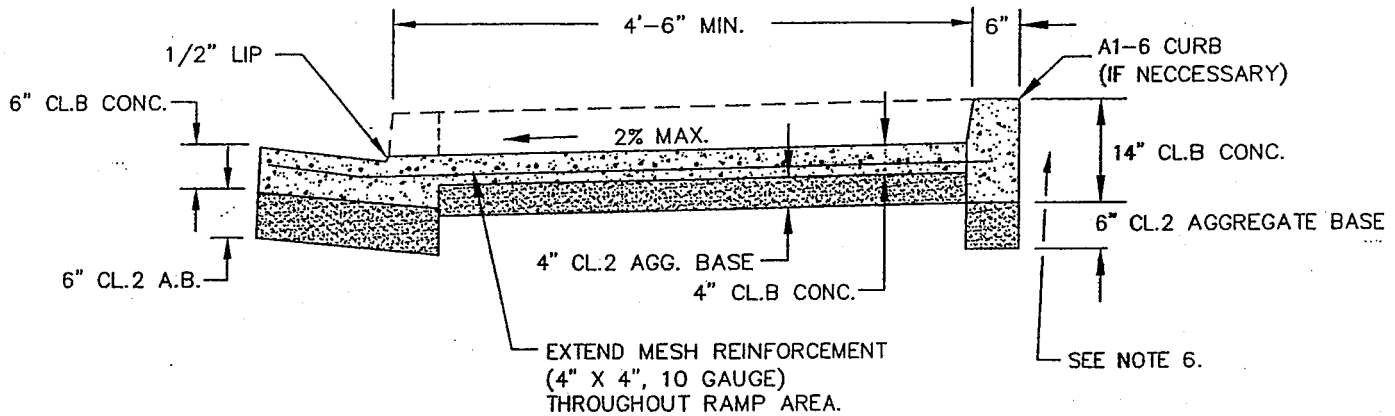
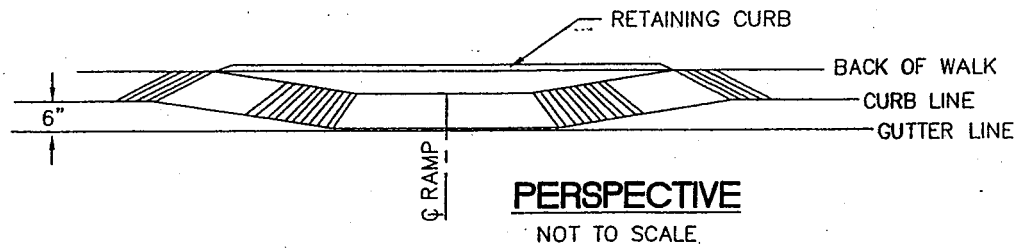

SECTION C-C

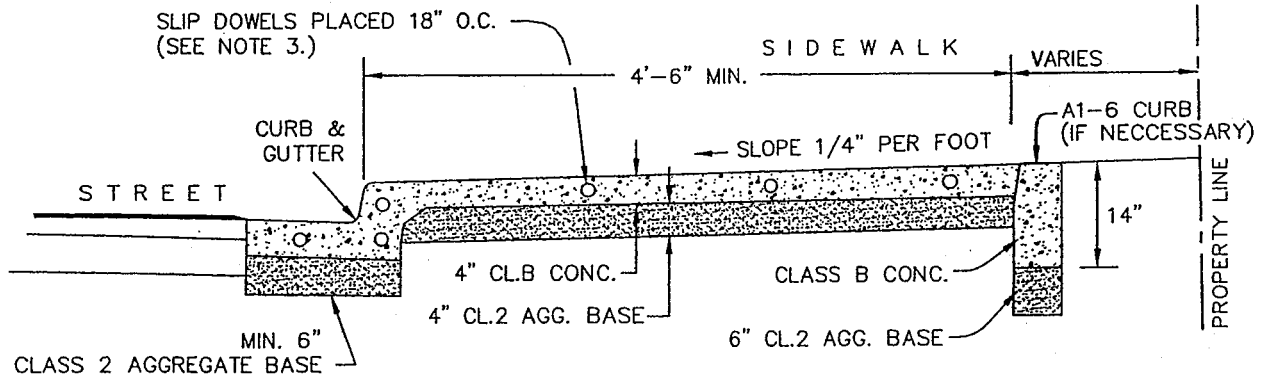

SECTION D-D

SIDEWALK ACCESS RAMP FOR SIDEWALKS LESS THAN 6' WIDE

NO SCALE

(SHEET 2 OF 3)

D-4B

SAN MATEO COUNTY DEPARTMENT
OF

DRAWN BY: D.P.
CHECK BY: J.A.L.
APPROVED BY: N.R.C.

PUBLIC WORKS

.....

REDWOOD CITY
CALIFORNIA

SCALE: NONE
DATE: 7/97
REVISED: _____

GENERAL NOTES

1. CURB RAMPS THAT HAVE A RAMP SLOPE FLATTER THAN 6.67% SHALL HAVE A DETECTABLE WARNING SURFACE THAT EXTENDS THE FULL WIDTH OF THE RAMP AND 24" MINIMUM LENGTH. DETECTABLE WARNING SURFACES, AT THE OPTION OF THE CONTRACTOR, SHALL BE CONSTRUCTED BY CAST-IN-PLACE OR STAMPED METHOD, OR CONSIST OF A PREFABRICATED SURFACE. THE PRE-FABRICATED SURFACE SHALL REQUIRE APPROVAL BY THE ENGINEER.
2. TRANSITIONS FROM RAMPS TO WALKS SHALL BE FLUSH AND FREE OF ABRUPT CHANGES. THE BOTTOM OF THE RAMP SHALL HAVE A 1/2" LIP AT 45°.
3. INSTALL SLIP DOWELS 18" O.C. AT EXPANSION JOINTS.
4. MINIMUM WIDTH OF RAMP, NOT INCLUDING RETAINING CURB, SHALL BE 4 FEET.
5. THE SURFACE OF RAMP SHALL HAVE A TRANSVERSE BROOMED SURFACE TEXTURE ROUGHER THAN THE SURROUNDING SIDEWALK EXCEPT WHEN LOCATED IN CENTER OF CURB RETURN.
6. BACKFILL MATERIAL TO BE PLACED FLUSH WITH TOP OF CURB.
7. CONSTRUCT MONOLITHIC CURB, GUTTER, AND SIDEWALK.
8. SUB-BASE MATERIAL WITHIN 2.5' OF SUBGRADE SHALL BE COMPACTED TO 95%.
9. RECONSTRUCT SIDEWALK TO NEAREST SCORE LINE AND INSTALL EXPANSION JOINT.
10. UTILITY PULL BOXES, MANHOLES, VAULTS AND ALL OTHER UTILITY FACILITIES WITHIN THE BOUNDARIES OF THE CURB RAMP WILL BE RELOCATED BY OTHERS PRIOR TO, OR IN CONJUNCTION WITH, CURB RAMP CONSTRUCTION

SIDEWALK ACCESS RAMP
FOR SIDEWALKS LESS THAN 6' WIDE

NO SCALE

(SHEET 3 OF 3)

D-4C

SAN MATEO COUNTY DEPARTMENT

OF

PUBLIC WORKS

DRAWN BY: D.P.
CHECK BY: J.A.L.
APPROVED BY: N.R.C.

SCALE: NONE
DATE: 6/95
REVISED: 4/97

REDWOOD CITY
CALIFORNIA

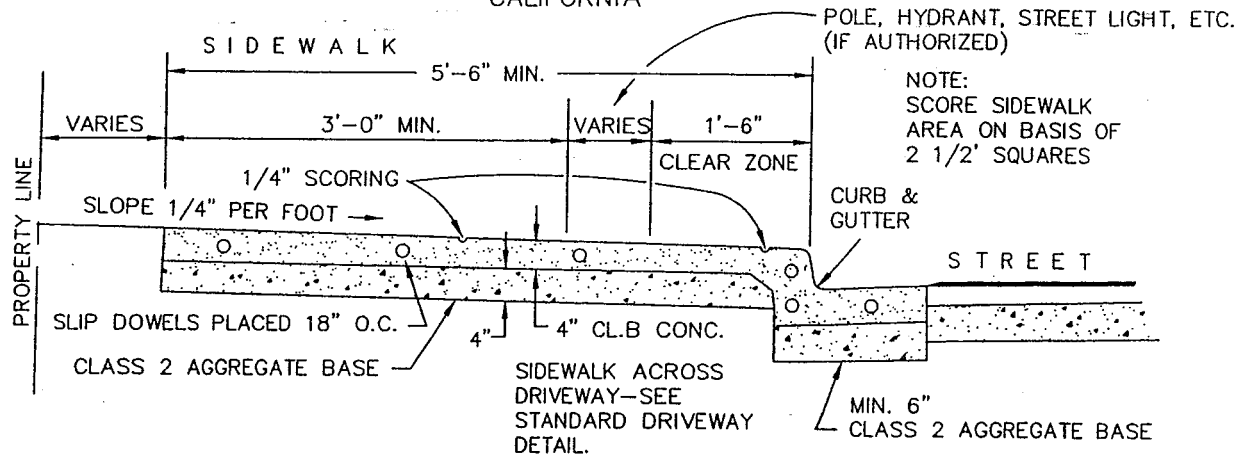

TYPICAL SECTION URBAN CURB, GUTTER AND SIDEWALK

NOTE: OBSTRUCTIONS SUCH AS POLES, HYDRANTS, STREET SIGNS, UTILITY BOXES, STREET LIGHTS, ETC. SHALL BE LOCATED BEHIND THE SIDEWALK, UNLESS OTHERWISE SPECIFICALLY AUTHORIZED BY THE DIRECTOR OF PUBLIC WORKS. A CLEAR ZONE ALONG THE CURB AND SIDEWALK 18 INCHES IN WIDTH (MEASURED FROM THE FACE OF THE CURB) SHALL BE KEPT CLEAR AND OPEN FROM ALL OBSTRUCTIONS. IN ADDITION, AN AREA 3 FEET IN WIDTH ALONG THE SIDEWALK, EXCLUSIVE OF THE CURB WIDTH, SHALL BE KEPT CLEAR AND OPEN FROM ALL OBSTRUCTIONS IN COMPLIANCE WITH THE STATE BUILDING CODE (PART 2, TITLE 24, C.A.C.).

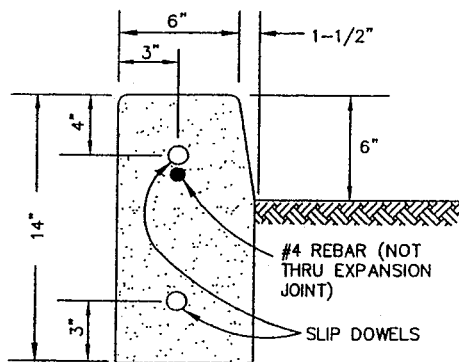

A1-6 CURB

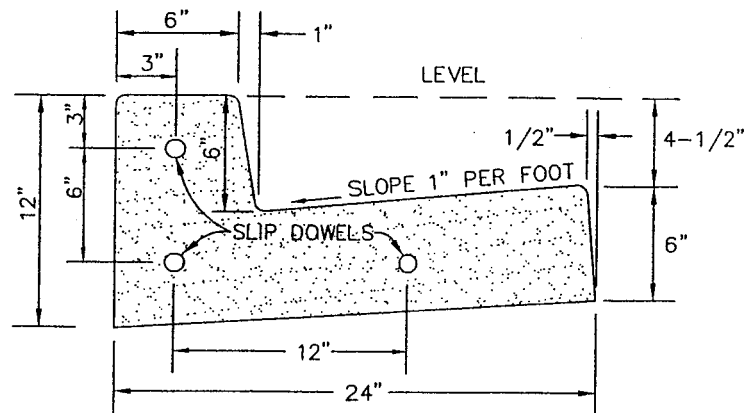

CURB AND GUTTER

TYPICAL SECTIONS

NOTES:

1. ALL CONCRETE TO BE CLASS B CONCRETE.
2. MINIMUM SIDEWALK THICKNESS = 4 INCHES PCC.
3. PLACE 1/2" DIAMETER X 18" LONG DOWELS AT EXPANSION JOINTS AS SHOWN.
4. PLACE 1/2" THICK EXPANSION JOINTS FULL WIDTH 20' ON CENTER.
5. CONSTRUCT MONOLITHIC CURB, GUTTER AND SIDEWALK UNLESS OTHERWISE SPECIFICALLY AUTHORIZED BY THE DIRECTOR OF PUBLIC WORKS.
6. SUB-BASE MATERIALS WITHIN 30" OF SUBGRADE SHALL BE COMPACTED TO 95%.