

# COUNTY OF SAN MATEO CALIFORNIA

## COUNTYWIDE PAVEMENT MAINTENANCE PROJECT [COUNTY PROJECT NO. RW707, STPL-5935 (081)]

### TOTAL PROJECT APPROXIMATELY 5.83 MILES IN LENGTH WITH APPURTENANT WORK THERETO IN SAN MATEO COUNTY

TO BE SUPPLEMENTED BY STATE OF CALIFORNIA DEPARTMENT OF TRANSPORTATION STANDARD PLANS DATED MAY 2018 AND ADOPTED BY SAN MATEO COUNTY, FEBRUARY 11, 2020, BY RESOLUTION NO. 077277

#### GENERAL NOTES:

- CONTRACTOR SHALL CONFINE HIS OPERATIONS AND ACTIVITIES WITHIN THE PROJECT LIMITS, CONSISTING OF ROAD RIGHT-OF-WAY, RIGHTS OF ENTRY AND/OR PROJECT CONFORMS, AS SHOWN ON THE PLANS AND AS DIRECTED BY THE ENGINEER.
- THE CONTRACTOR SHALL PROVIDE APPROVED FIRST NOTIFICATION TO ALL AFFECTED OWNERS/RESIDENTS, TRANSIT AGENCIES, AND SCHOOLS, A MINIMUM OF TEN (10) CALENDAR DAYS PRIOR TO COMMENCEMENT OF PROJECT SITE WORK. IN ADDITION, THE CONTRACTOR SHALL PROVIDE APPROVED SECOND NOTIFICATION TO ALL AFFECTED OWNERS/RESIDENTS A MINIMUM OF FORTY-EIGHT (48) HOURS PRIOR TO COMMENCEMENT OF ANY PROJECT SPECIFIC SITE WORK TO ALLOW RESIDENTS TO MOVE THEIR VEHICLES AWAY FROM THE WORK AREA. FAILURE TO DISTRIBUTE NOTICES SHALL BE SUFFICIENT CAUSE FOR THE ENGINEER TO SUSPEND THE WORK UNTIL SUCH NOTICES ARE DISTRIBUTED.
- THE CONTRACTOR SHALL PROVIDE A MINIMUM OF ONE (1) UNOBSTRUCTED TRAFFIC LANE, NOT LESS THAN TEN FEET (10') WIDE, IN EACH DIRECTION BETWEEN THE HOURS OF 5:00 P.M. AND 8:00 A.M. BETWEEN THE HOURS OF 8:00 A.M. AND 5:00 P.M., THE CONTRACTOR SHALL PROVIDE A MINIMUM OF ONE UNOBSTRUCTED, REVERSIBLE TRAFFIC LANE, NOT LESS THAN TEN (10') FEET WIDE, THAT IS FLAGGER CONTROLLED. THE CONTRACTOR IS ADVISED THAT FOR STREETS LESS THAN TWENTY FEET (20') FEET WIDE, THE CONTRACTOR MAY REQUEST ROAD CLOSURE. ALL ROAD CLOSURES SHALL BE APPROVED IN ADVANCE BY THE ENGINEER IN WRITING WITHOUT EXCEPTION. ANY WORK WITHIN 0.25 MILES OF A SCHOOL SHALL BE LIMITED TO BETWEEN THE HOURS OF 9:00 A.M. TO 3:00 P.M. WHILE SCHOOL IS IN SESSION.
- EXISTING STREET SURFACE FEATURES (MANHOLES, CLEANOUTS, VALVE COVERS, SURVEY MONUMENTS, SURVEY MARKERS, STRIPING, PAVEMENT MARKINGS, ETC.) SHALL BE TIED-OUT BY THE CONTRACTOR PRIOR TO START OF ANY WORK.
- TRAFFIC STRIPING AND MARKINGS LAYOUT SHALL BE APPROVED BY THE ENGINEER PRIOR TO INSTALLATION OF FINAL STRIPING AND PAVEMENT MARKINGS.
- THE LOCATIONS FOR TRAFFIC STRIPING, MARKERS, AND LEGENDS SHOWN ON THESE PLANS ARE APPROXIMATE ONLY. IT SHALL BE THE RESPONSIBILITY OF THE CONTRACTOR TO VERIFY EXACT LOCATIONS IN THE FIELD.

- WORK SHOWN ON THESE PLANS SHALL BE ACCOMPLISHED IN ACCORDANCE WITH THE STANDARD DETAILS OF THE COUNTY OF SAN MATEO DATED FEBRUARY 2008, THE STATE STANDARD PLANS DATED 2018, AND THE STATE STANDARD SPECIFICATIONS DATED 2018 UNLESS OTHERWISE SHOWN ON THESE PLANS AND SPECIFICATIONS.
- STREETS SHALL BE CRACK SEALED PRIOR TO SURFACE TREATMENT AND TO THE SATISFACTION OF THE ENGINEER.
- CONTRACTOR SHALL AVOID DAMAGES TO EXISTING UTILITIES ENCOUNTERED. ANY DAMAGE TO EXISTING FACILITIES CAUSED BY THE CONTRACTOR SHALL BE REPAIRED AND AT THE CONTRACTOR'S EXPENSE. CONTRACTOR SHALL NOTIFY THE UTILITY AGENCIES AND UNDERGROUND SERVICE ALERT (USA) AT 1-800-642-2444 AT LEAST TWO (2) WORKING DAYS PRIOR TO EXCAVATING.
- ALL QUANTITIES (CAPE SEAL, SLURRY SEAL, MICROSURFACING PAVEMENT REPAIR, STRIPING, ETC.) SHOWN ON DWGS ARE APPROXIMATE ONLY AND SHALL BE GOVERNED BY THE SIGNED AND APPROVED PROJECT SPECIFICATIONS.

#### ABBREVIATIONS:

AB	AGGREGATE BASE	S/O	SOUTH OF
AC	ASPHALT CONCRETE	STD	STANDARD
C&G	CURB AND GUTTER	SY	SQUARE YARD
CL, C	CENTERLINE	SW	SIDEWALK
CT	CALTRANS	TYP	TYPICAL
E/O	EAST OF	VG	VALLEY GUTTER
(E)	EXISTING	W/O	WEST OF
FT	FEET	N.T.S.	NOT TO SCALE
N/O	NORTH OF	[SB]	STOP BAR
NO.	NUMBER	[Y] X/W	YELLOW CROSSWALK W/ LADDER BAR
O.C.	ON CENTER	[W] X/W	WHITE CROSSWALK W/ LADDER BAR
R.C.	RELATIVE COMPACTION		
SF	SQUARE FEET		
ROW	RIGHT-OF-WAY		

#### APPLICABLE STANDARD PLANS:

A20A, A20B, A20C, A20D, A24A, A24B, A24C, A24D, A24E



APPROVED:

NOVEMBER 24, 2020

JAMES C. PORTER, DIRECTOR OF PUBLIC WORKS  
R. C. E. # 48056 / EXPIRES 12-31-2021

#### LEGEND:

999	PROPERTY ADDRESS	
#	TABLE QUANTITY REF. NUMBER	
	STREETS TO BE CAPE SEALED (COUNTY)	(A/21)
	STREETS TO BE CAPE SEALED (CITY ROW)	(A/21)
	STREETS TO BE SLURRY SEALED (COUNTY)	(B/21)
	STREETS TO BE SLURRY SEALED (CITY ROW)	(B/21)
	STREETS TO BE MICRO SURFACED (COUNTY)	(C/21)
	PAVEMENT REPAIR AREA	
	MISC. CONCRETE WORK	
	BLUE FIRE HYDRANT MARKER	
	RIGHT-OF-WAY LIMITS	
	12" [SB] STOP BAR	
	LADDER TYPE CROSSWALK	(G/22)
#	ADA RAMP REF. NUMBER	
	YIELD LINE TRIANGLES	(I/22)
	TYPE I ARROW	(I/21)
	TYPE VI ARROW	(H/21)
	TYPE III/IV (L/R) ARROW	(F/21) OR (J/21)
	TYPE III (B) ARROW	(G/21)
	PROJECT ORANGE ADVISORY SIGN	
	GREEN THERMOPLASTIC BIKE LANE	(F/22)
	BIKE LANE STRIPED BUFFER	(C/23)
(K)	"KEEP" LEGEND (WHITE)	(B/23)
(S)	"STOP" LEGEND (WHITE)	(B/23)
(A)	"AHEAD" LEGEND (WHITE)	(B/23)
(SC)	"SCHOOL" LEGEND (YELLOW)	(B/23)
(BS)	"BUS STOP" LEGEND (WHITE)	(B/23)
(BL)	BIKE LANE/ARROW SYMBOL (WHITE)	(C/22) & (E/22)
(BLD)	BICYCLE LOOP DETECTOR SYMBOL (WHITE)	(D/22)
(SRB)	SHARED ROAD BICYCLE MARKING (WHITE/GREEN)	(B/22)
(C)	"CLEAR" LEGEND (WHITE)	(B/23)
(X)	"XING" LEGEND (WHITE)	(B/23)
(P)	"PED" LEGEND (WHITE)	(B/23)
(SW)	"SLOW" LEGEND (YELLOW)	(B/23)
(RR)	RAILROAD CROSSING SYMBOL	(A/22)

#### PROJECT LOCATIONS:

- DALY CITY
- BURLINGAME
- SAN MATEO HIGHLANDS
- HARBOR/INDUSTRIAL
- NORTH FAIR OAKS
- SEQUOIA TRACT
- MENLO OAKS

#### SHEET INDEX:

- TITLE SHEET AND GENERAL NOTES
- CAPE SEAL/ADA RAMPS LOCATION MAP - BURLINGAME HILLS AREA
- SLURRY SEAL LOCATION MAP - DALY CITY AREA
- SLURRY SEAL LOCATION MAP - SAN MATEO HIGHLANDS AREA
- SLURRY SEAL LOCATION MAP - HARBOR/INDUSTRIAL AREA
- SLURRY SEAL LOCATION MAP - NORTH FAIR OAKS AREA #1
- SLURRY SEAL LOCATION MAP - NORTH FAIR OAKS AREA #2
- CAPE SEAL/MICROSURFACING/ADA RAMPS LOCATION MAP - MENLO OAKS AND SEQUOIA TRACT AREA
- PAVEMENT REPAIR/STRIPING - BURLINGAME HILLS AREA
- PAVEMENT REPAIR/STRIPING - DALY CITY AREA
- PAVEMENT REPAIR/CONC. WORK/STRIPING - SAN MATEO HIGHLANDS & HARBOR/INDUSTRIAL AREA
- PAVEMENT REPAIR/STRIPING - ELMER ST DETAIL
- PAVEMENT REPAIR/STRIPING - NORTH FAIR OAKS AREA #1
- PAVEMENT REPAIR/STRIPING - 5TH AVE & WAVERLY AVE DETAIL
- PAVEMENT REPAIR/STRIPING - 5TH AVE & SEMICIRCULAR RD DETAIL
- PAVEMENT REPAIR/STRIPING - NORTH FAIR OAKS AREA #2
- PAVEMENT REPAIR/STRIPING - MENLO OAKS AREA
- PAVEMENT REPAIR/STRIPING - SEQUOIA TRACT AREA
- PAVEMENT REPAIR/STRIPING - ALAMEDA DE LAS PULGAS & HULL AVE DETAIL
- PAVEMENT REPAIR/STRIPING - ALAMEDA DE LAS PULGAS & HELENA AVE DETAIL
- TYPICAL DETAILS - AC TREATMENT AND STRIPING
- TYPICAL DETAILS - STRIPING (CONTINUED)
- TYPICAL DETAILS - STRIPING (CONTINUED)
- TYPICAL DETAILS - ADA RAMPS & CONCRETE
- TYPICAL DETAILS - MISC.



DESIGNED BY: SO	COUNTYWIDE PAVEMENT MAINTENANCE PROJECT TITLE SHEET AND GENERAL NOTES	SCALE: NO SCALE
CHECKED BY: WN		DATE: 11/19/2020
DRAWN BY: SO		FILE NO: 1/4992
JAMES C. PORTER, DIRECTOR OF PUBLIC WORKS SAN MATEO COUNTY		555 COUNTY CENTER, 5TH FLOOR REDWOOD CITY, CALIFORNIA 94063-1665
		1 SHEET 1 OF 25

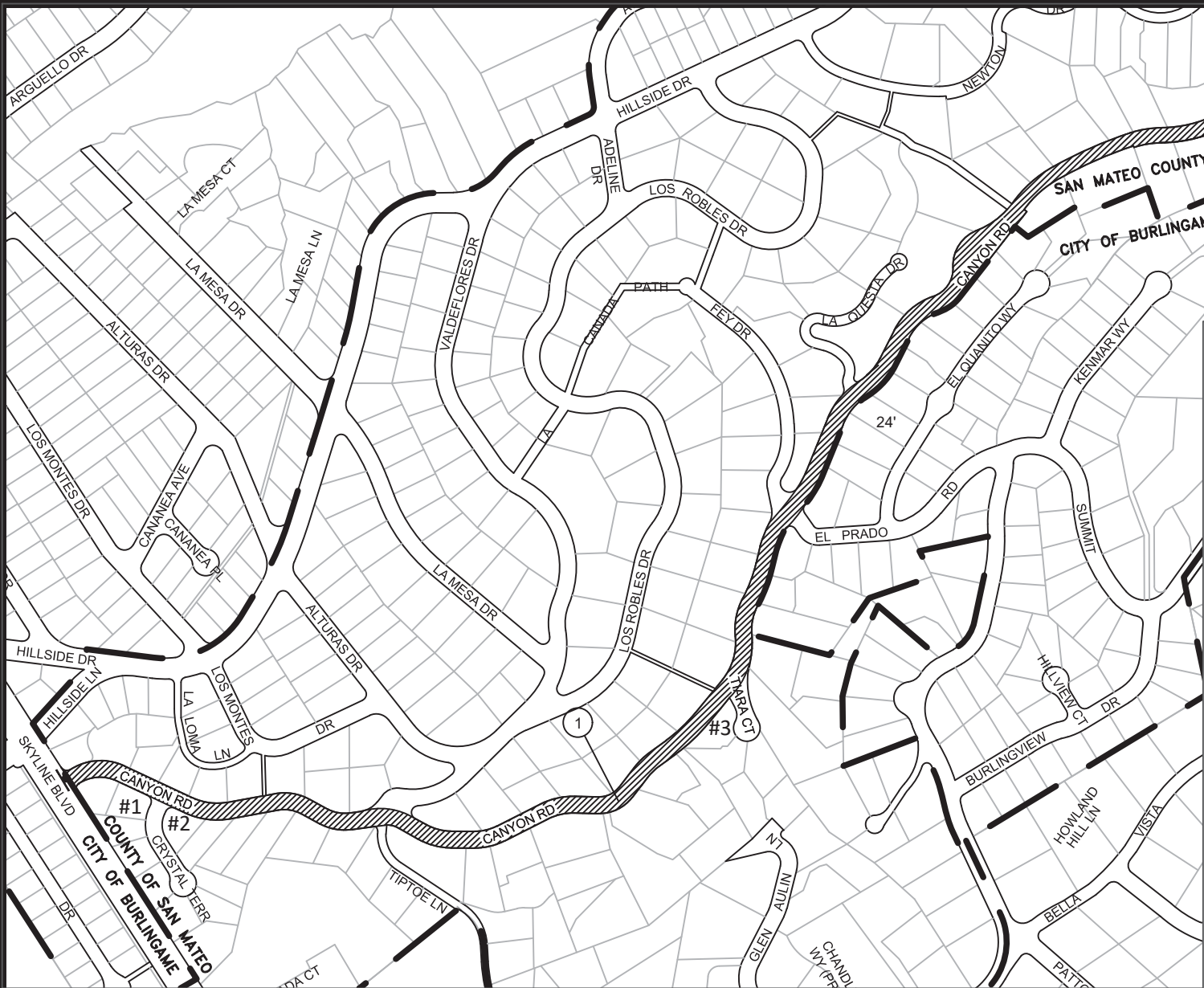

BURLINGAME HILLS AREA

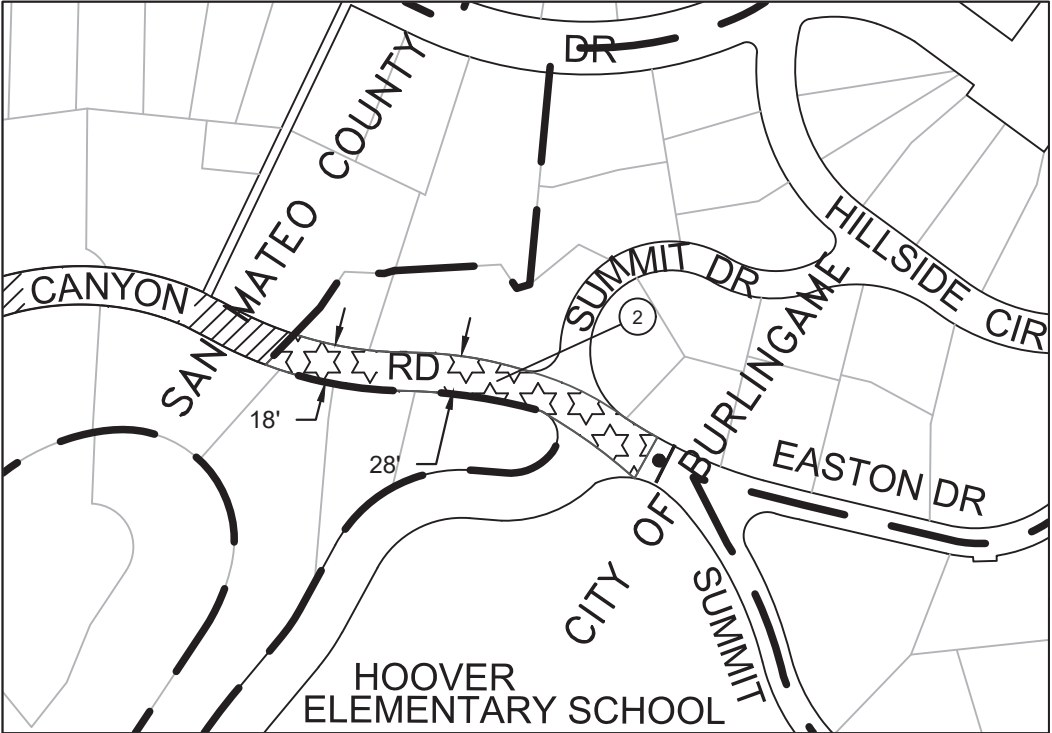
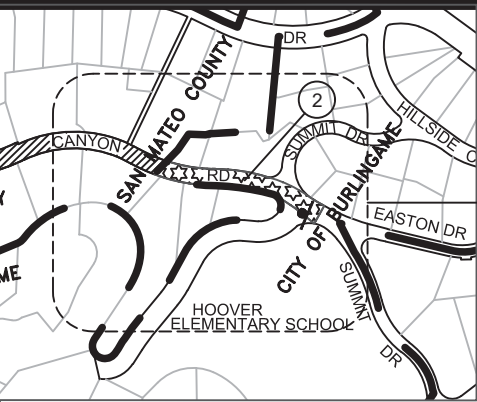

CANYON RD IN CITY OF BURLINGAME  
RIGHT OF WAY DETAIL

N.T.S. A  
2



APPROVED:  
NOVEMBER 24, 2020  
JAMES C. PORTER, DIRECTOR OF PUBLIC WORKS  
R. C. E. # 48056 / EXPIRES 12-31-2021

LEGEND:

- 999 PROPERTY ADDRESS
- # TABLE QUANTITY REF. NUMBER
- STREETS TO BE CAPE SEALED (COUNTY) A  
21
- STREETS TO BE CAPE SEALED (CITY ROW) A  
21
- PROJECT ORANGE ADVISORY SIGN
- RIGHT-OF-WAY LIMITS
- # ADA RAMP REFERENCE NUMBER

NOTES:

- REFER TO SHEET 1 FOR GENERAL NOTES.
- PROJECT ADVISORY SIGN LOCATIONS AND TOTALS ARE APPROXIMATE ONLY AND SHALL BE GOVERNED BY THE COUNTY APPROVED TRAFFIC CONTROL PLAN.

BURLINGAME CAPE SEAL				
	ROAD NAME	BEGIN LOCATION	END LOCATION	AREA (SY)
1	CANYON RD	SKYLINE BLVD	COUNTY BOUNDRY NORTH OF SUMMIT DR	16,072
2	CANYON RD (BUR ROW)	COUNTY BOUNDRY NORTH OF SUMMIT DR	EASTON DR	900
TOTAL THIS SHEET (SY):				16,972

BURLINGAME- ADA RAMP TABLE					
STREET	NO.	TYPE	DETAIL/SHEET NO.	X-STREET	CONCRETE (CY)
CANYON RD	1	C	A-24	CRYSTAL TERRACE	2.55
	2	C	A-24	CRYSTAL TERRACE	2.48
	3	C	A-24	TIARA CT	2.33
TOTAL (CY)					7.36



DESIGNED BY: SO	COUNTYWIDE PAVEMENT MAINTENANCE PROJECT CAPE SEAL/ADA RAMPS LOCATION MAP BURLINGAME HILLS AREA		SCALE: NO SCALE
CHECKED BY: WN			DATE: 11/19/2020
DRAWN BY: SO			FILE NO: 1/4992
JAMES C. PORTER, DIRECTOR OF PUBLIC WORKS SAN MATEO COUNTY		555 COUNTY CENTER, 5TH FLOOR REDWOOD CITY, CALIFORNIA 94063-1665	2 SHEET 2 OF 25





APPROVED: NOVEMBER 24, 2020

*[Signature]*

JAMES C. PORTER, DIRECTOR OF PUBLIC WORKS  
R. C. E. # 48056 / EXPIRES 12-31-2021

**LEGEND:**

- 999 PROPERTY ADDRESS
- # TABLE QUANTITY REF. NUMBER
- STREETS TO BE SLURRY SEALED (COUNTY) B  
21
- PROJECT ORANGE ADVISORY SIGN
- RIGHT-OF-WAY LIMITS

**NOTES:**

1. REFER TO SHEET 1 FOR GENERAL NOTES.
2. PROJECT ADVISORY SIGN LOCATIONS AND TOTALS ARE APPROXIMATE ONLY AND SHALL BE GOVERNED BY THE COUNTY APPROVED TRAFFIC CONTROL PLAN.

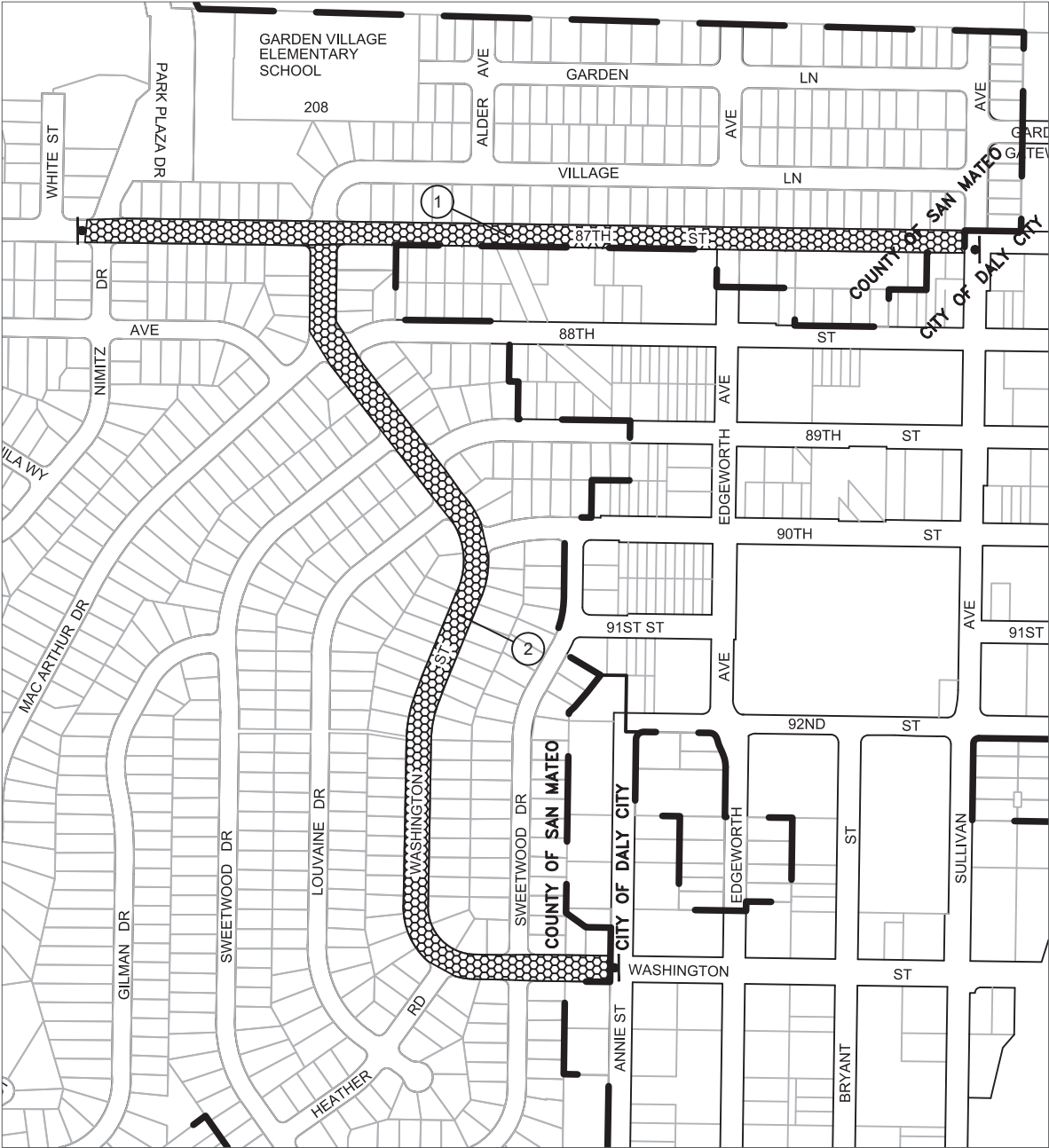

**DALY CITY AREA**

DALY CITY - SLURRY SEAL				
	ROAD NAME	BEGIN LOCATION	END LOCATION	AREA (SY)
1	EIGHTY-SEVENTH (87TH) STREET	PARK PLAZA DRIVE	SULLIVAN ST	10,462
2	WASHINGTON STREET	EIGHTY-SEVENTH STREET	ANNIE STREET	10,209
TOTAL THIS SHEET (SY):				20,671



DESIGNED BY: SO	COUNTYWIDE PAVEMENT MAINTENANCE PROJECT <b>SLURRY SEAL LOCATION MAP</b> <b>DALY CITY AREA</b>		SCALE: NO SCALE
CHECKED BY: WN			DATE: 11/19/2020
DRAWN BY: SO			FILE NO: <b>1/4992</b>
JAMES C. PORTER, DIRECTOR OF PUBLIC WORKS SAN MATEO COUNTY		555 COUNTY CENTER, 5TH FLOOR REDWOOD CITY, CALIFORNIA 94063-1665	<b>3</b> SHEET 3 OF 25

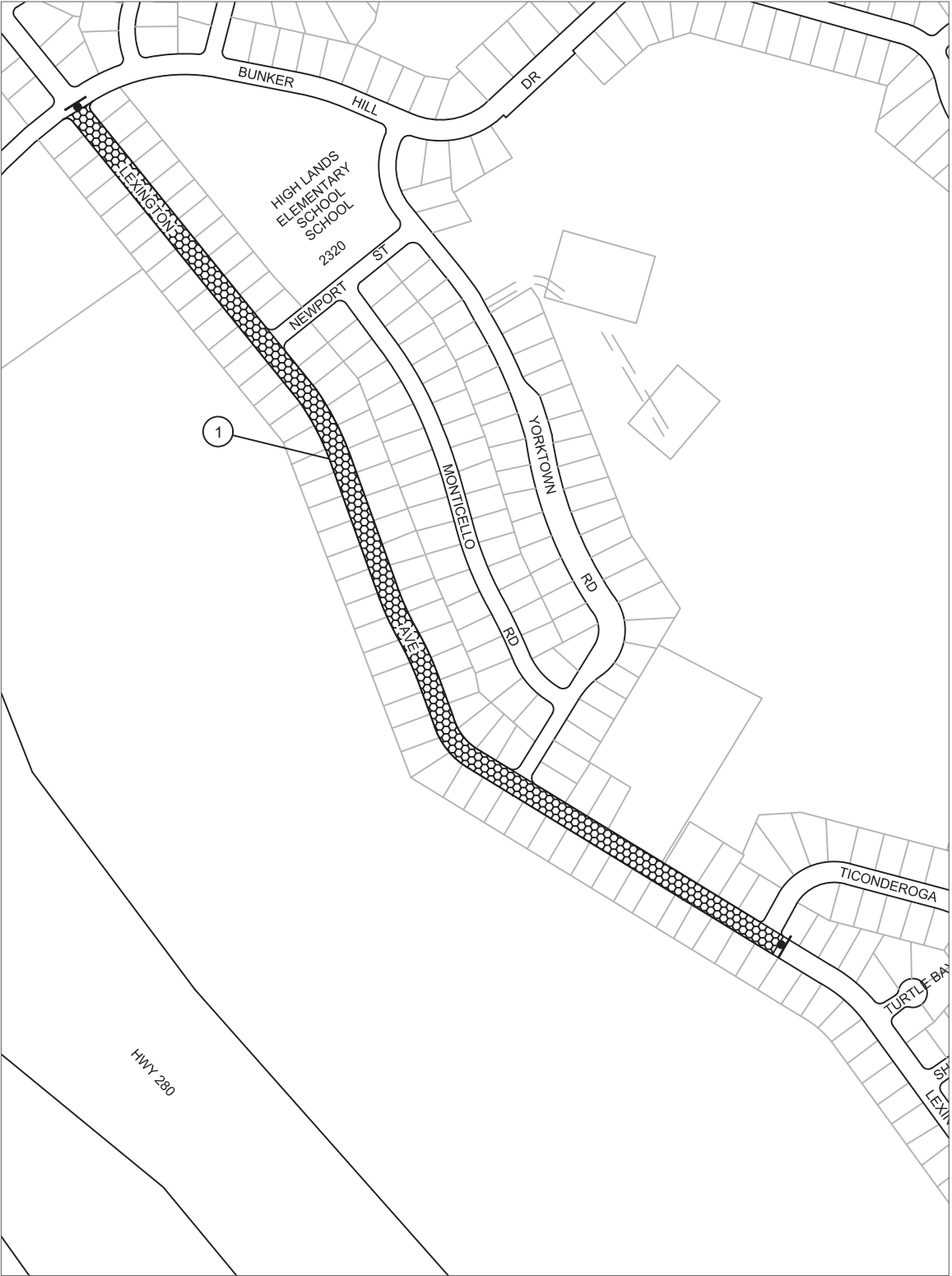

SAN MATEO HIGHLANDS AREA

SAN MATEO HIGHLANDS AREA- SLURRY SEAL				
	ROAD NAME	BEGIN LOCATION	END LOCATION	AREA (SY)
1	LEXINGTON AVE	BUNKER HILL DRIVE	TICONDEROGA DRIVE	13,627
			TOTAL THIS SHEET (SY):	13,627



DESIGNED BY: SO	COUNTYWIDE PAVEMENT MAINTENANCE PROJECT  <b>SLURRY SEAL LOCATION MAP</b> <b>SAN MATEO HIGHLANDS AREA</b>	SCALE: NO SCALE
CHECKED BY: WN		DATE: 11/19/2020
DRAWN BY: SO		FILE NO: <b>1/4992</b>
JAMES C. PORTER, DIRECTOR OF PUBLIC WORKS SAN MATEO COUNTY		555 COUNTY CENTER, 5TH FLOOR REDWOOD CITY, CALIFORNIA 94063-1665
		<b>4</b> SHEET 4 OF 25



APPROVED:

NOVEMBER 24, 2020

JAMES C. PORTER, DIRECTOR OF PUBLIC WORKS  
R. C. E. # 48056 / EXPIRES 12-31-2021

- LEGEND:**
- 999 PROPERTY ADDRESS
  - # TABLE QUANTITY REF. NUMBER
  - [Pattern] STREETS TO BE SLURRY SEALED (COUNTY) B 21
  - [Symbol] PROJECT ORANGE ADVISORY SIGN
  - RIGHT-OF-WAY LIMITS

- NOTES:**
- 1. REFER TO SHEET 1 FOR GENERAL NOTES.
  - 2. PROJECT ADVISORY SIGN LOCATIONS AND TOTALS ARE APPROXIMATE ONLY AND SHALL BE GOVERNED BY THE COUNTY APPROVED TRAFFIC CONTROL PLAN.

F:\Users\design\C3D\E4992000\_Countywide Pavement Maintenance\11 DWG

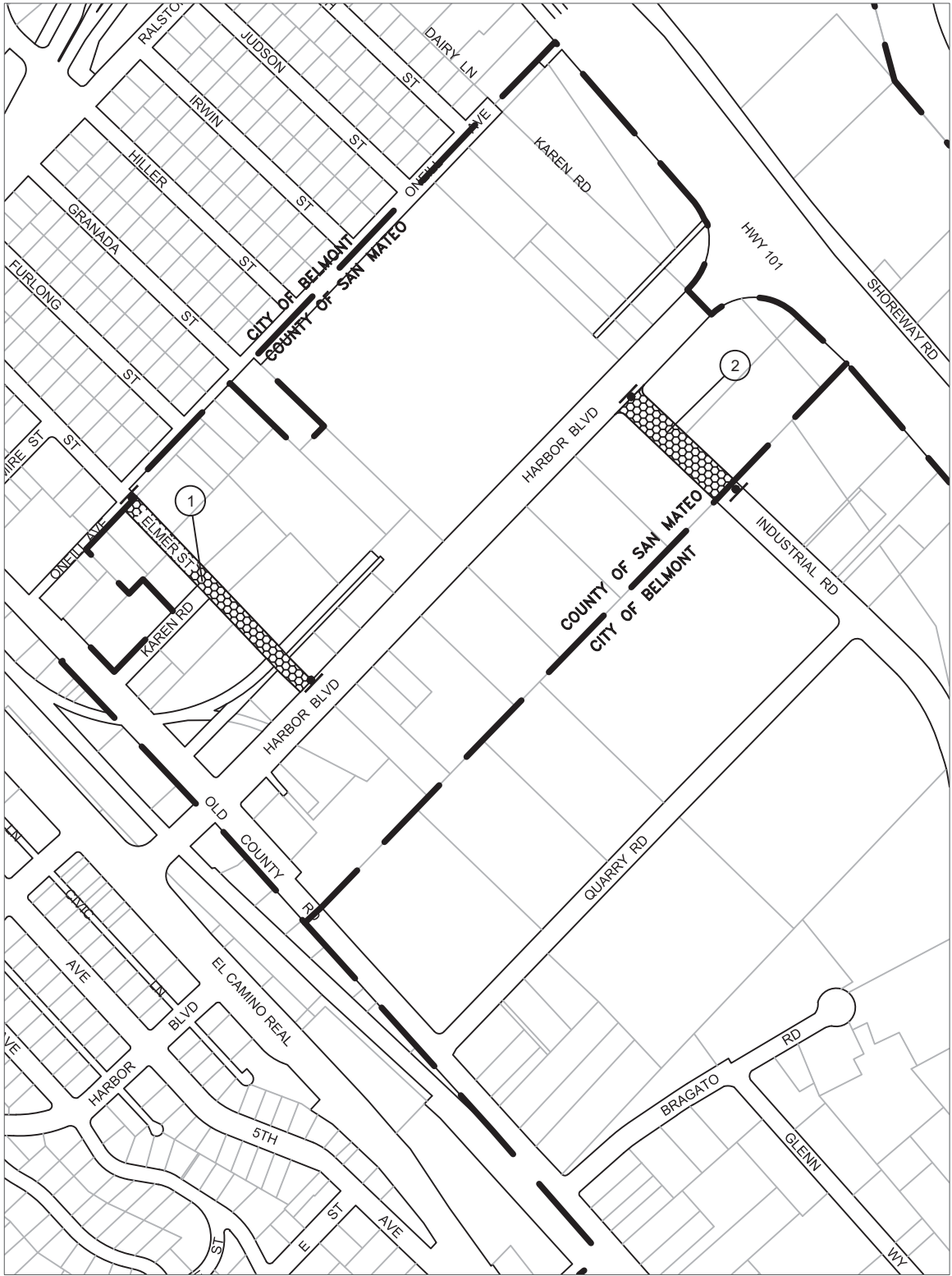

HARBOR/INDUSTRIAL AREA

HARBOR/INDUSTRIAL AREA- SLURRY SEAL				
	ROAD NAME	BEGIN LOCATION	END LOCATION	AREA (SY)
1	ELMER STREET	COUNTY BOUNDARY AT O'NEILL AVE	HARBOR BLVD	3,154
2	INDUSTRIAL ROAD	HARBOR BLVD	CNTY BNDRY S/ HARBOR	2,597
TOTAL THIS SHEET (SY):			5,751	



DESIGNED BY: SO	COUNTYWIDE PAVEMENT MAINTENANCE PROJECT  <b>SLURRY SEAL LOCATION MAP</b> <b>HARBOR/INDUSTRIAL AREA</b>	SCALE: NO SCALE
CHECKED BY: WN		DATE: 11/19/2020
DRAWN BY: SO		FILE NO: <b>1/4992</b>
JAMES C. PORTER, DIRECTOR OF PUBLIC WORKS SAN MATEO COUNTY		555 COUNTY CENTER, 5TH FLOOR REDWOOD CITY, CALIFORNIA 94063-1665
		<b>5</b> SHEET 5 OF 25



APPROVED:

NOVEMBER 24, 2020

JAMES C. PORTER, DIRECTOR OF PUBLIC WORKS  
R. C. E. # 48056 / EXPIRES 12-31-2021

- LEGEND:**
- 999 PROPERTY ADDRESS
  - # TABLE QUANTITY REF. NUMBER
  - STREETS TO BE SLURRY SEALED (COUNTY) B  
21
  - PROJECT ORANGE ADVISORY SIGN
  - RIGHT-OF-WAY LIMITS

- NOTES:**
1. REFER TO SHEET 1 FOR GENERAL NOTES.
  2. PROJECT ADVISORY SIGN LOCATIONS AND TOTALS ARE APPROXIMATE ONLY AND SHALL BE GOVERNED BY THE COUNTY APPROVED TRAFFIC CONTROL PLAN.





A  
6

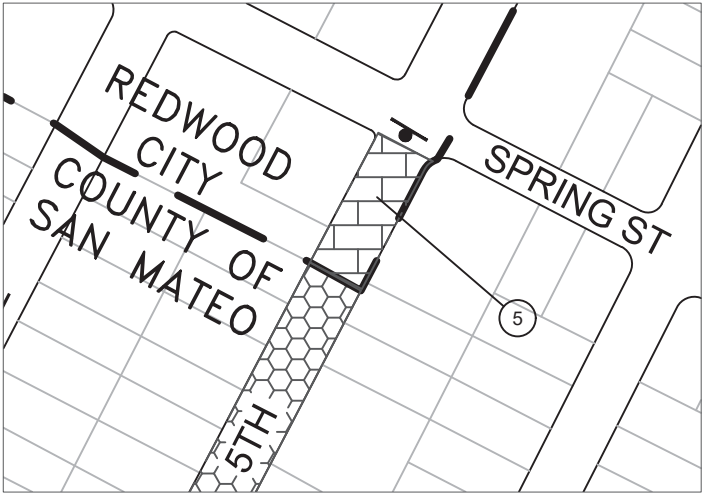

5TH AVE & SPRING ST  
PAVEMENT LEGEND DETAIL N.T.S. A  
6



APPROVED:  
NOVEMBER 24, 2020  
JAMES C. PORTER, DIRECTOR OF PUBLIC WORKS  
R. C. E. # 48056 / EXPIRES 12-31-2021

LEGEND:

- 999 PROPERTY ADDRESS
- # TABLE QUANTITY REF. NUMBER
- [Pattern] STREETS TO BE SLURRY SEALED (COUNTY) B  
21
- [Pattern] STREETS TO BE SLURRY SEALED (CITY ROW) B  
21
- [Symbol] PROJECT ORANGE ADVISORY SIGN
- [Symbol] RIGHT-OF-WAY LIMITS

NOTES:

1. REFER TO SHEET 1 FOR GENERAL NOTES.
2. PROJECT ADVISORY SIGN LOCATIONS AND TOTALS ARE APPROXIMATE ONLY AND SHALL BE GOVERNED BY THE COUNTY APPROVED TRAFFIC CONTROL PLAN.

NORTH FAIR OAKS AREA #1

NORTH FAIR OAKS AREA #1 - SLURRY SEAL				
	ROAD NAME	BEGIN LOCATION	END LOCATION	AREA (SY)
1	FIFTH (5TH) AVENUE (EAST SIDE RD)	WAVERLY AVE	301 5TH AVE	3,893
2	FIFTH (5TH) AVENUE (WEST SIDE RD)	WAVERLY AVE	301 5TH AVE	3,850
3	FIFTH (5TH) AVENUE	301 5TH AVE	RAILROAD TRACKS	12,085
4	FIFTH (5TH) AVENUE	RAILROAD TRACKS	CO BOUNDRY S/O SPRING ST	5,312
5	FIFTH (5TH) AVENUE (RWC ROW)	CO BOUNDRY S/O SPRING ST	SPRING ST	907
TOTAL THIS SHEET (SY):				26,047



DESIGNED BY: SO	COUNTYWIDE PAVEMENT MAINTENANCE PROJECT <b>SLURRY SEAL LOCATION MAP</b> <b>NORTH FAIR OAKS AREA #1</b>	SCALE: NO SCALE
CHECKED BY: WN		DATE: 11/19/2020
DRAWN BY: SO		FILE NO: <b>1/4992</b>
JAMES C. PORTER, DIRECTOR OF PUBLIC WORKS SAN MATEO COUNTY		555 COUNTY CENTER, 5TH FLOOR REDWOOD CITY, CALIFORNIA 94063-1665
		<b>6</b> SHEET 6 OF 25



NORTH FAIR OAKS AREA #2

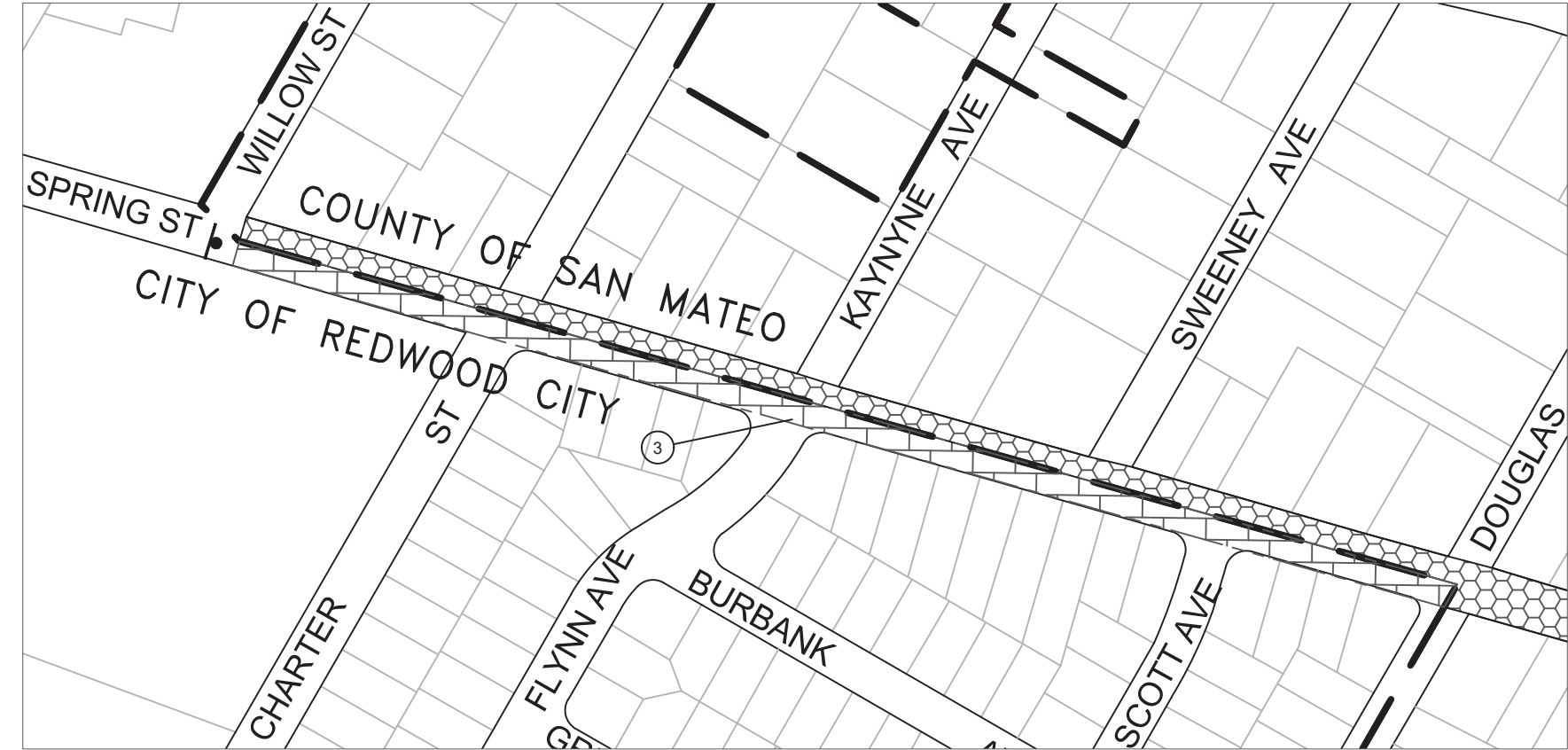

SPRING ST IN REDWOOD CITY  
RIGHT OF WAY DETAIL

N.T.S. **A**  
**7**



DESIGNED BY: SO	COUNTYWIDE PAVEMENT MAINTENANCE PROJECT <b>SLURRY SEAL LOCATION MAP</b> <b>NORTH FAIR OAKS AREA #2</b>	SCALE: NO SCALE
CHECKED BY: WN		DATE: 11/19/2020
DRAWN BY: SO		FILE NO: <b>1/4992</b>
JAMES C. PORTER, DIRECTOR OF PUBLIC WORKS SAN MATEO COUNTY		555 COUNTY CENTER, 5TH FLOOR REDWOOD CITY, CALIFORNIA 94063-1665
		<b>7</b> SHEET 7 OF 25



APPROVED:  
  
NOVEMBER 24, 2020  
  
JAMES C. PORTER, DIRECTOR OF PUBLIC WORKS  
R. C. E. # 48056 / EXPIRES 12-31-2021

**LEGEND:**

- 999 PROPERTY ADDRESS
- # TABLE QUANTITY REF. NUMBER
- STREETS TO BE SLURRY SEALED (COUNTY) **B**  
**21**
- STREETS TO BE SLURRY SEALED (CITY ROW) **B**  
**21**
- PROJECT ORANGE ADVISORY SIGN
- RIGHT-OF-WAY LIMITS

**NOTES:**

1. REFER TO SHEET 1 FOR GENERAL NOTES.
2. PROJECT ADVISORY SIGN LOCATIONS AND TOTALS ARE APPROXIMATE ONLY AND SHALL BE GOVERNED BY THE COUNTY APPROVED TRAFFIC CONTROL PLAN.

NORTH FAIR OAKS AREA #2 - SLURRY SEAL				
	ROAD NAME	BEGIN LOCATION	END LOCATION	AREA (SY)
1	SPRING ST	2ND AVE	DOUGLAS AVE	8,799
2	SPRING ST (COUNTY)	DOUGLAS AVE	WILLOW ST	3,268
3	SPRING ST (RWC ROW)	DOUGLAS AVE	WILLOW ST	3,268
TOTAL THIS SHEET (SY):				15,335

F:\Users\design\CSD\E4992000\_Countwide Pavement Maintenance\11 DWG



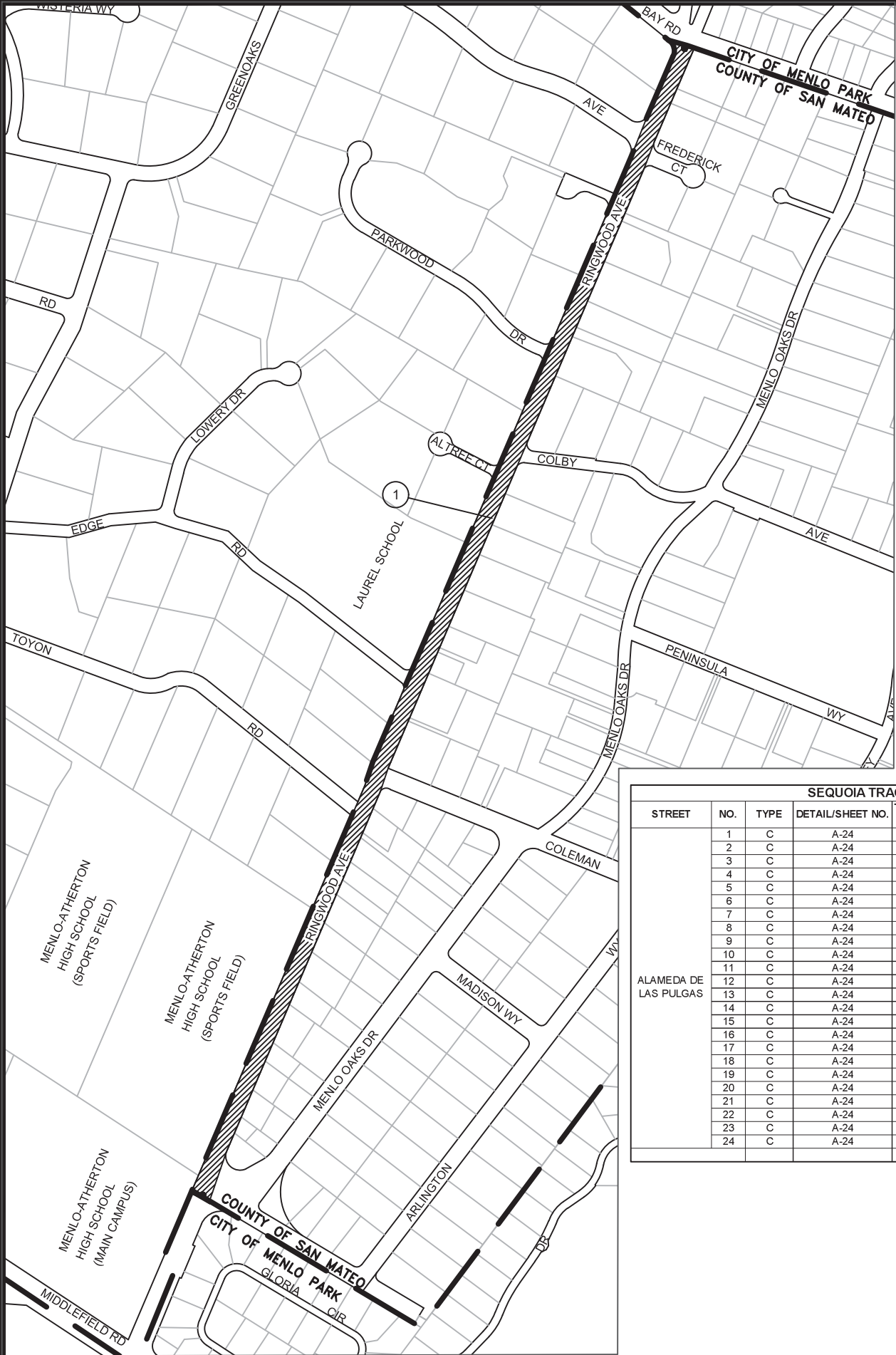

MENLO OAKS AREA

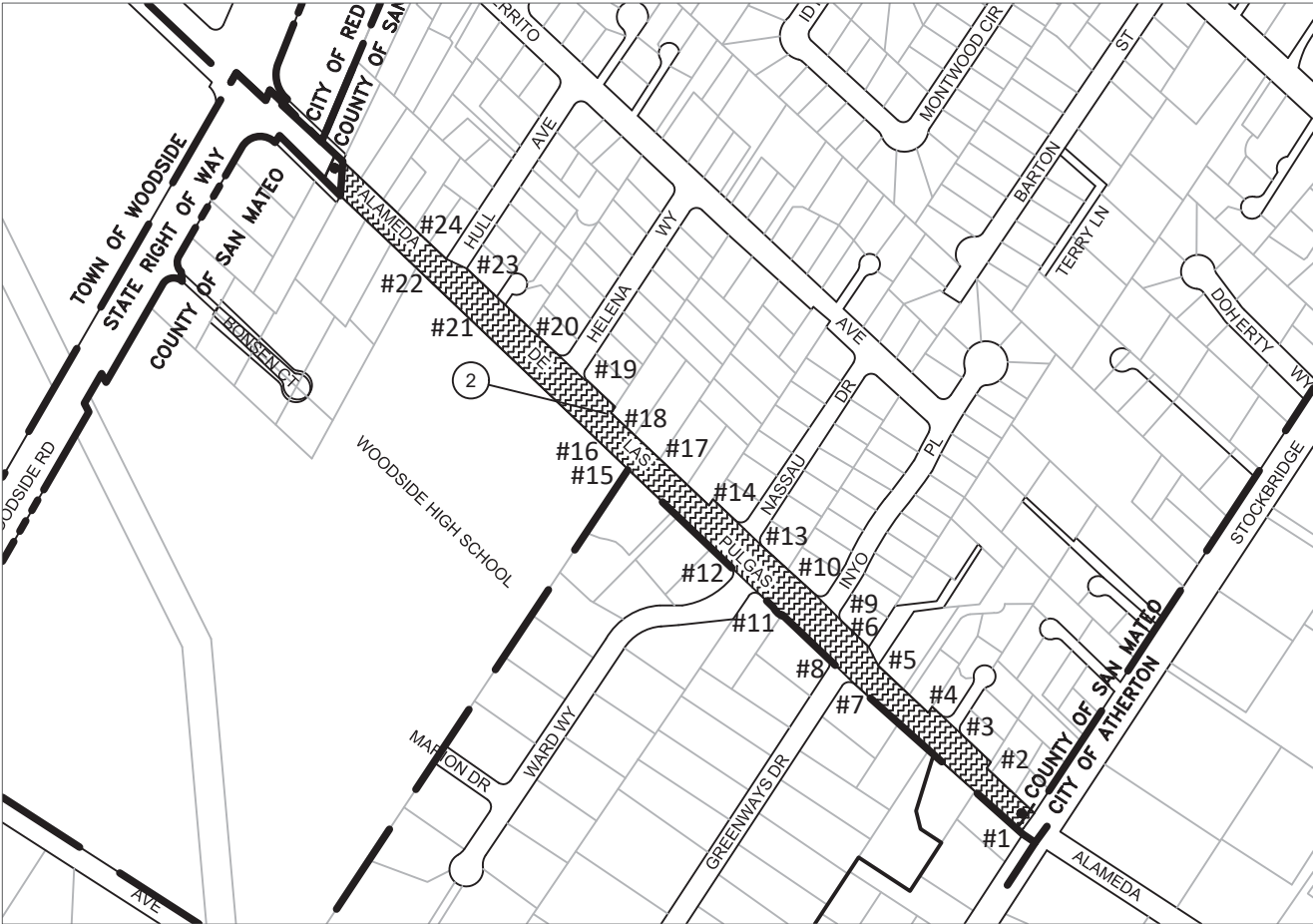

SEQUOIA TRACT AREA

SEQUOIA TRACT- ADA RAMP TABLE						
STREET	NO.	TYPE	DETAIL/SHEET NO.	TRUNCATED DOME COLOR	X-STREET	CONCRETE (CY)
ALAMEDA DE LAS PULGAS	1	C	A-24	GRAY	STOCKBRIDGE AVE	2.19
	2	C	A-24	GRAY	STOCKBRIDGE AVE	2.19
	3	C	A-24	GRAY	MONTEGO LN	2.19
	4	C	A-24	GRAY	MONTEGO LN	2.19
	5	C	A-24	GRAY	ABRYAN WAY	2.19
	6	C	A-24	GRAY	ABRYAN WAY	2.19
	7	C	A-24	GRAY	GREENWAYS DR	2.41
	8	C	A-24	GRAY	GREENWAYS DR	2.19
	9	C	A-24	YELLOW	INYO PL	2.19
	10	C	A-24	YELLOW	INYO PL	2.19
	11	C	A-24	YELLOW	WARD WAY	2.19
	12	C	A-24	YELLOW	WARD WAY	2.19
	13	C	A-24	YELLOW	NASSAU DR	2.19
	14	C	A-24	YELLOW	NASSAU DR	2.19
	15	C	A-24	YELLOW	(NEAR WOODSIDE HIGH)	2.19
	16	C	A-24	YELLOW	(NEAR WOODSIDE HIGH)	2.19
	17	C	A-24	YELLOW	(NEAR PRIVATE LANE)	1.40
	18	C	A-24	YELLOW	(NEAR PRIVATE LANE)	1.40
	19	C	A-24	YELLOW	HELENA WAY	2.19
	20	C	A-24	YELLOW	HELENA WAY	2.19
	21	C	A-24	YELLOW	HULL AVE	2.10
	22	C	A-24	YELLOW	HULL AVE	2.10
	23	C	A-24	YELLOW	HULL AVE	2.19
	24	C	A-24	YELLOW	HULL AVE	2.19
	TOTAL					51.01

MENLO OAKS AREA - CAPE SEAL				
	ROAD NAME	BEGIN LOCATION	END LOCATION	AREA (SY)
1	RINGWOOD AVE	BAY RD	CNTY BNDRY NE/O MIDDLEFIELD	16,708
			TOTAL THIS SHEET (SY):	16,708

SEQUOIA TRACT AREA - MICRO SURFACING				
	ROAD NAME	BEGIN LOCATION	END LOCATION	AREA (SY)
2	ALAMEDA DE LAS PULGAS	WOODSIDE RD	STOCKBRIDGE AV	13,416
			TOTAL THIS SHEET (SY):	13,416



APPROVED: \_\_\_\_\_  
NOVEMBER 24, 2020  
JAMES C. PORTER, DIRECTOR OF PUBLIC WORKS  
R. C. E. # 48056 / EXPIRES 12-31-2021

- LEGEND:**
- 999 PROPERTY ADDRESS
  - # TABLE QUANTITY REF. NUMBER
  - [Hatched Box] STREETS TO BE CAPE SEALED (COUNTY) A  
21
  - [Cross-hatched Box] STREETS TO BE MICRO SURFACED (COUNTY) C  
21
  - [Orange Circle] PROJECT ORANGE ADVISORY SIGN
  - RIGHT-OF-WAY LIMITS
  - # ADA RAMP REFERENCE NUMBER

- NOTES:**
1. REFER TO SHEET 1 FOR GENERAL NOTES.
  2. PROJECT ADVISORY SIGN LOCATIONS AND TOTALS ARE APPROXIMATE ONLY AND SHALL BE GOVERNED BY THE COUNTY APPROVED TRAFFIC CONTROL PLAN.



DESIGNED BY: SO	COUNTYWIDE PAVEMENT MAINTENANCE PROJECT  <b>CAPE SEAL/MICROSURFACING/ADA RAMPs LOCATION MAP</b> <b>MENLO OAKS AND SEQUOIA TRACT AREA</b>	SCALE: NO SCALE
CHECKED BY: WN		DATE: 11/19/2020
DRAWN BY: SO		FILE NO: <b>1/4992</b>
JAMES C. PORTER, DIRECTOR OF PUBLIC WORKS SAN MATEO COUNTY		555 COUNTY CENTER, 5TH FLOOR REDWOOD CITY, CALIFORNIA 94063-1665
		<b>8</b> SHEET 8 OF 25





APPROVED: \_\_\_\_\_  
NOVEMBER 24, 2020  
  
JAMES C. PORTER, DIRECTOR OF PUBLIC WORKS  
R. C. E. # 48056 / EXPIRES 12-31-2021

**LEGEND:**

- 999 PROPERTY ADDRESS
- # PAVEMENT REPAIR AREA
- Ⓢ "STOP" LEGEND (WHITE) B  
23
- ☒ BLUE FIRE HYDRANT MARKER
- RIGHT-OF-WAY LIMITS
- 12" [SB] STOP BAR
- PROJECT ORANGE ADVISORY SIGN

**NOTES:**

- REFER TO SHEET 1 FOR GENERAL NOTES.
- PROJECT ADVISORY SIGN LOCATIONS AND TOTALS ARE APPROXIMATE ONLY AND SHALL BE GOVERNED BY THE COUNTY APPROVED TRAFFIC CONTROL PLAN.



**BURLINGAME HILLS AREA**

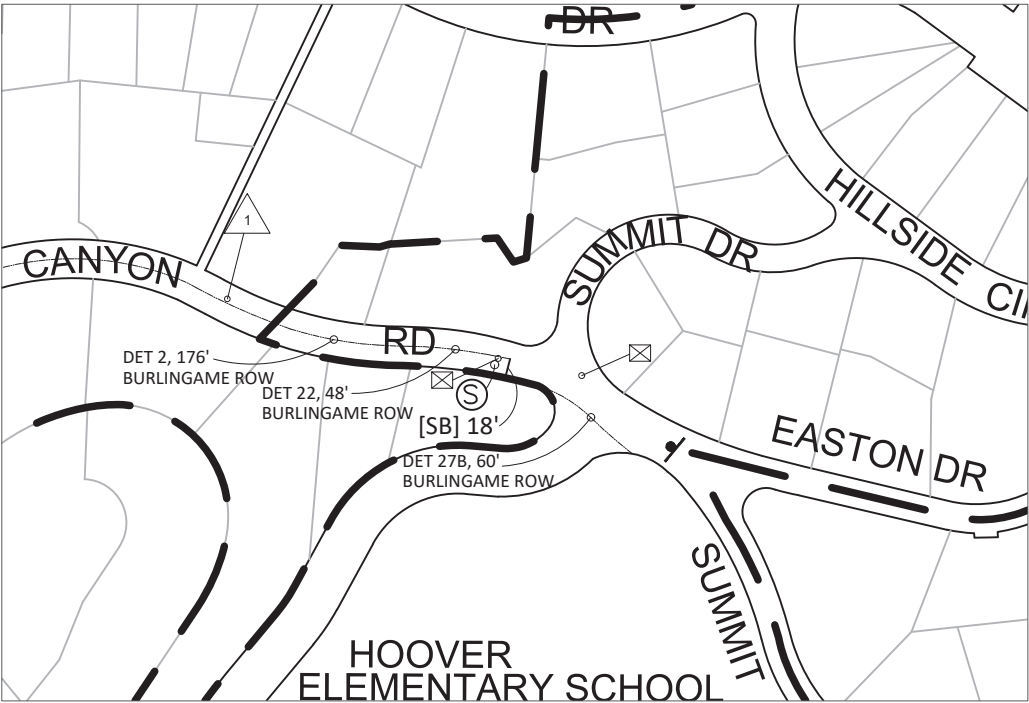

**CANYON RD IN CITY OF BURLINGAME  
RIGHT OF WAY DETAIL**

BURLINGAME AREA PAVEMENT REPAIR							
STREET	LOCATION	NO.	TREATMENT DEPTH/DETAIL	APPROX. AVG. WIDTH (FT)	APPROX. AVG. LENGTH (FT)	AREA (SF)	AREA (SY)
CANYON RD	2848 Canyon Rd	1	6"/D-21	4	4	16.0	1.8
	3027 Canyon Rd	2	3"/E-21	4	48	192.0	21.3
	3028 Canyon Rd	3	3"/E-21	6	146	876.0	97.3
	3033 Canyon Rd	4	3"/E-21	4	30	120.0	13.3
	3030 Canyon Rd	5	3"/E-21	8	12	96.0	10.7
						SUBTOTAL 3":	143
						SUBTOTAL 6":	2



DESIGNED BY: SO	COUNTYWIDE PAVEMENT MAINTENANCE PROJECT <b>PAVEMENT REPAIR/STRIPING BURLINGAME HILLS AREA</b>	SCALE: NO SCALE
CHECKED BY: WN		DATE: 11/19/2020
DRAWN BY: SO		FILE NO: <b>1/4992</b>
JAMES C. PORTER, DIRECTOR OF PUBLIC WORKS SAN MATEO COUNTY		555 COUNTY CENTER, 5TH FLOOR REDWOOD CITY, CALIFORNIA 94063-1665
		<b>9</b> SHEET 9 OF 25

F:\Users\design\C3D\E4992000\_Countywide Pavement Maintenance\11 DWG



APPROVED:  
NOVEMBER 24, 2020  
JAMES C. PORTER, DIRECTOR OF PUBLIC WORKS  
R. C. E. # 48056 / EXPIRES 12-31-2021

LEGEND:

- 999 PROPERTY ADDRESS
- # PAVEMENT REPAIR AREA
- (S) "STOP" LEGEND (WHITE) (B 23)
- (X) "XING" LEGEND (WHITE) (B 23)
- (P) "PED" LEGEND (WHITE) (B 23)
- [X] BLUE FIRE HYDRANT MARKER
- RIGHT-OF-WAY LIMITS
- 12" [SB] STOP BAR
- PROJECT ORANGE ADVISORY SIGN
- [||||] LADDER TYPE CROSSWALK (G 22)
- BASIC TYPE CROSSWALK (H 22)

NOTES:

1. REFER TO SHEET 1 FOR GENERAL NOTES.
2. PROJECT ADVISORY SIGN LOCATIONS AND TOTALS ARE APPROXIMATE ONLY AND SHALL BE GOVERNED BY THE COUNTY APPROVED TRAFFIC CONTROL PLAN.



DALY CITY AREA

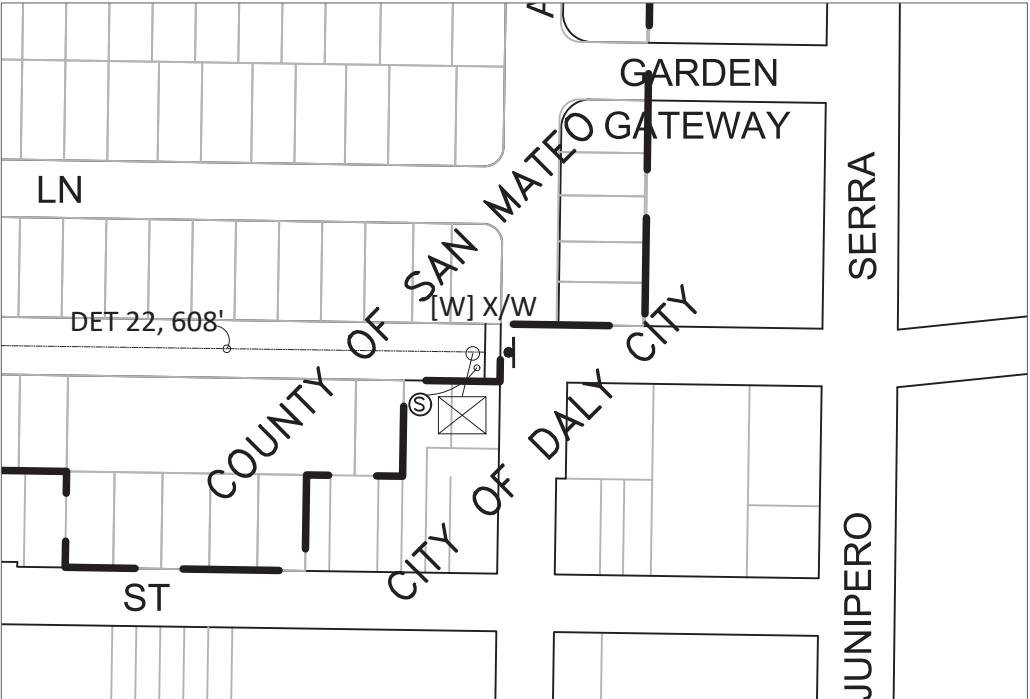

87TH ST IN DALY CITY  
RIGHT OF WAY DETAIL  
N.T.S. (A 10)

DALY CITY AREA PAVEMENT REPAIR							
STREET	LOCATION	NO.	TREATMENT DEPTH/DETAIL	APPROX. AVG. WIDTH (FT)	APPROX. AVG. LENGTH (FT)	AREA (SF)	AREA (SY)
WASHINGTON ST	1024 Washington St	1	3"/E-21	7	20	140.0	15.6
	1016 Washington St	2	3"/E-21	10	20	200.0	22.2
	1015 Washington St	3	3"/E-21	4	22	88.0	9.8
	1006 Washington St	4	3"/E-21	7	125	875.0	97.2
	1002 Washington St	5	3"/E-21	4	80	320.0	35.6
	1002 Washington St	6	3"/E-21	4	12	48.0	5.3
						SUBTOTAL 3":	186
						SUBTOTAL 6":	0



DESIGNED BY: SO	COUNTYWIDE PAVEMENT MAINTENANCE PROJECT <b>PAVEMENT REPAIR/STRIPING</b> <b>DALY CITY AREA</b>	SCALE: NO SCALE
CHECKED BY: WN		DATE: 11/19/2020
DRAWN BY: SO		FILE NO: <b>1/4992</b>
JAMES C. PORTER, DIRECTOR OF PUBLIC WORKS SAN MATEO COUNTY		555 COUNTY CENTER, 5TH FLOOR REDWOOD CITY, CALIFORNIA 94063-1665
		<b>10</b> SHEET 10 OF 25



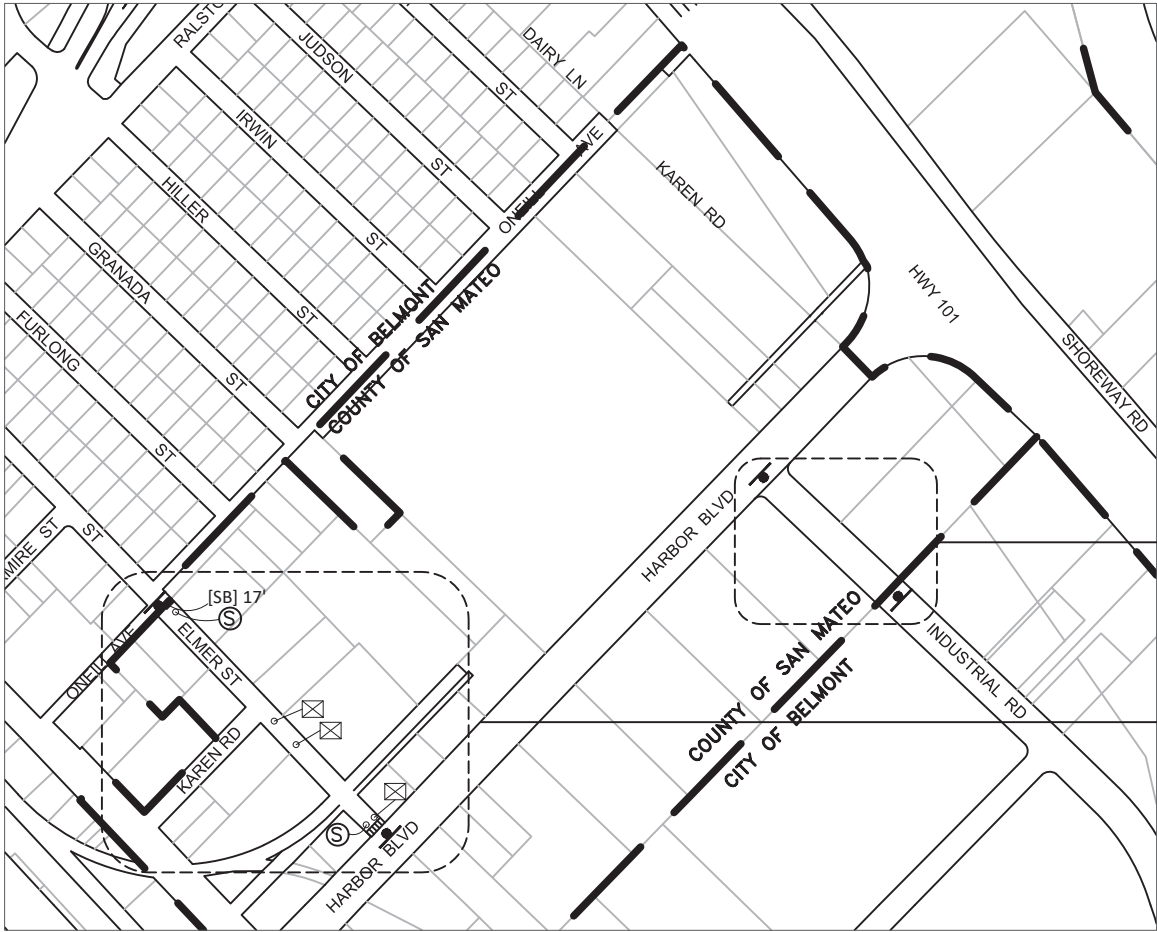

HARBOR/INDUSTRIAL AREA

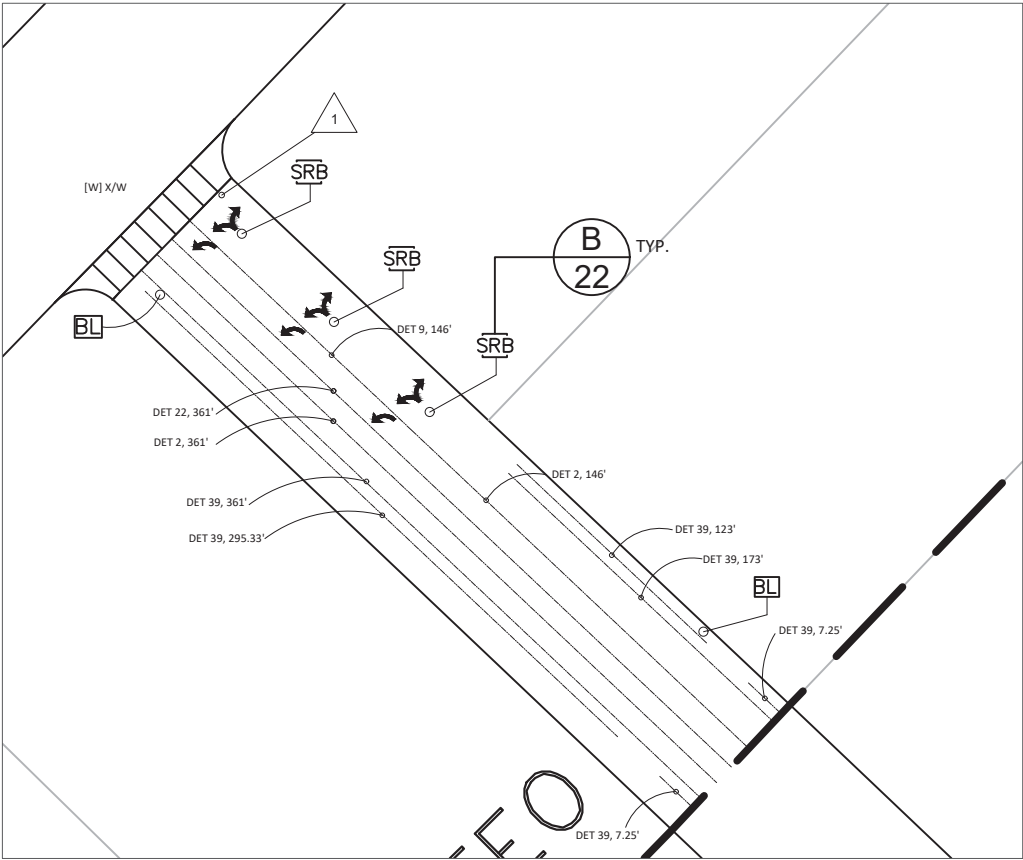

INDUSTRIAL RD  
PAVEMENT LEGEND DETAIL

A  
11

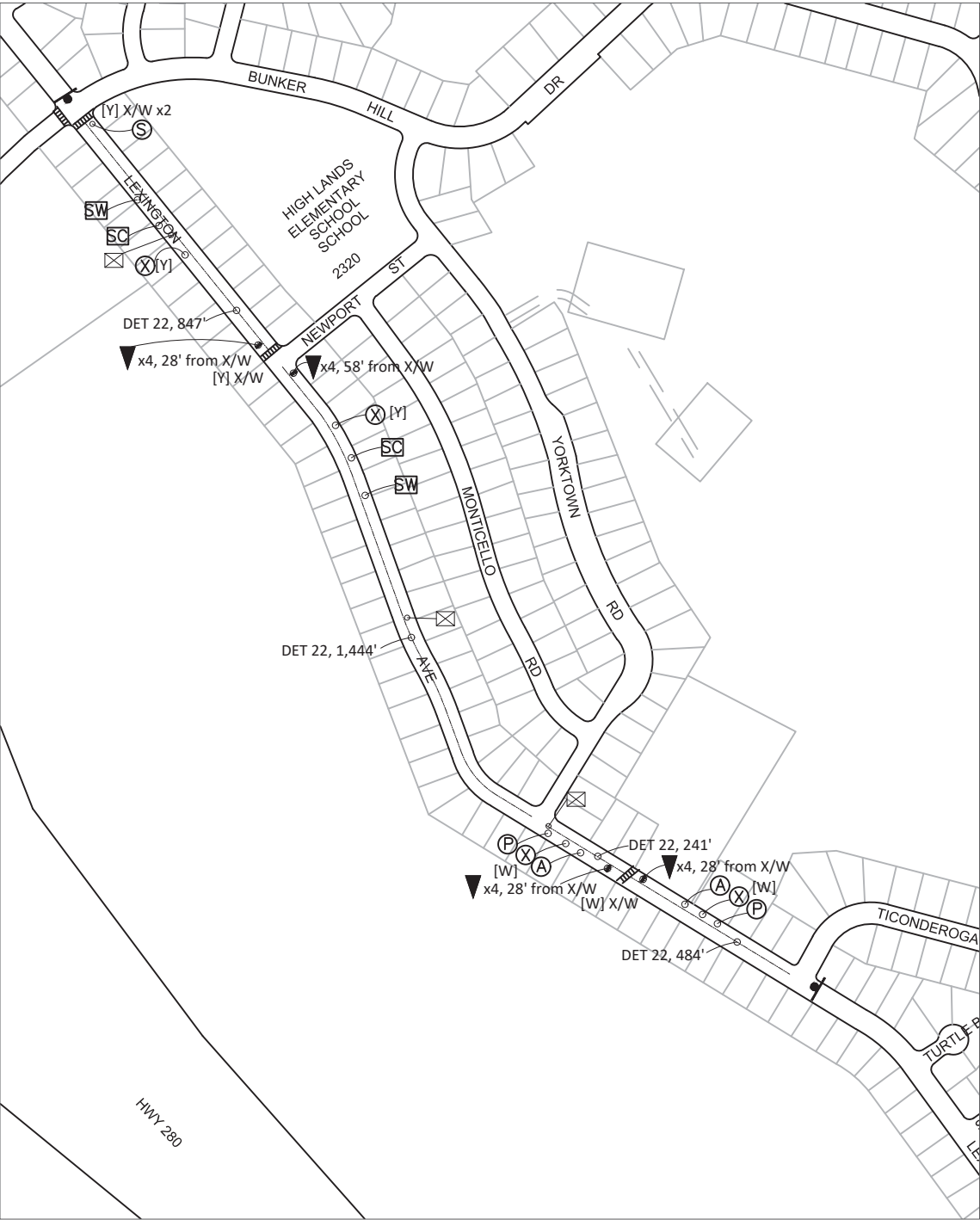

SAN MATEO HIGHLANDS AREA

INDUSTRIAL RD AREA PAVEMENT REPAIR							
STREET	LOCATION	NO.	TREATMENT DEPTH/DETAIL	APPROX. AVG. WIDTH (FT)	APPROX. AVG. LENGTH (FT)	AREA (SF)	AREA (SY)
INDUSTRIAL	Near the intersection of Industrial Rd & Harbor Blvd	1	6"/D-21	4	6	24.0	2.7
						SUBTOTAL 3":	0
						SUBTOTAL 6":	3



DESIGNED BY: SO	COUNTYWIDE PAVEMENT MAINTENANCE PROJECT <b>PAVEMENT REPAIR/STRIPING</b> <b>SAN MATEO HIGHLANDS + HARBOR/INDUSTRIAL AREA</b>		SCALE: NO SCALE
CHECKED BY: WN			DATE: 11/19/2020
DRAWN BY: SO			FILE NO: 1/4992
JAMES C. PORTER, DIRECTOR OF PUBLIC WORKS SAN MATEO COUNTY		555 COUNTY CENTER, 5TH FLOOR REDWOOD CITY, CALIFORNIA 94063-1665	11 SHEET 11 OF 25



APPROVED:  
NOVEMBER 24, 2020  
JAMES C. PORTER, DIRECTOR OF PUBLIC WORKS  
R. C. E. # 48056 / EXPIRES 12-31-2021

LEGEND:

- 999 PROPERTY ADDRESS
- # PAVEMENT REPAIR AREA
- S "STOP" LEGEND (WHITE) B 23
- X "XING" LEGEND (YELLOW/WHITE) B 23
- P "PED" LEGEND (WHITE) B 23
- A "AHEAD" LEGEND (WHITE) B 23
- SC "SCHOOL" LEGEND (YELLOW) B 23
- SW "SLOW" LEGEND (YELLOW) B 23
- Blue Fire Hydrant Marker
- BL BIKE LANE/ARROW SYMBOL (WHITE) C 22 & E 22
- SRB SHARED ROAD BICYCLE MARKING (WHITE/GREEN) B 22
- RIGHT-OF-WAY LIMITS
- 12" [SB] STOP BAR
- Project Orange Advisory Sign
- Ladder Type Crosswalk G 22
- Yield Line Triangles I 22
- Type III (L) Arrow F 21
- Type III (B) Arrow G 21

NOTES:

- REFER TO SHEET 1 FOR GENERAL NOTES.
- PROJECT ADVISORY SIGN LOCATIONS AND TOTALS ARE APPROXIMATE ONLY AND SHALL BE GOVERNED BY THE COUNTY APPROVED TRAFFIC CONTROL PLAN.

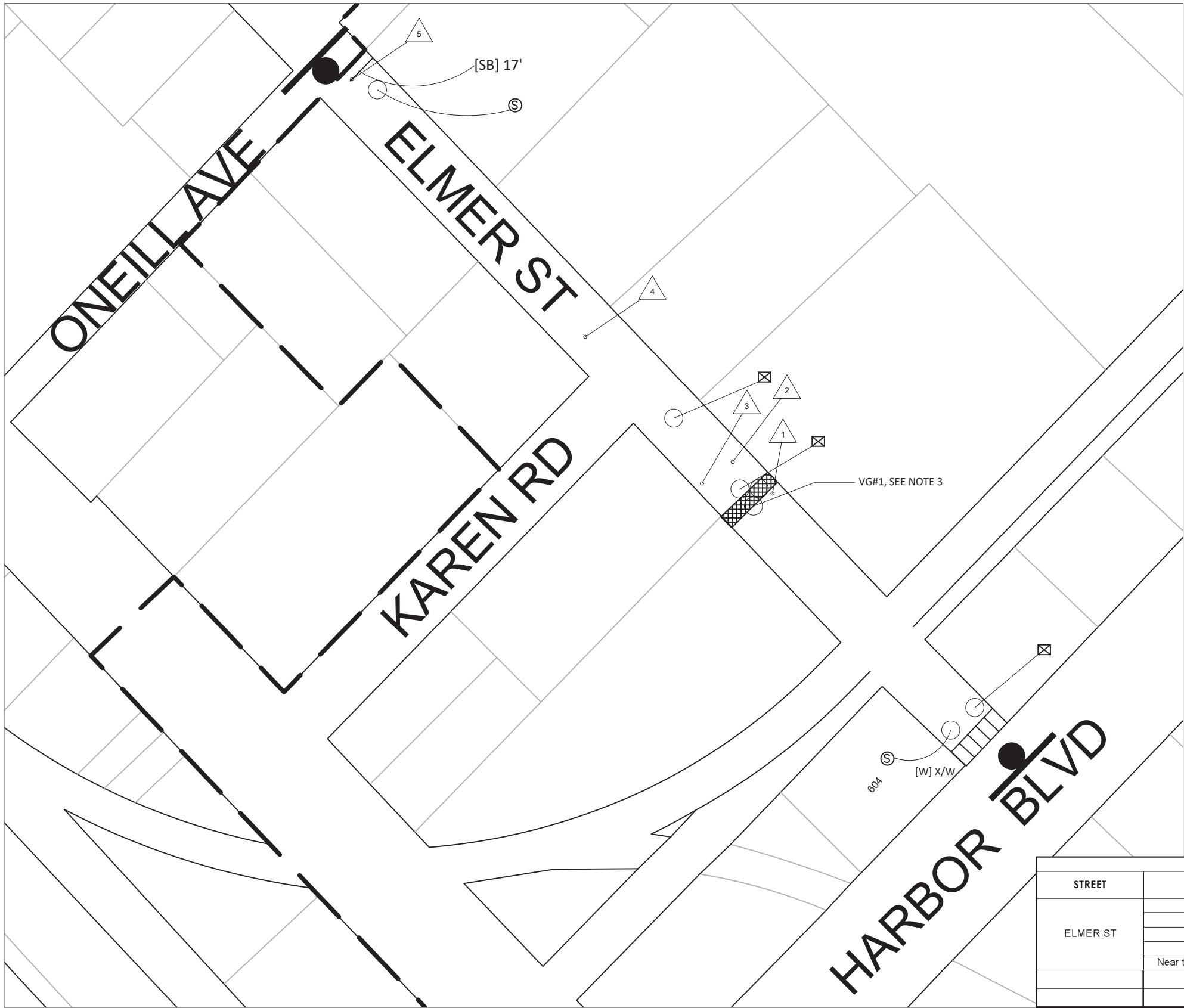

APPROVED:

NOVEMBER 24, 2020

JAMES C. PORTER, DIRECTOR OF PUBLIC WORKS  
R. C. E. # 48056 / EXPIRES 12-31-2021

NOTES:

- 1. REFER TO SHEET 1 FOR GENERAL NOTES.
- 2. PROJECT ADVISORY SIGN LOCATIONS AND TOTALS ARE APPROXIMATE ONLY AND SHALL BE GOVERNED BY THE COUNTY APPROVED TRAFFIC CONTROL PLAN.
- 3. DEMO/REPLACE EXISTING 38' VALLEY GUTTER AND CONCRETE APRON AT ELMER ST ADJACENT TO THE ALLEY BEHIND 604 HARBOR BLVD. REFER TO DETAIL D ON SHEET 24.

LEGEND:

- 999 PROPERTY ADDRESS
- # PAVEMENT REPAIR AREA
- ☒ BLUE FIRE HYDRANT MARKER
- - - RIGHT-OF-WAY LIMITS
- 12" [SB] STOP BAR
- PROJECT ORANGE ADVISORY SIGN
- ||||| LADDER TYPE CROSSWALK
- ▢ MISC. CONCRETE WORK

HARBOR/INDUSTRIAL- VALLEY GUTTER RAMP TABLE				
NEIGHBORHOOD AREA	L	W	THK	VALLEY GUTTER, CY
VG #1	38	6	0.67	5.7
TOTAL				5.7

HARBOR AREA PAVEMENT REPAIR							
STREET	LOCATION	NO.	TREATMENT DEPTH/DETAIL	APPROX. AVG. WIDTH (FT)	APPROX. AVG. LENGTH (FT)	AREA (SF)	AREA (SY)
ELMER ST	Near valley gutter at 1309 Elmer St	1	6"/D-21	13	15	195.0	21.7
	Near valley gutter at 1309 Elmer St	2	6"/D-21	8	14	112.0	12.4
	Near valley gutter at 1309 Elmer St	3	6"/D-21	4	6	24.0	2.7
	1304 Elmer St	4	6"/D-21	4	8	32.0	3.6
	Near the intersection of Elmer St & O'Neill Ave	5	6"/D-21	4	8	32.0	3.6
						SUBTOTAL 3":	0
						SUBTOTAL 6":	44

ELMER ST  
PAVEMENT LEGEND DETAIL

N.T.S. A 12



DESIGNED BY: SO	COUNTYWIDE PAVEMENT MAINTENANCE PROJECT <b>PAVEMENT REPAIR/CONC. WORK/STRIPING</b> <b>ELMER ST DETAIL</b>	SCALE: NO SCALE
CHECKED BY: WN		DATE: 11/19/2020
DRAWN BY: SO		FILE NO: <b>1/4992</b>
JAMES C. PORTER, DIRECTOR OF PUBLIC WORKS SAN MATEO COUNTY		555 COUNTY CENTER, 5TH FLOOR REDWOOD CITY, CALIFORNIA 94063-1665
		<b>12</b> SHEET 12 OF 25

F:\Users\design\C3D\E4992000\_Countywide Pavement Maintenance\11 DWG



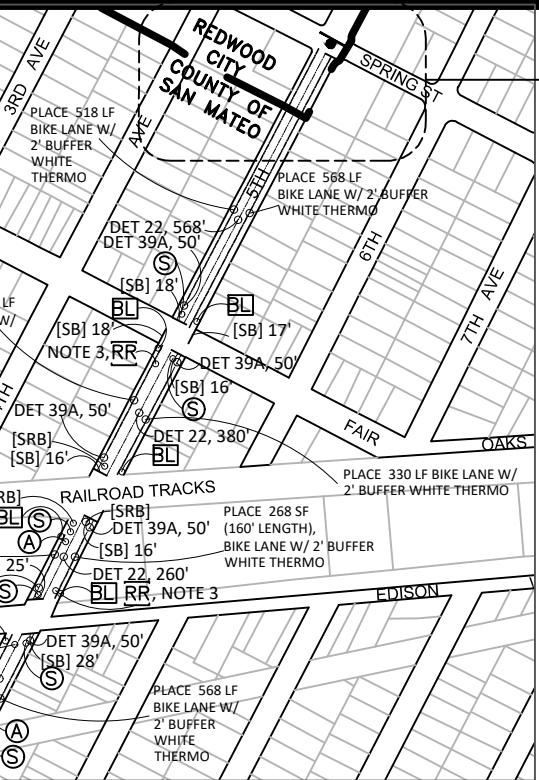
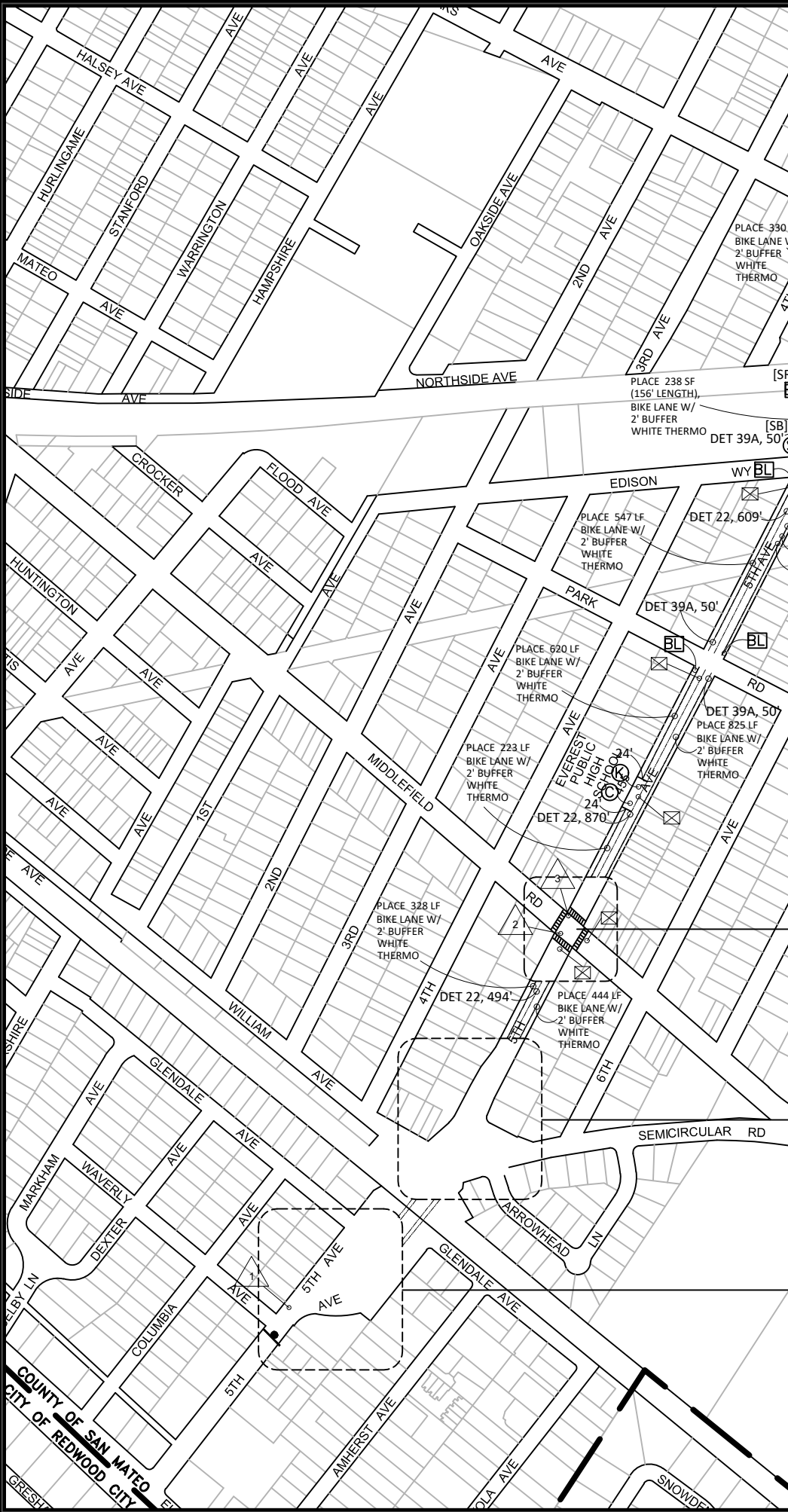

### NORTH FAIR OAKS AREA #1

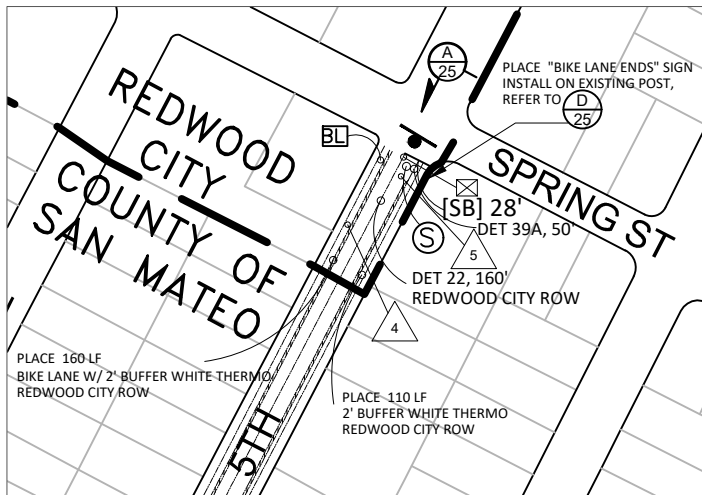

### 5TH AVE & SPRING ST PAVEMENT LEGEND DETAIL

N.T.S.

A  
13

### 5TH AVE & MIDDLEFIELD RD PAVEMENT LEGEND DETAIL

N.T.S.

B  
13

#### NORTH FAIR OAKS AREA #1 PAVEMENT REPAIR

STREET	LOCATION	NO.	TREATMENT DEPTH/DETAIL	APPROX. AVG. WIDTH (FT)	APPROX. AVG. LENGTH (FT)	AREA (SF)	AREA (SY)
5TH AVE	101 Fifth Ave	1	6"/D-21	20	73	1460.0	162.2
	Intersection of 5th Ave & Middlefield (South Side)	2	6"/D-21	24	58	1392.0	154.7
	Intersection of 5th Ave & Middlefield (North Side)	3	6"/D-21	15	17	255.0	28.3
	793 Fifth Ave (RWC ROW)	4	6"/D-21	4	26	104.0	11.6
	796 Fifth Ave, Near Intersection of 5th Ave & Spring St (RWC ROW)	5	6"/D-21	9	54	486.0	54.0
						SUBTOTAL 3":	0
						SUBTOTAL 6":	411



DESIGNED BY: SO  
CHECKED BY: WN  
DRAWN BY: SO

JAMES C. PORTER, DIRECTOR OF PUBLIC WORKS  
SAN MATEO COUNTY

### COUNTYWIDE PAVEMENT MAINTENANCE PROJECT PAVEMENT REPAIR/STRIPING NORTH FAIR OAKS AREA #1

555 COUNTY CENTER, 5TH FLOOR  
REDWOOD CITY, CALIFORNIA 94063-1665

SCALE: NO SCALE  
DATE: 11/19/2020  
FILE NO: 1/4992

13  
SHEET 13 OF 25

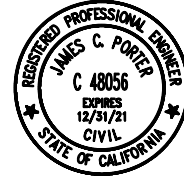

APPROVED:

NOVEMBER 24, 2020

JAMES C. PORTER, DIRECTOR OF PUBLIC WORKS  
R. C. E. # 48056 / EXPIRES 12-31-2021

### LEGEND:

- 999 PROPERTY ADDRESS
- # PAVEMENT REPAIR AREA
- S "STOP" LEGEND (WHITE)
- K "KEEP" LEGEND (WHITE)
- C "CLEAR" LEGEND (WHITE)
- A "AHEAD" LEGEND (WHITE)
- SC "SCHOOL" LEGEND (YELLOW)
- SW "SLOW" LEGEND (YELLOW)
- RR RAILROAD CROSSING SYMBOL
- BLD BICYCLE LOOP DETECTOR SYMBOL
- BL BIKE LANE/ARROW SYMBOL (WHITE)
- SRB SHARED ROAD BICYCLE MARKING (WHITE/GREEN)
- Blue Fire Hydrant Marker
- Right-of-Way Limits
- 12" [SB] STOP BAR
- Project Orange Advisory Sign
- Ladder Type Crosswalk
- Green ThermoPlastic Bike Lane
- Bike Lane Striped Buffer
- Type IV (R) Arrow

### NOTES:

- REFER TO SHEET 1 FOR GENERAL NOTES.
- PROJECT ADVISORY SIGN LOCATIONS AND TOTALS ARE APPROXIMATE ONLY AND SHALL BE GOVERNED BY THE COUNTY APPROVED TRAFFIC CONTROL PLAN.
- MINIMUM DISTANCE FROM CENTER OF RAILROAD TRACKS TO BEGINNING OF RAILROAD CROSSING SYMBOL SHALL BE 250 FT. ALL RAILROAD BARS SHALL BE 16 FT IN WIDTH ON 5TH AVE.

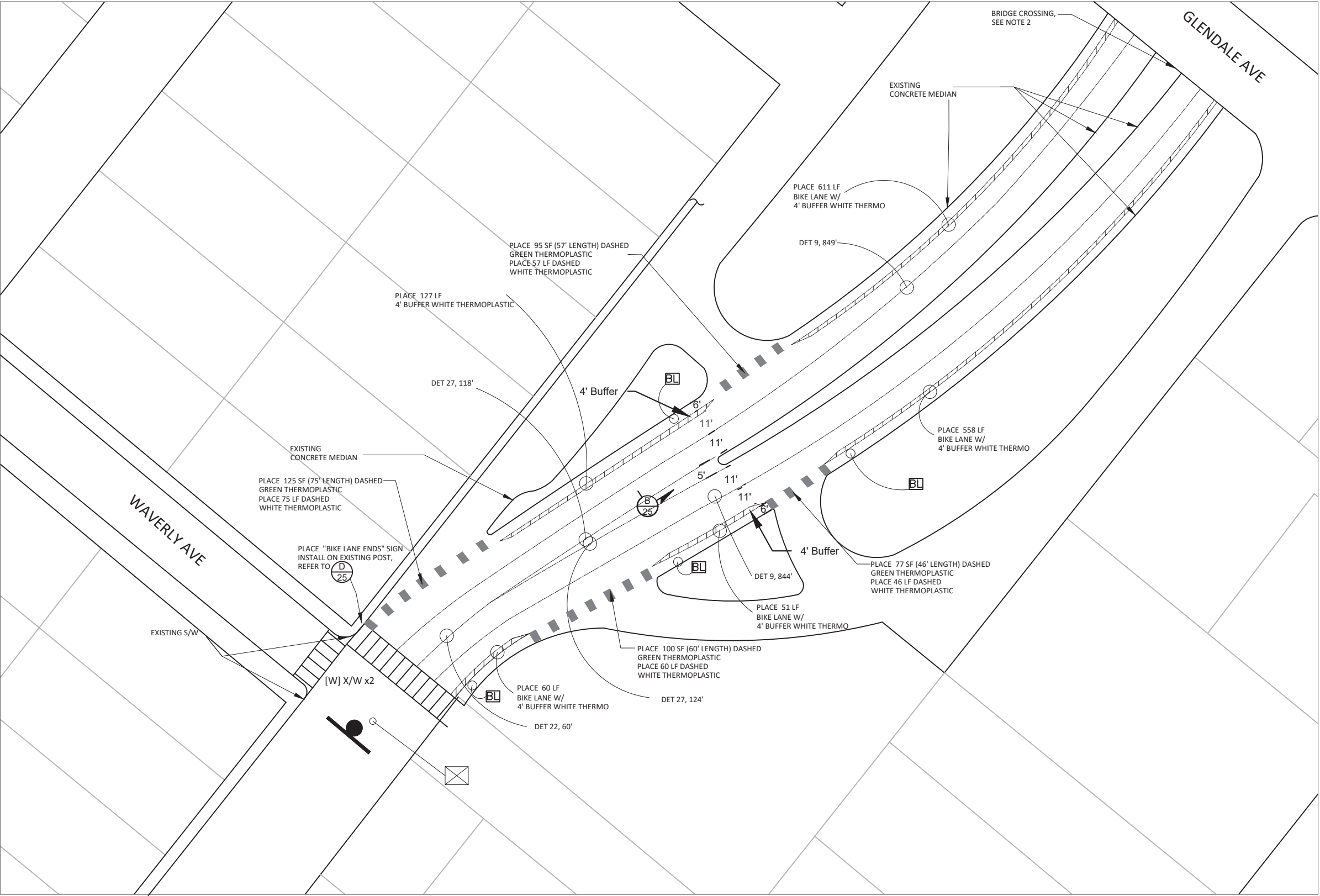

APPROVED:

NOVEMBER 24, 2020

JAMES C. PORTER, DIRECTOR OF PUBLIC WORKS  
R. C. E. # 48056 / EXPIRES 12-31-2021

**LEGEND:**

- 999 PROPERTY ADDRESS
- # PAVEMENT REPAIR AREA
- BL BIKE LANE/ARROW SYMBOL (WHITE) (C 22) & (E 22)
- ☒ BLUE FIRE HYDRANT MARKER
- RIGHT-OF-WAY LIMITS
- 12" [SB] STOP BAR
- |||| LADDER TYPE CROSSWALK (G 22)
- PROJECT ADVISORY SIGN
- ||| GREEN THERMOPLASTIC BIKE LANE (F 22)
- === BIKE LANE STRIPED BUFFER (C 23)

**NOTES:**

1. REFER TO SHEET 1 FOR GENERAL NOTES.
2. PAVEMENT AND STRIPING SHALL CONTINUE BEYOND BRIDGE CROSSING

5TH AVE & WAVERLY AVE  
PAVEMENT LEGEND DETAIL

A  
14  
N.T.S.



DESIGNED BY: SO	COUNTYWIDE PAVEMENT MAINTENANCE PROJECT <b>PAVEMENT REPAIR/STRIPING</b> <b>5TH AVE + WAVERLY AVE DETAIL</b>	SCALE: NO SCALE
CHECKED BY: WN		DATE: 11/19/2020
DRAWN BY: SO		FILE NO: <b>1/4992</b>
JAMES C. PORTER, DIRECTOR OF PUBLIC WORKS SAN MATEO COUNTY		555 COUNTY CENTER, 5TH FLOOR REDWOOD CITY, CALIFORNIA 94063-1665
		<b>14</b> 6HEET 14 OF 25

F:\Users\design\C3D\E4992000\_Countwide Pavement Maintenance\11 DWG



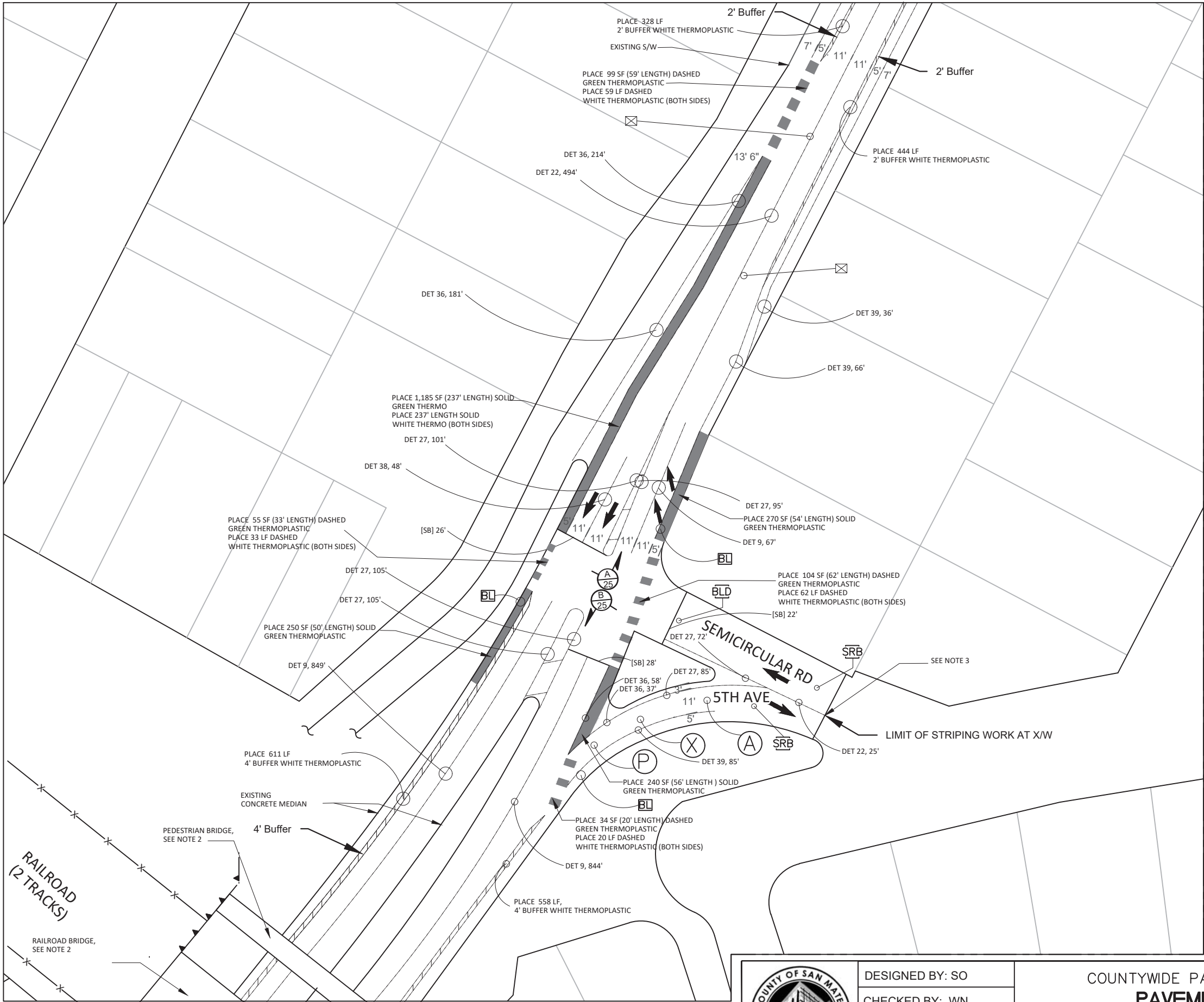

APPROVED: \_\_\_\_\_  
NOVEMBER 24, 2020  
JAMES C. PORTER, DIRECTOR OF PUBLIC WORKS  
R. C. E. # 48056 / EXPIRES 12-31-2021

- LEGEND:**
- 999 PROPERTY ADDRESS
  - # PAVEMENT REPAIR AREA
  - (S) "STOP" LEGEND (WHITE)
  - (X) "XING" LEGEND (WHITE)
  - (P) "PED" LEGEND (WHITE)
  - (A) "AHEAD" LEGEND (WHITE)
  - BL BIKE LANE/ARROW SYMBOL (WHITE)
  - Blue Fire Hydrant Marker
  - Right-of-Way Limits
  - 12" [SB] STOP BAR
  - Ladder Type Crosswalk
  - Type I Arrow
  - Type VI Arrow
  - Green Thermoplastic Bike Lane
  - Bike Lane Striped Buffer
  - Bicycle Loop Detector Symbol
  - Shared Road Bicycle Marking (White)

- NOTES:**
- REFER TO SHEET 1 FOR GENERAL NOTES.
  - PAVEMENT AND STRIPING SHALL CONTINUE BEYOND BRIDGE CROSSING
  - CONTRACTOR SHALL REMOVE EXISTING PAVEMENT MARKERS AND STRIPING ON AREAS THAT ARE NOT BEING SURFACE TREATED BEFORE STRIPING WITH NEW DETAILS.

5TH AVE & SEMICIRCULAR RD  
PAVEMENT LEGEND DETAIL



DESIGNED BY: SO	COUNTYWIDE PAVEMENT MAINTENANCE PROJECT <b>PAVEMENT REPAIR/STRIPING</b> <b>5TH AVE + SEMICIRCULAR RD DETAIL</b>	SCALE: NO SCALE
CHECKED BY: WN		DATE: 11/19/2020
DRAWN BY: SO		FILE NO: <b>1/4992</b>
JAMES C. PORTER, DIRECTOR OF PUBLIC WORKS SAN MATEO COUNTY		555 COUNTY CENTER, 5TH FLOOR REDWOOD CITY, CALIFORNIA 94063-1665
		<b>15</b> SHEET 15 OF 25



APPROVED:  
NOVEMBER 24, 2020

JAMES C. PORTER, DIRECTOR OF PUBLIC WORKS  
R. C. E. # 48056 / EXPIRES 12-31-2021

LEGEND:

- 999 PROPERTY ADDRESS
- # PAVEMENT REPAIR AREA
- (S) "STOP" LEGEND (WHITE)
- (X) "XING" LEGEND (WHITE)
- (SC) "SCHOOL" LEGEND (YELLOW)
- (SW) "SLOW" LEGEND (YELLOW)
- (X) BLUE FIRE HYDRANT MARKER
- RIGHT-OF-WAY LIMITS
- 12" [SB] STOP BAR
- (P) PROJECT ORANGE ADVISORY SIGN
- (L) LADDER TYPE CROSSWALK

NOTES:

1. REFER TO SHEET 1 FOR GENERAL NOTES.
2. PROJECT ADVISORY SIGN LOCATIONS AND TOTALS ARE APPROXIMATE ONLY AND SHALL BE GOVERNED BY THE COUNTY APPROVED TRAFFIC CONTROL PLAN.
3. ACCESSIBLE ON-STREET PARKING SPACES SHALL NOT BE SMALLER IN LENGTH OR WIDTH THAN THAT SPECIFIED BY THE LOCAL JURISDICTION FOR OTHER PARKING SPACE, BUT NOT LESS THAN 8'-0" IN WIDTH.



NORTH FAIR OAKS AREA #2

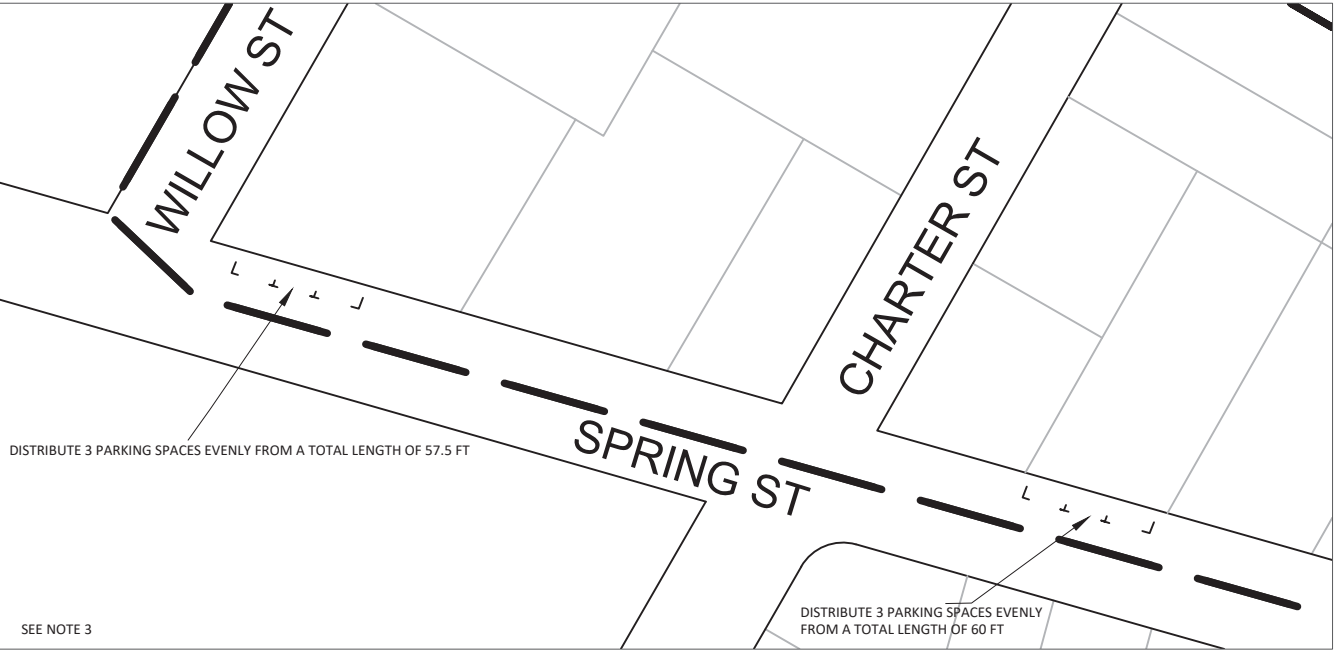

STREET PARKING SPACES  
IN SPRING ST

NORTH FAIR OAKS AREA #2 PAVEMENT REPAIR						
STREET	LOCATION	NO.	TREATMENT DEPTH/DETAIL	APPROX. AVG. WIDTH (FT)	APPROX. AVG. LENGTH (FT)	AREA (SF)
	Crosswalk of Spring St and 2nd Ave	1	3"/E-21	10	44	440.0
	2999 Spring St	2	6"/D-21	4	12	48.0
	Mobile Park	3	3"/E-21	4	52	208.0
	2971-2901 Spring St	4	3"/E-21	4	66	264.0
	Intersection of Spring St and Barron Ave	5	6"/D-21	4	24	96.0
	2865 Spring St	6	6"/D-21	5	13	65.0
	2831 Spring St	7	6"/D-21	5	13	65.0
	Intesection of Spring St and Warrington	8	6"/D-21	6	8	48.0
	2793-2745 Spring St	9	3"/E-21	4	87	348.0
	Intersection of Spring St and Hurlingame Ave	10	6"/D-21	10	30	300.0
	2661-2605 Spring St	11	3"/E-21	4	207	828.0
SPRING ST	Intersection of Spring St & Douglas Ave (North Side)	12	6"/D-21	6	8	48.0
	2573-2503 Spring St	13	6"/D-21	7	39	273.0
	2391-2303 Spring St	14	6"/D-21	7	40	280.0
	Intersection of Spring St & Charter St (North Side)	15	6"/D-21	4	8	32.0
	2231 Spring St (North Side)	16	6"/D-21	16	50	800.0
	Intersection of Spring St & Willow St (North Side)	17	3"/E-21	10	50	500.0
	Intersection of Spring St & Charter St (South Side)	18	6"/D-21	6	8	48.0
	2261-2231 Spring St (South Side)	19	3"/E-21	4	137	548.0
	2231 Spring St (South Side)	20	6"/D-21	10	23	230.0
	2231 Spring St (South Side)	21	6"/D-21	4	8	32.0
	Intersection of Spring St & Willow St (South Side)	22	6"/D-21	8	8	64.0
						SUBTOTAL 3":
						SUBTOTAL 6":



DESIGNED BY: SO  
CHECKED BY: WN  
DRAWN BY: SO

COUNTYWIDE PAVEMENT MAINTENANCE PROJECT  
PAVEMENT REPAIR/STRIPING  
NORTH FAIR OAKS AREA #2

JAMES C. PORTER, DIRECTOR OF PUBLIC WORKS  
SAN MATEO COUNTY

555 COUNTY CENTER, 5TH FLOOR  
REDWOOD CITY, CALIFORNIA 94063-1665

SCALE: NO SCALE  
DATE: 11/19/2020  
FILE NO: 1/4992  
16  
SHEET 16 OF 25

F:\Users\design\C3D\E4992000\_Countywide Pavement Maintenance\11 DWG



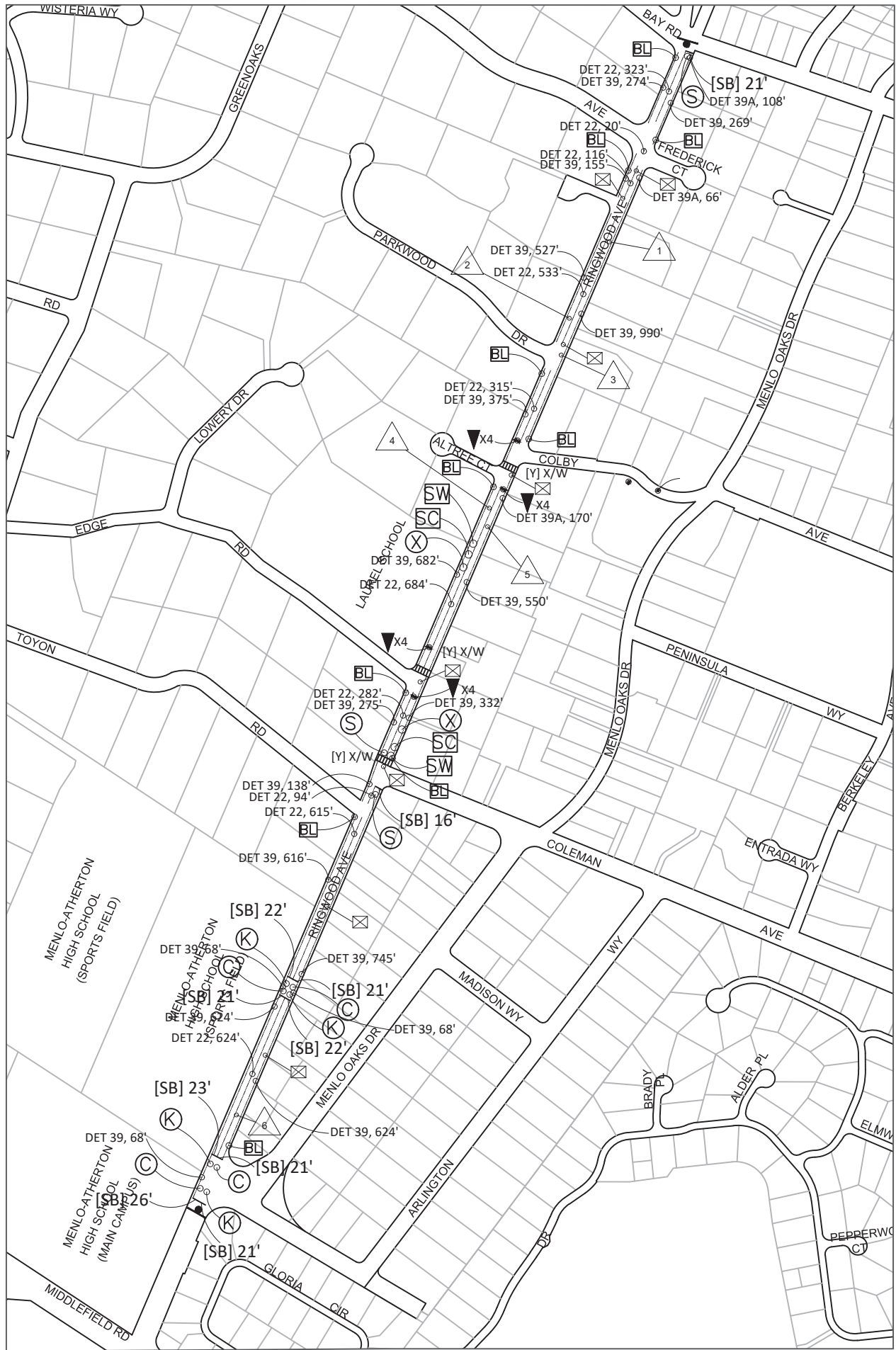

MENLO OAKS AREA



APPROVED:  
NOVEMBER 24, 2020  
JAMES C. PORTER, DIRECTOR OF PUBLIC WORKS  
R. C. E. # 48056 / EXPIRES 12-31-2021

LEGEND:

- 999 PROPERTY ADDRESS
- # PAVEMENT REPAIR AREA
- S "STOP" LEGEND (WHITE)
- X "XING" LEGEND (WHITE)
- K "KEEP" LEGEND (WHITE)
- C "CLEAR" LEGEND (WHITE)
- SC "SCHOOL" LEGEND (YELLOW)
- SW "SLOW" LEGEND (YELLOW)
- BL BIKE LANE/ARROW SYMBOL (WHITE)
- X BLUE FIRE HYDRANT MARKER
- RIGHT-OF-WAY LIMITS
- 12" [SB] STOP BAR
- PROJECT ORANGE ADVISORY SIGN
- ||||| LADDER TYPE CROSSWALK
- ▼ YIELD LINE TRIANGLES

NOTES:

- REFER TO SHEET 1 FOR GENERAL NOTES.
- PROJECT ADVISORY SIGN LOCATIONS AND TOTALS ARE APPROXIMATE ONLY AND SHALL BE GOVERNED BY THE COUNTY APPROVED TRAFFIC CONTROL PLAN.

MENLO OAKS AREA PAVEMENT REPAIR							
STREET	LOCATION	NO.	TREATMENT DEPTH/DETAIL	APPROX. AVG. WIDTH (FT)	APPROX. AVG. LENGTH (FT)	AREA (SF)	AREA (SY)
RINGWOOD AVE	890 Ringwood Ave	1	3"/E-21	4	27	108.0	12.0
	Near Interesection of Ringwood Ave & Parkwood Dr	2	3"/E-21	4	70	280.0	31.1
	Interesection of Ringwood Ave & Parkwood Dr	3	3"/E-21	7	22	154.0	17.1
	680-670 Ringwood Ave (West Side)	4	3"/E-21	7	122	854.0	94.9
	680-670 Ringwood Ave (East Side)	5	3"/E-21	4	54	216.0	24.0
	220 Ringwood Ave	6	6"/D-21	4	4	16.0	1.8
						SUBTOTAL 3":	179
						SUBTOTAL 6":	2



DESIGNED BY: SO	COUNTYWIDE PAVEMENT MAINTENANCE PROJECT <b>PAVEMENT REPAIR/STRIPING</b> <b>MENLO OAKS AREA</b>	SCALE: NO SCALE
CHECKED BY: WN		DATE: 11/19/2020
DRAWN BY: SO		FILE NO: 1/4992
JAMES C. PORTER, DIRECTOR OF PUBLIC WORKS SAN MATEO COUNTY		555 COUNTY CENTER, 5TH FLOOR REDWOOD CITY, CALIFORNIA 94063-1665

F:\Users\design\C3D\E4992000\_Countywide Pavement Maintenance\11 DWG



APPROVED:   
NOVEMBER 24, 2020   
JAMES C. PORTER, DIRECTOR OF PUBLIC WORKS   
R. C. E. # 48056 / EXPIRES 12-31-2021

LEGEND:

- 999 PROPERTY ADDRESS
- # PAVEMENT REPAIR AREA
- BS "BUS STOP" LEGEND (WHITE) (B 23)
- BL BIKE LANE/ARROW SYMBOL (WHITE) (C 22) & (E 22)
- SW "SLOW" LEGEND (YELLOW) (B 23)
- SC "SCHOOL" LEGEND (YELLOW) (B 23)
- X "XING" LEGEND (YELLOW) (B 23)
- Blue Fire Hydrant Marker
- RIGHT-OF-WAY LIMITS
- 12" [SB] STOP BAR
- PROJECT ORANGE ADVISORY SIGN
- LADDER TYPE CROSSWALK (G 22)
- TYPE IV (L) ARROW (J 21)
- GREEN DASHED BIKE LANE (F 22)

NOTES:

- 1. REFER TO SHEET 1 FOR GENERAL NOTES.
- 2. PROJECT ADVISORY SIGN LOCATIONS AND TOTALS ARE APPROXIMATE ONLY AND SHALL BE GOVERNED BY THE COUNTY APPROVED TRAFFIC CONTROL PLAN.
- 3. SIDEWALK NOT SHOWN ON THIS SHEET

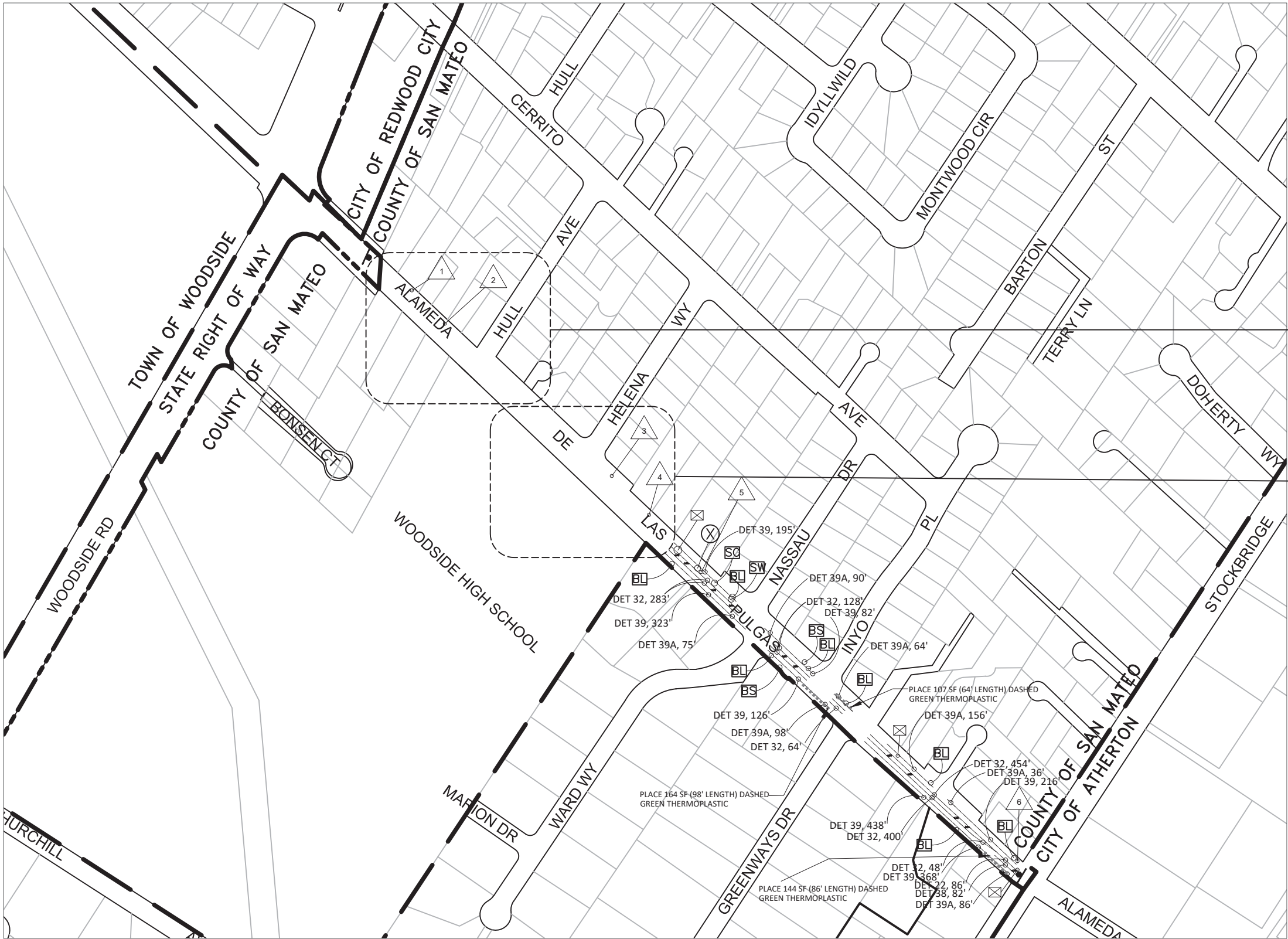

SEQUOIA TRACT AREA

SEQUOIA TRACT AREA PAVEMENT AREA							
STREET	LOCATION	NO.	TREATMENT DEPTH/DETAIL	APPROX. AVG. WIDTH (FT)	APPROX. AVG. LENGTH (FT)	AREA (SF)	AREA (SY)
ALAMEDA DE LAS PULGAS	2163-2175 Alameda de las Pulgas	1	3"/E-21	7	84	588.0	65.3
	2187 Alameda de las Pulgas	2	3"/E-21	4	52	208.0	23.1
	Near Intersection of Alameda de las Pulgas & Helena WayParkwood Dr	3	3"/E-21	14	115	1610.0	178.9
	2283 Alameda de las Pulgas	4	3"/E-21	7	26	182.0	20.2
	2323 Alameda de las Pulgas	5	3"/E-21	4	59	236.0	26.2
	Near Intersection of Alameda de las Pulgas & Stockbridge Ave	6	6"/D-21	4	10	40.0	4.4
						SUBTOTAL 3":	314
						SUBTOTAL 6":	4



DESIGNED BY: SO	COUNTYWIDE PAVEMENT MAINTENANCE PROJECT  <b>PAVEMENT REPAIR/STRIPING</b>  <b>SEQUOIA TRACT AREA</b>	SCALE: NO SCALE
CHECKED BY: WN		DATE: 11/19/2020
DRAWN BY: SO		FILE NO: <b>1/4992</b>
JAMES C. PORTER, DIRECTOR OF PUBLIC WORKS SAN MATEO COUNTY		
555 COUNTY CENTER, 5TH FLOOR REDWOOD CITY, CALIFORNIA 94063-1665		<b>18</b> SHEET 18 OF 25



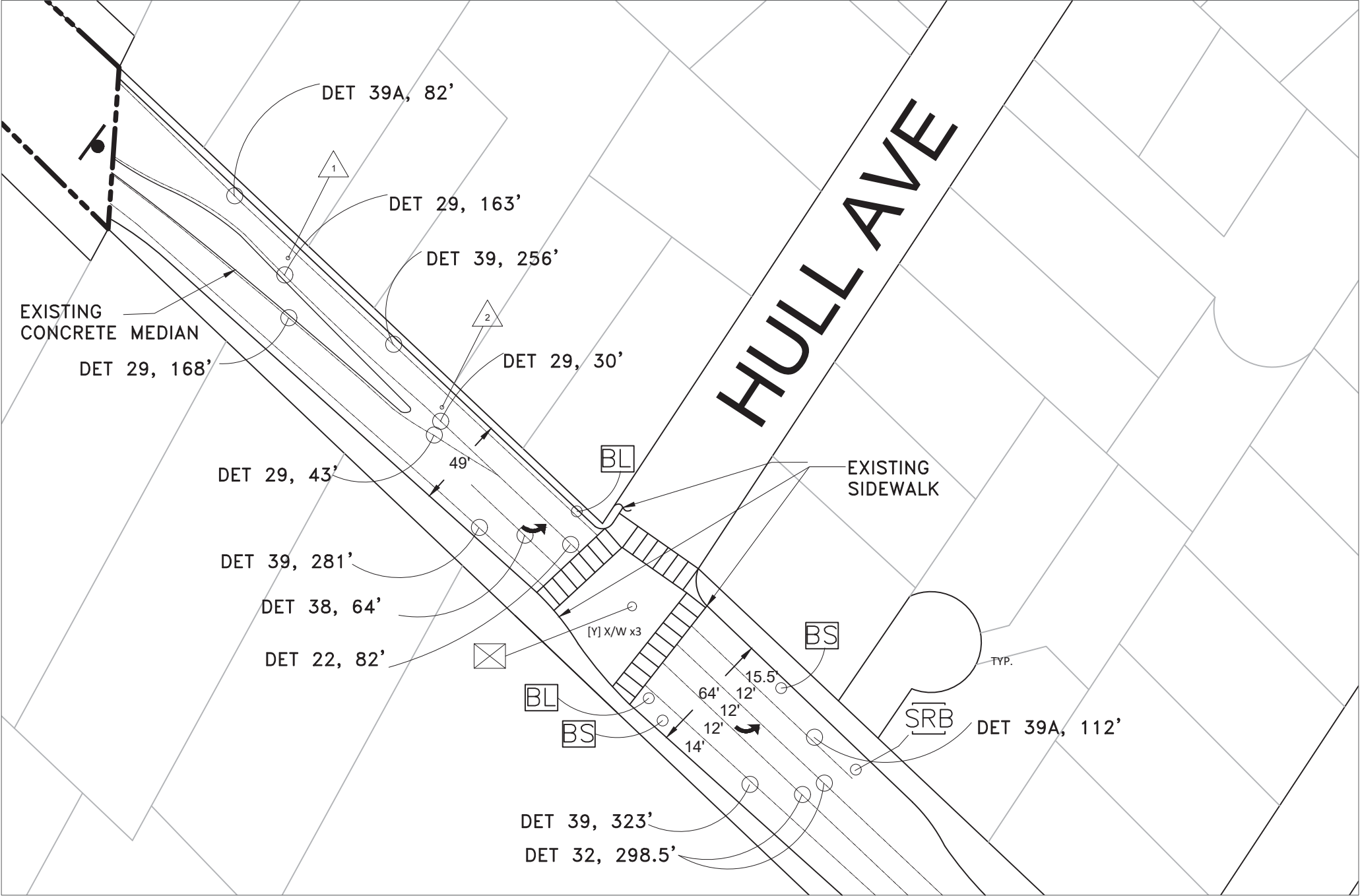

ALAMEDA DE LAS PULGAS & HULL AVE INTERSECTION  
STRIPING DETAIL



APPROVED:  
NOVEMBER 24, 2020  
JAMES C. PORTER, DIRECTOR OF PUBLIC WORKS  
R. C. E. # 48056 / EXPIRES 12-31-2021

LEGEND:

- 990 PROPERTY ADDRESS
- # PAVEMENT REPAIR AREA
- BS "BUS STOP" LEGEND (WHITE), NOTE 3
- BL BIKE LANE/ARROW SYMBOL (WHITE)
- ☒ BLUE FIRE HYDRANT MARKER
- RIGHT-OF-WAY LIMITS
- 12" [SB] STOP BAR
- PROJECT ORANGE ADVISORY SIGN
- ▤ LADDER TYPE CROSSWALK
- ↩ TYPE IV (L) ARROW

NOTES:

- REFER TO SHEET 1 FOR GENERAL NOTES.
- PROJECT ADVISORY SIGN LOCATIONS AND TOTALS ARE APPROXIMATE ONLY AND SHALL BE GOVERNED BY THE COUNTY APPROVED TRAFFIC CONTROL PLAN.



DESIGNED BY: SO	COUNTYWIDE PAVEMENT MAINTENANCE PROJECT  <b>PAVEMENT REPAIR/STRIPING</b>  <b>ALAMEDA DE LAS PULGAS + HULL AVE DETAIL</b>	SCALE: NO SCALE
CHECKED BY: WN		DATE: 11/19/2020
DRAWN BY: SO		FILE NO: 1/4992
JAMES C. PORTER, DIRECTOR OF PUBLIC WORKS SAN MATEO COUNTY		
555 COUNTY CENTER, 5TH FLOOR REDWOOD CITY, CALIFORNIA 94063-1665		19 SHEET 19 OF 25



APPROVED:  
NOVEMBER 24, 2020  
JAMES C. PORTER, DIRECTOR OF PUBLIC WORKS  
R. C. E. # 48056 / EXPIRES 12-31-2021

LEGEND:

- 999 PROPERTY ADDRESS
- # PAVEMENT REPAIR AREA
- BS "BUS STOP" LEGEND (WHITE) (B 23)
- BL BIKE LANE/ARROW SYMBOL (WHITE) (C 22) & (E 22)
- SW "SLOW" LEGEND (YELLOW) (B 23)
- SC "SCHOOL" LEGEND (YELLOW) (B 23)
- X "XING" LEGEND (YELLOW) (B 23)
- Blue Fire Hydrant Marker
- RIGHT-OF-WAY LIMITS
- 12" [SB] STOP BAR
- PROJECT ORANGE ADVISORY SIGN
- LADDER TYPE CROSSWALK (G 22)
- TYPE IV (L) ARROW (J 21)
- GREEN DASHED BIKE LANE (F 22)

NOTES:

- REFER TO SHEET 1 FOR GENERAL NOTES.
- PROJECT ADVISORY SIGN LOCATIONS AND TOTALS ARE APPROXIMATE ONLY AND SHALL BE GOVERNED BY THE COUNTY APPROVED TRAFFIC CONTROL PLAN.

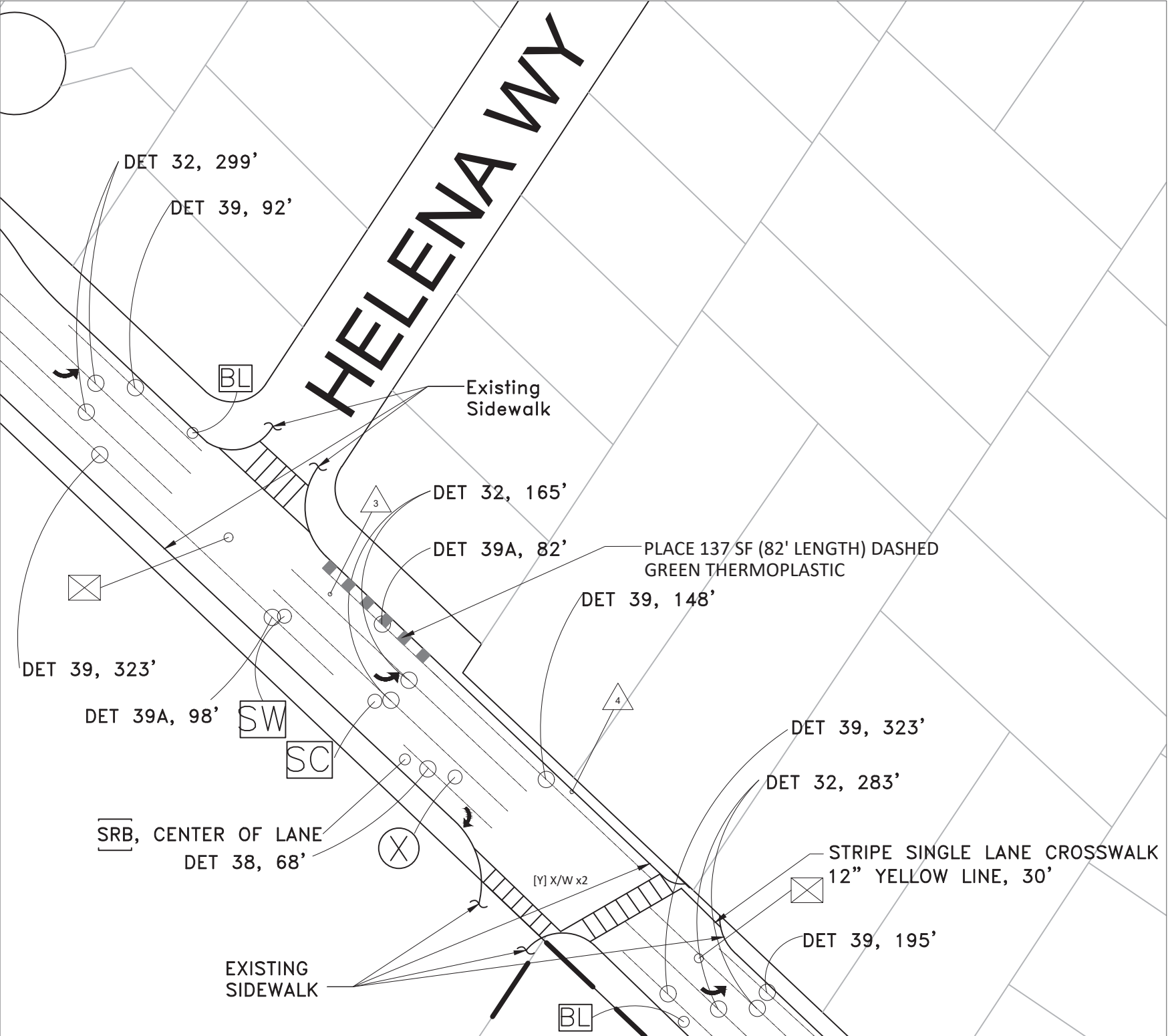

ALAMEDA DE LAS PULGAS & HELENA WAY INTERSECTION  
STRIPING DETAIL

A  
20



DESIGNED BY: SO	COUNTYWIDE PAVEMENT MAINTENANCE PROJECT  <b>PAVEMENT REPAIR/STRIPING</b>  <b>ALAMEDA DE LAS PULGAS + HELENA AVE DETAIL</b>	SCALE: NO SCALE
CHECKED BY: WN		DATE: 11/19/2020
DRAWN BY: SO		FILE NO: <b>1/4992</b>
JAMES C. PORTER, DIRECTOR OF PUBLIC WORKS SAN MATEO COUNTY		555 COUNTY CENTER, 5TH FLOOR REDWOOD CITY, CALIFORNIA 94063-1665
		<b>20</b> SHEET 20 OF 25



## F:\Users\design\C3D\E4992000 Countwide Pavement Maintenance\11 DWG

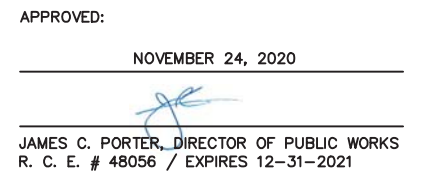

1. REFER TO SHEET 1 FOR GENERAL NOTES.
2. ALL PAVEMENT STRIPING, MARKERS, AND LEGENDS SHOWN ON DWGS ARE APPROX. ONLY. CONTRACTOR SHALL BE HELD FULLY RESPONSIBLE FOR IDENTIFYING AND REPLACING ALL EXISTING PAVEMENT STRIPING, MARKERS, AND LEGENDS WITHIN WORK LIMITS AND/OR AS DIRECTED BY COUNTY ENGINEER.
3. ALL CROSSWALKS BEING REPAVED SHALL INCLUDE LADDER BAR STYLE STRIPING ALONG THE ENTIRE LENGTH OF TRAVEL. SEE SHEET 22 FOR DETAILS.

SHEET 22 OF 25





APPROVED: \_\_\_\_\_  
NOVEMBER 24, 2020  
  
JAMES C. PORTER, DIRECTOR OF PUBLIC WORKS  
R. C. E. # 48056 / EXPIRES 12-31-2021

**NOTES:**

1. REFER TO SHEET 1 FOR GENERAL NOTES.
2. ALL PAVEMENT STRIPING, MARKERS, AND LEGENDS SHOWN ON DWGS ARE APPROX. ONLY. CONTRACTOR SHALL BE HELD FULLY RESPONSIBLE FOR IDENTIFYING AND REPLACING ALL EXISTING PAVEMENT STRIPING, MARKERS, AND LEGENDS WITHIN WORK LIMITS AND/OR AS DIRECTED BY COUNTY ENGINEER.
3. CLASS II BIKE LANE WITH BUFFER STRIPING WILL BE USED IN 5TH AVE. FROM WAVERLY AVE TO SEMICIRCULAR RD. USE 6 FT BIKE LANE WITH 4 FT BUFFER STRIPING. FROM SEMICIRCULAR RD TO SPRING ST, USE 5 FT BIKE LANE WITH 2 FT BUFFER STRIPING. REFER TO CROSS SECTIONS ON SHEET 25.

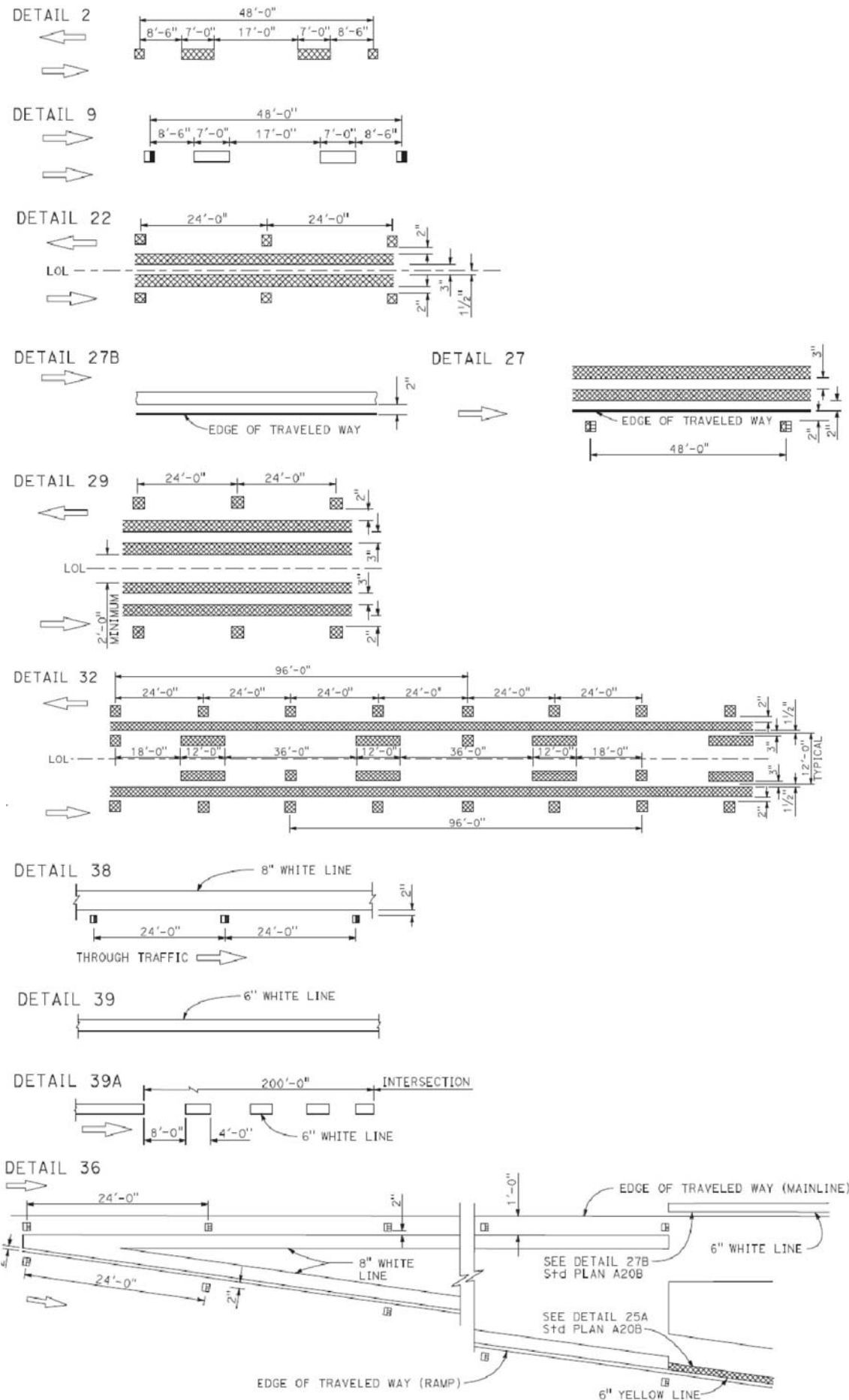

TYP. PAVEMENT MARKERS AND TRAFFIC LINES (A)  
N.T.S. 23

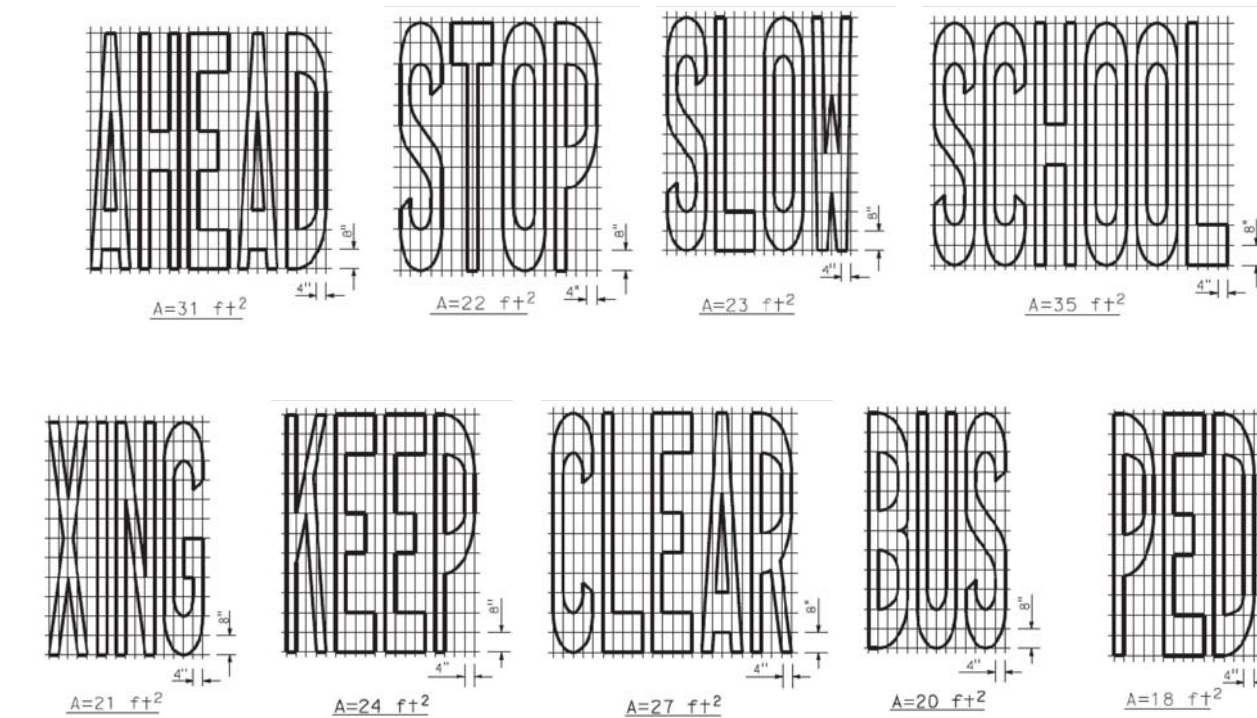

TYP. PAVEMENT MARKINGS WORDS (B)  
N.T.S. 23

- LEGEND**
- MARKERS**
- TYPE C RED-CLEAR RETROREFLECTIVE
  - TYPE D TWO-WAY YELLOW RETROREFLECTIVE
  - TYPE G ONE-WAY CLEAR RETROREFLECTIVE
  - TYPE H ONE-WAY YELLOW RETROREFLECTIVE

- LINES**
- 6" WHITE
  - 6" YELLOW
- TYPE C AND TYPE D** **TYPE G AND TYPE H**
- RETROREFLECTIVE FACE

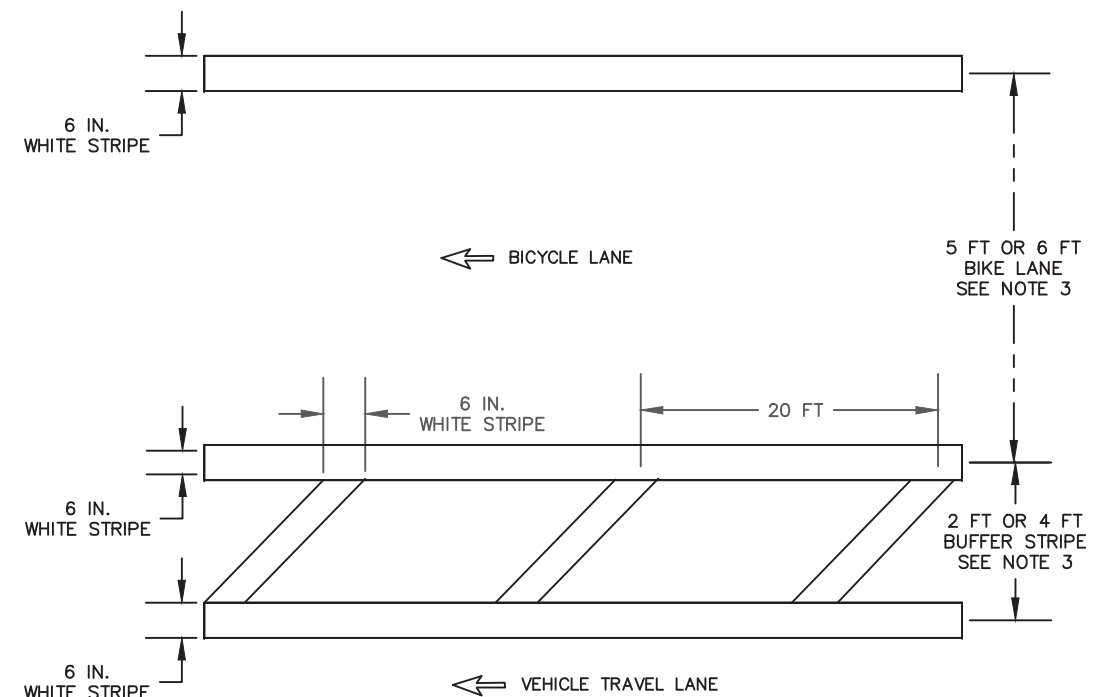

CLASS II BIKE LANE WITH BUFFER (C)  
N.T.S. 23



DESIGNED BY: SO	COUNTYWIDE PAVEMENT MAINTENANCE PROJECT <b>TYPICAL DETAILS - STRIPING (CONTINUED)</b>	SCALE: NO SCALE
CHECKED BY: WN		DATE: 11/19/2020
DRAWN BY: SO		FILE NO: 1/4992
JAMES C. PORTER, DIRECTOR OF PUBLIC WORKS SAN MATEO COUNTY	555 COUNTY CENTER, 5TH FLOOR REDWOOD CITY, CALIFORNIA 94063-1665	23 SHEET 23 OF 25



RAISED TRUNCATED DOME PATTERN (IN-LINE)  
DETECTABLE WARNING SURFACE

RAISED TRUNCATED DOME

TRUNCATED DOME DETAILS

---

N.T.S.

B  
24

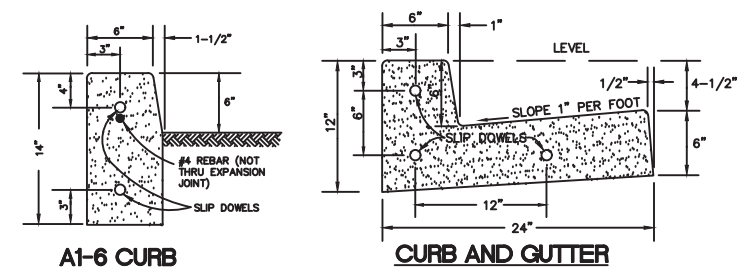

**A1-6 CURB**

**CURB AND GUTTER**

## TYPICAL SECTIONS

NOTES:

1. ALL CONCRETE TO BE CLASS 3 CONCRETE.
2. MINIMUM SIDEWALK THICKNESS = 4 INCHES PCC.
3. PLACE 1/2" DIAMETER X 18" LONG DOWELS AT EXPANSION JOINTS AS SHOWN.
4. PLACE 1/2" THICK EXPANSION JOINTS FULL WIDTH 20' ON CENTER.
5. CONSTRUCT MONOLITHIC CURB, GUTTER AND SIDEWALK UNLESS OTHERWISE SPECIFICALLY AUTHORIZED BY THE DIRECTOR OF PUBLIC WORKS.
6. SUB-BASE MATERIALS WITHIN 30" OF SUBGRADE SHALL BE COMPACTED TO 95%.

TYP. CURB/GUTTER SECTION

N.T.S.

C  
24

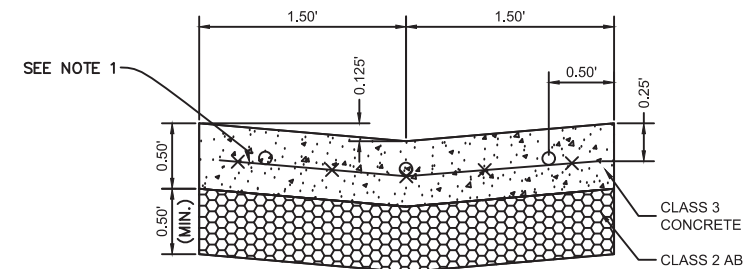

CONCRETE VALLEY GUTTER  
AT NON-STREET INTERSECTION

NOTES:

1. REINFORCEMENT SHALL CONSIST OF 6" x 6" - #10/#10 WELDED WIRE FABRIC.
2. CONCRETE VALLEY, GUTTER AND APRONS SHALL BE INSTALLED PRIOR TO POURING, UNLESS ENGINEER APPROVES OTHERWISE.
3. PLACE 1/2" DIAMETER x 18" LONG DOWELS, AT EXPANSION JOINTS, AS SHOWN, AND AT LOCATIONS WHERE NEW CONCRETE IS ADJACENT TO EXISTING CONCRETE.
4. PLACE 1/4" THICK EXPANSION JOINTS FULL WIDTH 20' ON CENTER. PLACE 1/4" DEEP SCORE AT 10' INTERVALS BETWEEN EXPANSION JOINTS.
5. SUB-BASE MATERIALS WITHIN 30" OF SUBGRADE SHALL BE COMPACTED TO 95% RELATIVE COMPACTION.
6. APRONS SHALL BE POURED MONOLITHIC WITH ADJACENT CURB AND GUTTER.

CONCRETE VALLEY GUTTER  
N.T.S.

CONCRETE VALLEY GUTTER (D  
N.T.S. 24



NOVEMBER 24, 2020

JAMES C. PORTER, DIRECTOR OF PUBLIC WORKS  
R. C. E. # 48056 / EXPIRES 12-31-2021

**NOTES:**

1. REFER TO SHEET 1 FOR GENERAL NOTES.

**ADDITIONAL NOTES:**

- REVISIONS**
- REMARKS**
- ADDITIONAL NOTES:**
1. AS SITE CONDITIONS DICTATE, CASE C CURB RAMPS MAY BE USED FOR CORNER INSTALLATIONS AND AT MID-BLOCK LOCATIONS.
  2. IF LOCATED ON A CURVE, THE SIDES OF THE RAMP NEED NOT BE PARALLEL, BUT THE MINIMUM WIDTH OF THE RAMP SHALL BE 4'-2".
  3. TRANSITIONS FROM RAMPS AND LANDING TO WALKS, GUTTERS OR STREETS SHALL BE FLUSH AND FREE OF ABRUPT CHANGES. THE BOTTOM OF THE RAMP SHALL HAVE NO LIP AND CONFORM TO THE GUTTER FLOWLINE.
  4. CURB RAMPS SHALL HAVE A DETECTABLE WARNING SURFACE THAT EXTENDS THE FULL WIDTH AND 3'-0" DEPTH OF THE RAMP. DETECTABLE WARNING SURFACES SHALL BE YELLOW OR GRAY COLOR AS REFER TO ASSOCIATED ADA RAMP TABLES, AND CONFORM TO THE DETAILS ON THIS PLAN, THE REQUIREMENTS OF THE SPECIAL PROVISIONS AND THE DIRECTIONS OF THE ENGINEER.
  5. THE EDGE OF THE DETECTABLE WARNING SURFACE NEAREST THE STREET SHALL BE BETWEEN 6" AND 8" FROM THE GUTTER FLOWLINE.
  6. RECONSTRUCT SIDEWALK TO NEAREST SCORE LINE AND INSTALL EXPANSION JOINT, UNLESS OTHERWISE DIRECTED BY THE ENGINEER.
  7. UNLESS OTHERWISE SHOWN ON THE PLANS OR DIRECTED BY THE ENGINEER, IN WRITING, UTILITY PULL BOXES, MANHOLES, VALVE BOXES AND ALL OTHER FACILITIES WITHIN THE BOUNDARIES OF THE CURB RAMP SHALL BE ADJUSTED BY THE CONTRACTOR.
  8. **ADDITIONAL NOTES:**
    - (a) TYPICAL FIXED OBJECTS INCLUDE BUT ARE NOT LIMITED TO THE FOLLOWING:
      - TRAFFIC SIGNAL POLE
      - UTILITY POLE
      - PULL BOXES
      - PHONE OR UTILITY BOXES
      - CATCH BASINS
    - (b) RELATIVE COMPACTION OF NOT LESS THAN 95% SHALL BE OBTAINED FOR MINIMUM DEPTH OF 2.5 FEET BELOW FINISH GRADE.
    - (c) A 5'-6" WIDTH FROM FACE OF CURB TO BACK OF SIDEWALK IS THE COUNTY STANDARD WIDTH FOR SIDEWALKS AND ACCESS RAMPS, WITH A PREFERRED MINIMUM CLEAR SIDEWALK WIDTH OF 48" FROM BACK OF CURB TO BACK OF SIDEWALK. IF A CLEAR SIDEWALK WIDTH OF 48" IS NOT POSSIBLE TO CONSTRUCT DUE TO NATURAL BARRIERS AND OTHER EXISTING CONDITIONS, THE CLEAR SIDEWALK WIDTH MAY BE REDUCED TO 36", AS STIPULATED BY TITLE 28 CODE OF FEDERAL REGULATIONS (CRF), PART 36: ADA (AMERICANS WITH DISABILITIES ACT) STANDARDS FOR ACCESSIBLE DESIGN.
    - (d) RECONSTRUCT SIDEWALK TO NEAREST EXPANSION JOINT OR, AS APPROVED BY THE ENGINEER IN WRITING, TO THE NEAREST SCORE LINE AND INSTALL EXPANSION JOINT.
    - (e) INSTALL SLIP DOWELS 18" O.C. AT EXPANSION JOINTS.
    - (f) CONSTRUCT MONOLITHIC CURB, GUTTER, AND SIDEWALK.
    - (g) SCORE SIDEWALK AREA WITH 1/4" SCORING ON BASIS OF 2.5' SQUARES (CRACK CONTROL JOINTS), OR AS DETERMINED BY THE ENGINEER.
    - (h) BACKFILL MATERIAL TO BE REPLACED IN KIND AND FLUSH WITH TOP OF CURB, OR AS DIRECTED BY THE ENGINEER.
    - (i) 4' WIDTH MINIMUM CLEARANCE FOR PEDESTRIAN PATH OF TRAVEL SHALL BE MAINTAINED FROM WITHIN THE PROPOSED CROSSWALK.

## CONCRETE CURB, GUTTER AND SIDEWALK



DESIGNED BY: SO

CHECKED BY: WN

DRAWN BY: SO

COUNTYWIDE PAVEMENT MAINTENANCE PROJECT  
TYPICAL DETAILS - ADA RAMPS + CONCRETE

JAMES C. PORTER, DIRECTOR OF PUBLIC WORKS  
SAN MATEO COUNTY

555 COUNTY CENTER, 5TH FLOOR  
REDWOOD CITY, CALIFORNIA 94063-1665

SCALE: NO SCALE

DATE: 11/19/2020

FILE NO: 1/4992

---

24

SHEET 24 OF 25





APPROVED:  
NOVEMBER 24, 2020

- NOTES:**
1. REFER TO SHEET 1 FOR GENERAL NOTES.
2. ALL ROAD CONSTRUCTION LIMITS SHALL BE DETERMINED BY LIP OF GUTTER TO LIP OF GUTTER UNLESS ROW LIMITS OR AS DIRECTED BY THE ENGINEER.
3. EDGE OF PAVEMENT IS EITHER AT THE LIP OF GUTTER, TOP OF AN UNLINED DRAINAGE DITCH AT THE EDGE OF UNIMPROVED SHOULDER AREAS OR AT ONE FOOT MINIMUM CLEARANCE FROM FACE OF DIKE.
4. ALL PAVEMENT STRIPING, MARKERS, AND LEGENDS SHOWN ON DWGS ARE APPROX. ONLY. CONTRACTOR SHALL BE HELD FULLY RESPONSIBLE FOR IDENTIFYING AND REPLACING ALL EXISTING PAVEMENT STRIPING, MARKERS, AND LEGENDS WITHIN WORK LIMITS AND/OR AS DIRECTED BY THE ENGINEER.
5. ALL CROSSWALKS BEING REPLACED SHALL INCLUDE LADDER BAR STYLE STRIPING ALONG THE ENTIRE LENGTH OF TRAVEL UNLESS NOTED ON PLANS OR AS DIRECTED BY THE ENGINEER.
6. MOUNTING AND SIGNAGE SPECIFICATION DETAILS TO BE SUBMITTED FOR ENGINEER APPROVAL PRIOR TO CONSTRUCTION.
7. STRIPING AND INFRASTRUCTURE WIDTH WILL VARY, CONTRACTOR SHALL FIELD VERIFY AND RECEIVE CONFIRMATION AS DIRECTED BY THE ENGINEER PRIOR TO CONSTRUCTION.

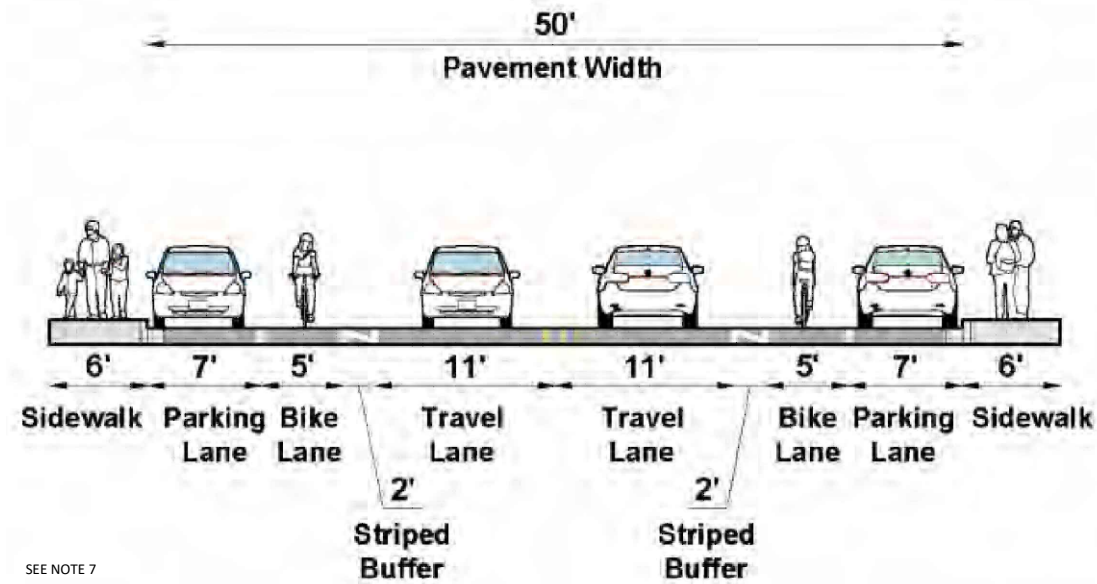

TYP. CROSS SECTION AT FIFTH AVE  
SEMICIRCULAR RD TO SPRING ST N.T.S. **A**  
25

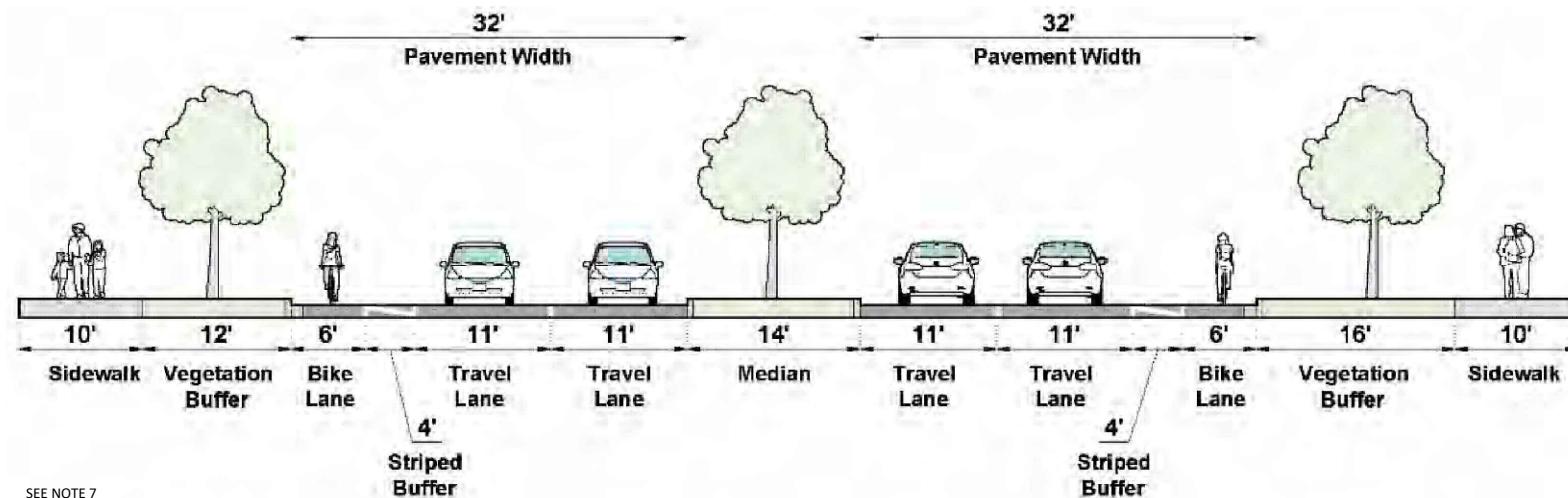

TYP. CROSS SECTION AT FIFTH AVE  
WAVERLY AVE TO SEMICIRCULAR RD N.T.S. **B**  
25

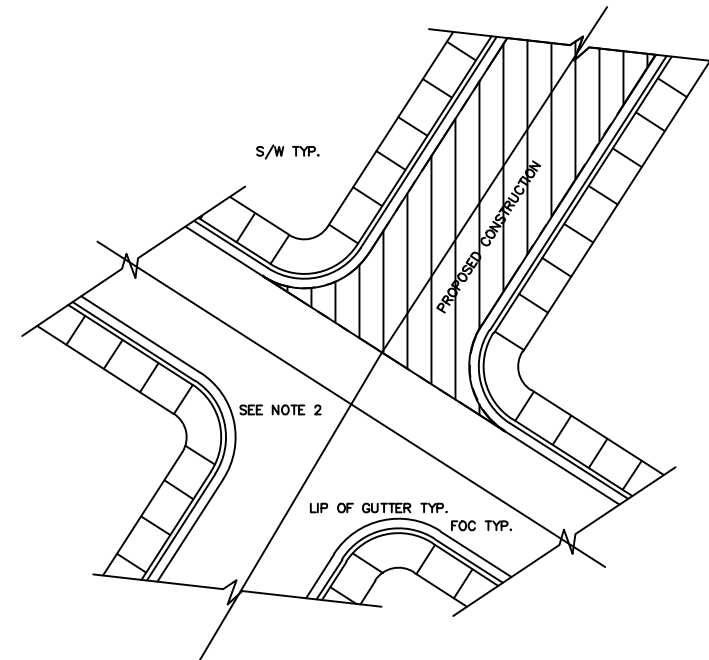

TYPICAL LIMITS FOR TYP. SURFACE SEAL N.T.S. **C**  
25

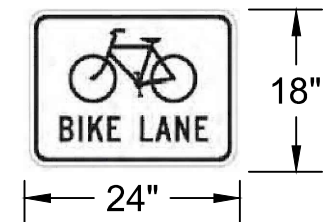
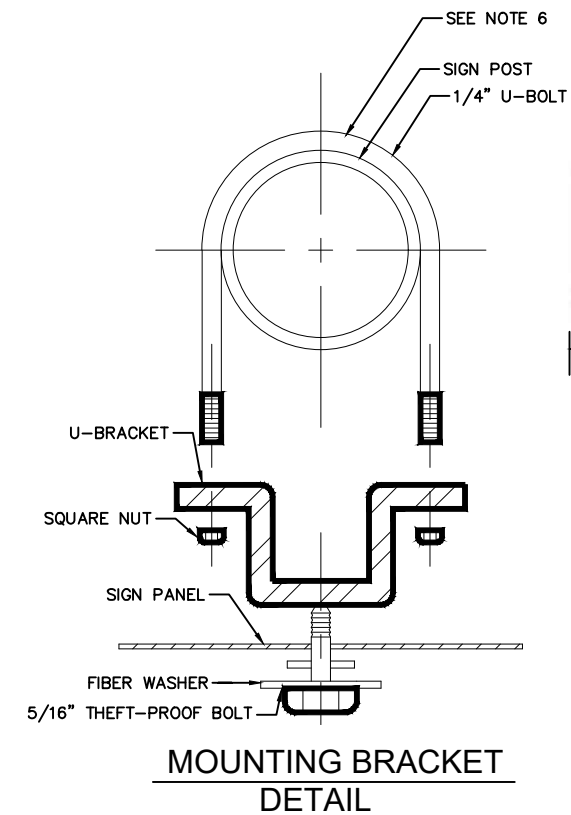

R81 (CA) SIGN  
SEE NOTE 6

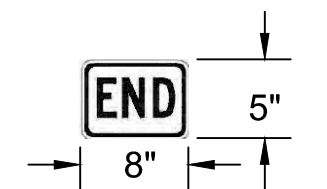

R81B (CA) SIGN  
SEE NOTE 6

SIGNAGE DETAIL N.T.S. **D**  
25



DESIGNED BY: SO  
CHECKED BY: WN  
DRAWN BY: SO

COUNTYWIDE PAVEMENT MAINTENANCE PROJECT  
**TYPICAL DETAILS - MISC.**

JAMES C. PORTER, DIRECTOR OF PUBLIC WORKS  
SAN MATEO COUNTY

555 COUNTY CENTER, 5TH FLOOR  
REDWOOD CITY, CALIFORNIA 94063-1665

SCALE: NO SCALE  
DATE: 11/19/2020  
FILE NO: 1/4992  
**25**  
SHEET 25 OF 25