

**DEPARTMENT OF FORESTRY AND FIRE PROTECTION****San Mateo – Santa Cruz Unit**

6059 Highway 9
Felton, CA 95018
(831) 335-5353
Website: www.fire.ca.gov



Dear Neighbor,

CAL FIRE CZU would like to conduct a fuel reduction project adjacent to your property on San Bruno Mountain State & County Park. Our proposed project would remove and chip dead and down trees, remove some live trees less than 17 inches in diameter at breast height, limb existing trees to a height of up to six feet and trim brush and other ladder fuels to slow the spread of wildfire to your neighborhood. We would like to complement the work recently completed by San Mateo County Parks in the area. Fuel reduction work will be completed by hand but will use a chipper to dispose of woody debris.

This hazardous fuel reduction work will be completed under the San Mateo County Parks Routine Maintenance Program Environmental Impact Report (2020) and in accordance with the San Bruno Habitat Conservation Plan. This project is also identified in the San Mateo County Parks Wildfire Mitigation Plan. You'll find more details on this project by accessing the following link or QR code:

 <https://www.smcgov.org/parks/news/sbm-saddle-fuel-reduction>

At this time, we do not have permission to work within the Daly City Parcel, however we would like to continue this work in that area as identified on the attached map if possible.

Fuel reduction work is critical to changing fire behavior, safeguarding lives and property, and restoring California's ecosystems to be more resilient against catastrophic wildfire



If you would like to speak with someone regarding this project please contact, myself, Forester Sarah Collamer at (831) 335-6743 or sarah.collamer@fire.ca.gov.

Thank you for your attention to this matter and for making California more fire safe.

Sincerely,

Sarah A. Collamer
RPF #2983

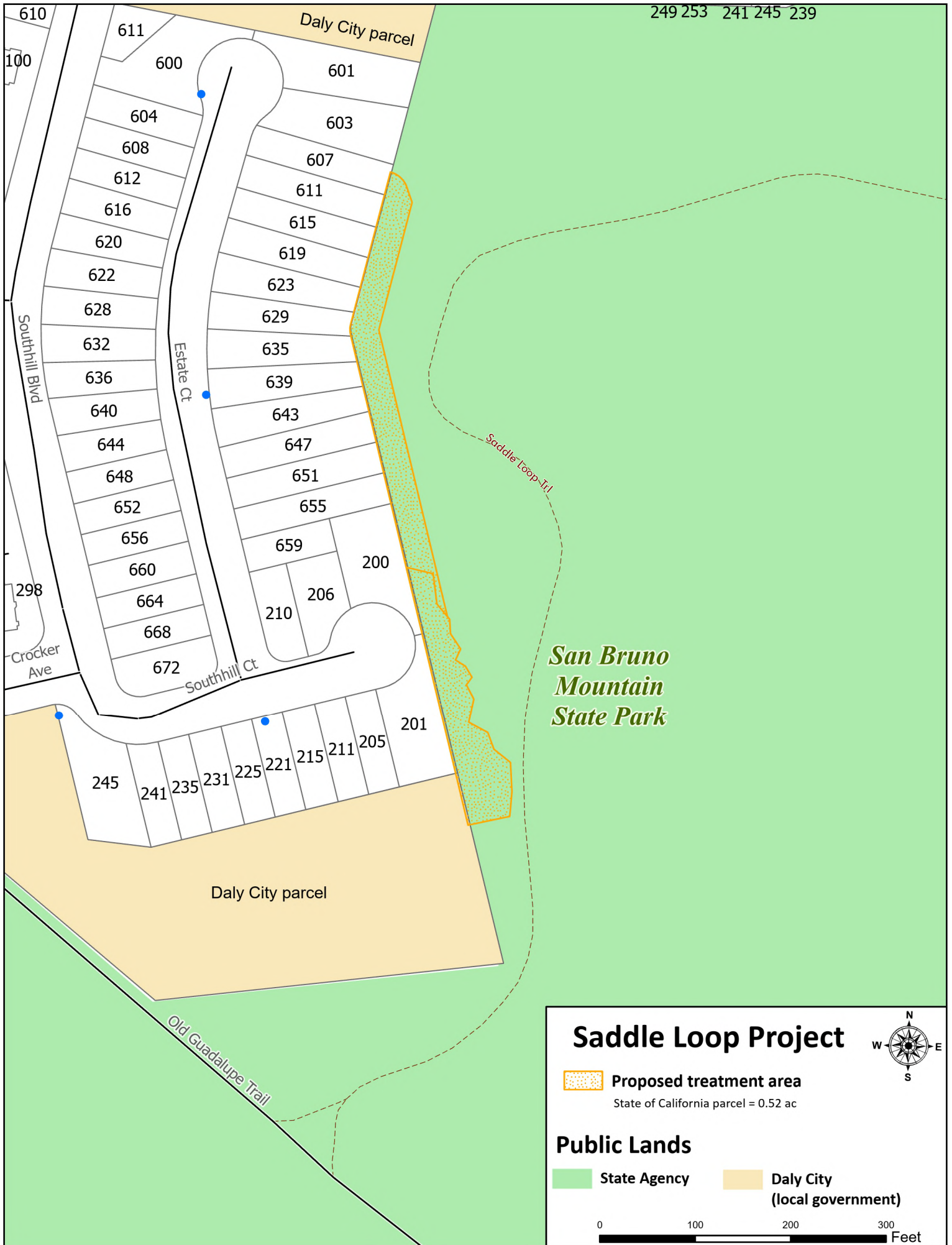

Saddle Loop Project

Proposed treatment area
State of California parcel = 0.52 ac

Public Lands

State Agency	Daly City (local government)
---------------------	-------------------------------------

0 100 200 300
Feet