

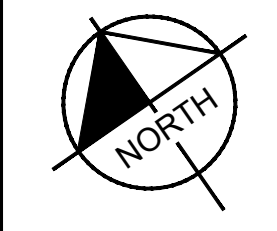

APPROVED: _____
 DATE: APRIL 19, 2024
 ANN MADER STILLMAN,
 DIRECTOR OF PUBLIC WORKS
 R. C. E. # 47882

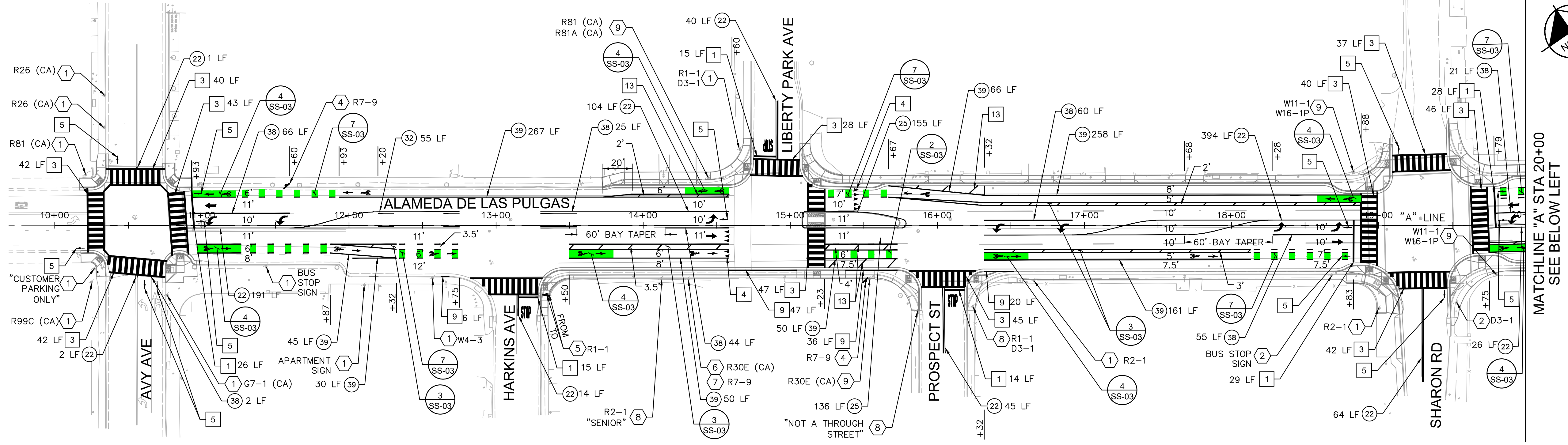

MATCHLINE "A" STA 20+00
 SEE BELOW LEFT

NOTES

- EXISTING SIGNS SHALL BE PROTECTED IN PLACE UNLESS SPECIFIED FOR REMOVAL OR RELOCATION, OR SPECIFIED TO BE RESET PER PV AND CD SHEETS.
- EXISTING SIGNS SPECIFIED FOR REMOVAL SHALL NOT BE REMOVED UNTIL NO LONGER PERTINENT TO TRAFFIC CONTROL.
- DO NOT REMOVE UTILITY LOCATION MARKERS UNLESS OTHERWISE SHOWN ON PV OR CD SHEETS.
- ALL STRIPING CONFLICTING WITH PROPOSED STRIPING SHALL BE REMOVED BY GRINDING.
- PAVEMENT MARKINGS PER 2018 CALTRANS STANDARD PLANS UNLESS OTHERWISE SPECIFIED.
- PAVEMENT DELINEATION SHALL BE THERMOPLASTIC UNLESS SHOWN OTHERWISE.
- CONTRACTOR SHALL PROTECT IN PLACE ALL EXISTING PAINT OR THERMOPLASTIC OUTSIDE OF PROJECT LIMITS, OR LIMITS OF PROPOSED STRIPING AS SHOWN ON STRIPING SHEETS.
- UNLESS OTHERWISE NOTED PER THESE PLANS, LANE WIDTHS ARE TO CENTER OF STRIPE OR FACE OF CURB.
- UNLESS OTHERWISE NOTED PER THESE PLANS, ALL EXISTING UTILITIES TO REMAIN.
- BAY TAPER PER 7TH EDITION OF THE CALTRANS HIGHWAY DESIGN MANUAL, TABLE 405.2A.

LEGEND

- EXISTING SIGN
- PROPOSED SIGN
- CHANNELIZER

STRIPING NOTES

- INSTALL LIMIT LINE PER CALTRANS STD PLAN A24E.
- INSTALL 10' WIDE LADDER CROSSWALK PER CALTRANS STD PLAN A24F WITH WET RATED REFLECTIVE BEADS.
- INSTALL YIELD LINE PER CALTRANS STD PLAN A24E.
- INSTALL BICYCLE LOOP DETECTOR SYMBOL PER CALTRANS STD PLAN A24C.
- INSTALL 6", 45° WHITE THERMOPLASTIC STRIPE AT 5' O/C.
- INSTALL RED CURB WITH 2 COAT PAINT. LENGTH AS SHOWN PER PLAN, MEASURED FROM BC/EC OF CURB RETURN TO PARKING STALL LIMIT AS SHOWN.
- INSTALL 6", 45° WHITE THERMOPLASTIC STRIPE AT 20' O/C.
- INSTALL CALTRANS STRIPING DETAIL "XX" PER CALTRANS STANDARD PLANS.

SIGNING NOTES

- EXISTING SIGN TO REMAIN.
- RELOCATE EXISTING SIGN AND POST 1' BACK FROM PROPOSED FACE OF CURB.
- INSTALL NEW SIGN AND POST.
- RELOCATE EXISTING SIGN AND POST AS SHOWN ON PLANS.
- REMOVE EXISTING SIGN PANEL. POST TO REMAIN.
- INSTALL NEW SIGN ON EXISTING POST.
- RESET.
- REMOVE AND SALVAGE EXISTING SIGN AND POST.

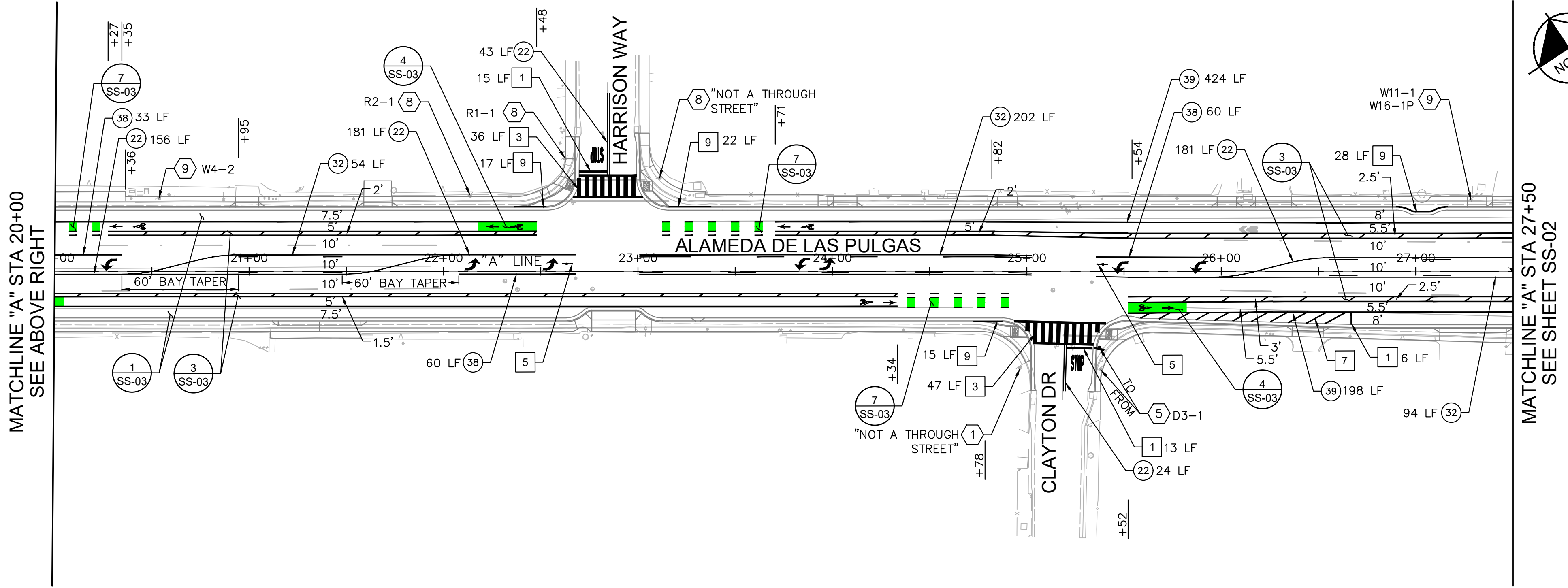

MATCHLINE "A" STA 20+00
 SEE ABOVE RIGHT

MATCHLINE "A" STA 27+50
 SEE SHEET SS-02

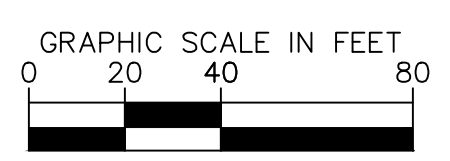

APPROVED DATE: APRIL 19, 2024
 SIGNATURE: *[Signature]*
 JOHN PULLIAM
 KIMLEY-HORN
 R.C.E. # 68897 / EXPIRES 09-30-2025

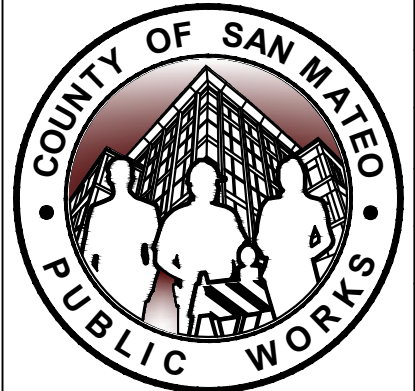

DESIGNED BY: CH/ASP /HW	SANTA CRUZ AVENUE/ALAMEDA DE LAS PULGAS COMPLETE STREET PROJECT FROM AVY AVENUE TO SAND HILL ROAD	SCALE: AS SHOWN
CHECKED BY: JP	SIGNING AND STRIPING PLAN	DATE: 04/19/2024
DRAWN BY: SD/KS		FILE NO.: E5043
ANN MADER STILLMAN, DIRECTOR OF PUBLIC WORKS COUNTY OF SAN MATEO	555 COUNTY CENTER, 5th FLOOR REDWOOD CITY, CALIFORNIA 94063	SS-01 SHEET 55 OF 68
REVISION	DATE	FOR REDUCED PLANS ORIGINAL SCALE IS IN INCHES

FILENAME: K:\BAY_ROW\097889107 - SANTA CRUZ AVE - JP\08 CADD\PLANSHEETS\SS-01.DWG (SS-01)



APPROVED: _____
 DATE: APRIL 19, 2024
 ANN MADER STILLMAN,
 DIRECTOR OF PUBLIC WORKS
 R. C. E. # 47882

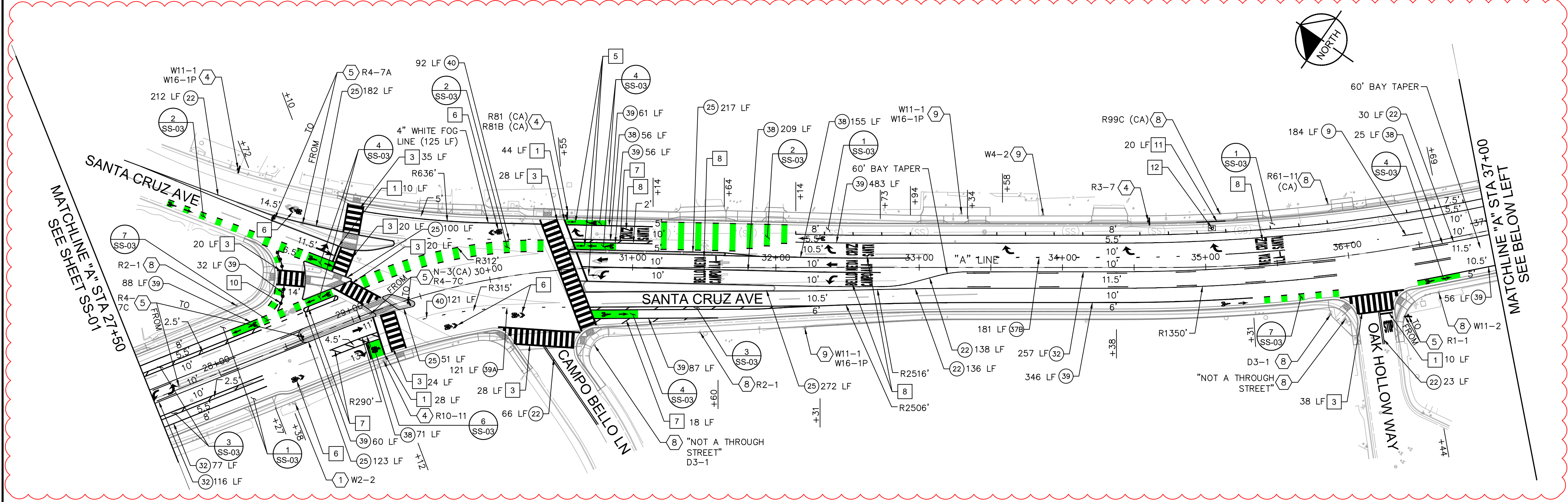

NOTES

- EXISTING SIGNS SHALL BE PROTECTED IN PLACE UNLESS SPECIFIED FOR REMOVAL OR RELOCATION, OR SPECIFIED TO BE RESET PER PV AND CD SHEETS.
- EXISTING SIGNS SPECIFIED FOR REMOVAL SHALL NOT BE REMOVED UNTIL NO LONGER PERTINENT TO TRAFFIC CONTROL.
- DO NOT REMOVE UTILITY LOCATION MARKERS UNLESS OTHERWISE SHOWN ON PV OR CD SHEETS.
- ALL STRIPING CONFLICTING WITH PROPOSED STRIPING SHALL BE REMOVED BY GRINDING.
- PAVEMENT MARKINGS PER 2018 CALTRANS STANDARD PLANS UNLESS OTHERWISE SPECIFIED.
- PAVEMENT DELINEATION SHALL BE THERMOPLASTIC UNLESS SHOWN OTHERWISE.
- CONTRACTOR SHALL PROTECT IN PLACE ALL EXISTING PAINT OR THERMOPLASTIC OUTSIDE OF PROJECT LIMITS, OR LIMITS OF PROPOSED STRIPING AS SHOWN ON STRIPING SHEETS.
- UNLESS OTHERWISE NOTED PER THESE PLANS, LANE WIDTHS ARE TO CENTER OF STRIPE OR FACE OF CURB.
- UNLESS OTHERWISE NOTED PER THESE PLANS, ALL EXISTING UTILITIES TO REMAIN.
- BAY TAPER PER 7TH EDITION OF THE CALTRANS HIGHWAY DESIGN MANUAL, TABLE 405.2A.

LEGEND

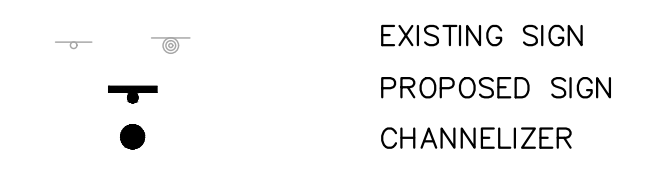

STRIPING NOTES

- INSTALL LIMIT LINE PER CALTRANS STD PLAN A24E.
- INSTALL 10' WIDE LADDER CROSSWALK PER CALTRANS STD PLAN A24F WITH WET RATED REFLECTIVE BEADS.
- INSTALL YIELD LINE PER CALTRANS STD PLAN A24E.
- INSTALL BICYCLE LOOP DETECTOR SYMBOL PER CALTRANS STD PLAN A24C.
- INSTALL SHARROW MARKING PER CALTRANS STD PLAN A24C.
- INSTALL 6", 45' WHITE THERMOPLASTIC STRIPE AT 5' O/C.
- INSTALL CUSTOM PAVEMENT MARKING PER DETAIL 5, SHEET SS-03.
- INSTALL RED CURB WITH 2 COAT PAINT. LENGTH AS SHOWN PER PLAN, MEASURED FROM BC/EC OF CURB RETURN TO PARKING STALL LIMIT AS SHOWN.
- INSTALL CHANNELIZER (5' O/C, 6 TOTAL).
- INSTALL BLUE CURB WITH 2 COAT PAINT. LENGTH AS SHOWN PER PLAN.
- MAINTAIN 1 EXISTING ADA PARKING STALL. INSTALL ISA MARKING PER CALTRANS STD DETAIL A24C WITH BLUE BACKING.
- INSTALL CALTRANS STRIPING DETAIL "XX" PER CALTRANS STANDARD PLANS.

SIGNING NOTES

- EXISTING SIGN TO REMAIN.
- RELOCATE EXISTING SIGN AND POST 1' BACK FROM PROPOSED FACE OF CURB.
- INSTALL NEW SIGN AND POST.
- RELOCATE EXISTING SIGN AND POST AS SHOWN ON PLANS.
- REMOVE EXISTING SIGN PANEL. POST TO REMAIN.
- INSTALL NEW SIGN ON EXISTING POST.
- RESET.
- REMOVE AND SALVAGE EXISTING SIGN AND POST.
- REMOVE EXISTING SIGN PANEL. RESET EXISTING POST.

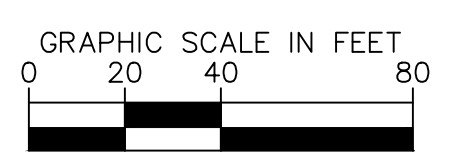
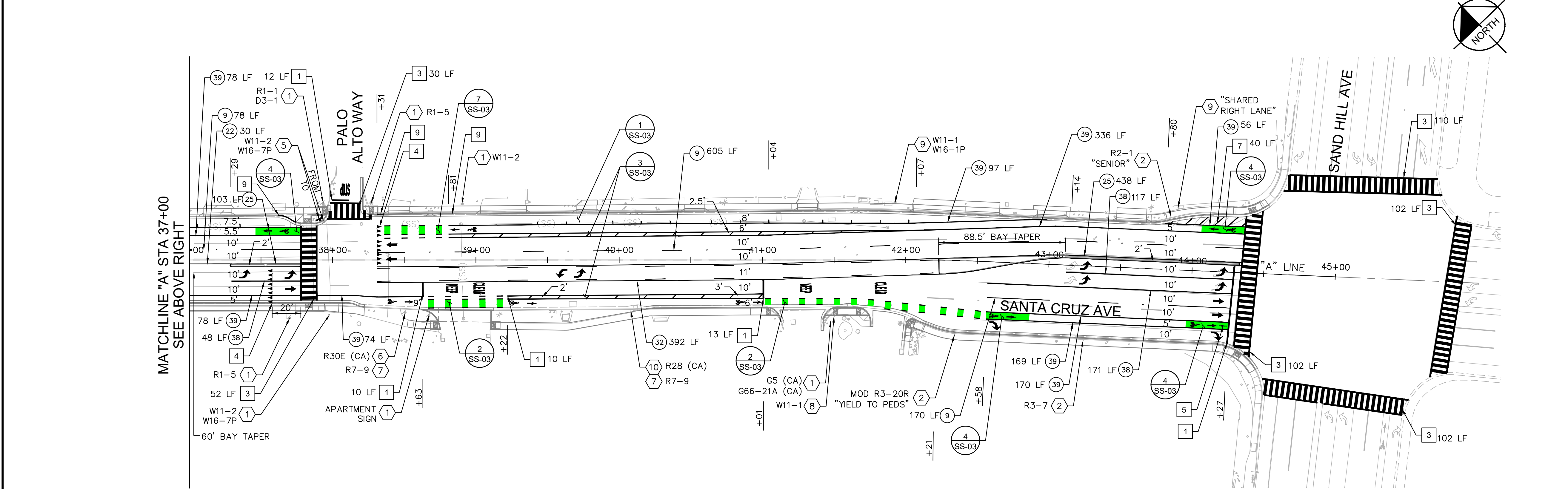

APPROVED DATE: APRIL 19, 2024

SIGNATURE: *[Signature]*
 JOHN PULLIAM
 KIMLEY-HORN
 R.C.E. # 68897 / EXPIRES 09-30-2025

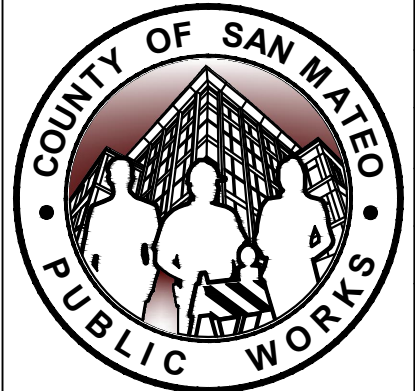

DESIGNED BY: CH/ASP / HW	05/06/2024
CHECKED BY: JP	
DRAWN BY: SD/KS	
REVISION	DATE

SANTA CRUZ AVENUE/ALAMEDA DE LAS PULGAS COMPLETE STREET PROJECT FROM AVY AVENUE TO SAND HILL ROAD		SCALE: AS SHOWN
SIGNING AND STRIPING PLAN		DATE: 04/19/2024
ANN MADER STILLMAN, DIRECTOR OF PUBLIC WORKS COUNTY OF SAN MATEO		FILE NO.: E5043
555 COUNTY CENTER, 5th FLOOR REDWOOD CITY, CALIFORNIA 94063		SS-02(rev) SHEET 56 OF 68

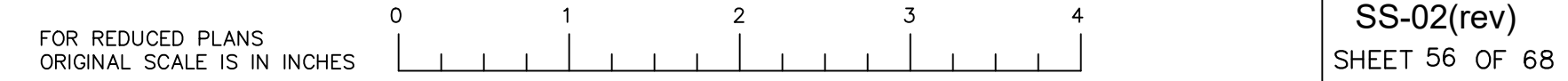

FILENAME: K:\BAY_ROW\097889107 - SANTA CRUZ AVE - JP\08_CADD\PLANS\SS-01.DWG (SS-02)



APPROVED: _____
 DATE: APRIL 19, 2024
 ANN MADER STILLMAN,
 DIRECTOR OF PUBLIC WORKS
 R. C. E. # 47882

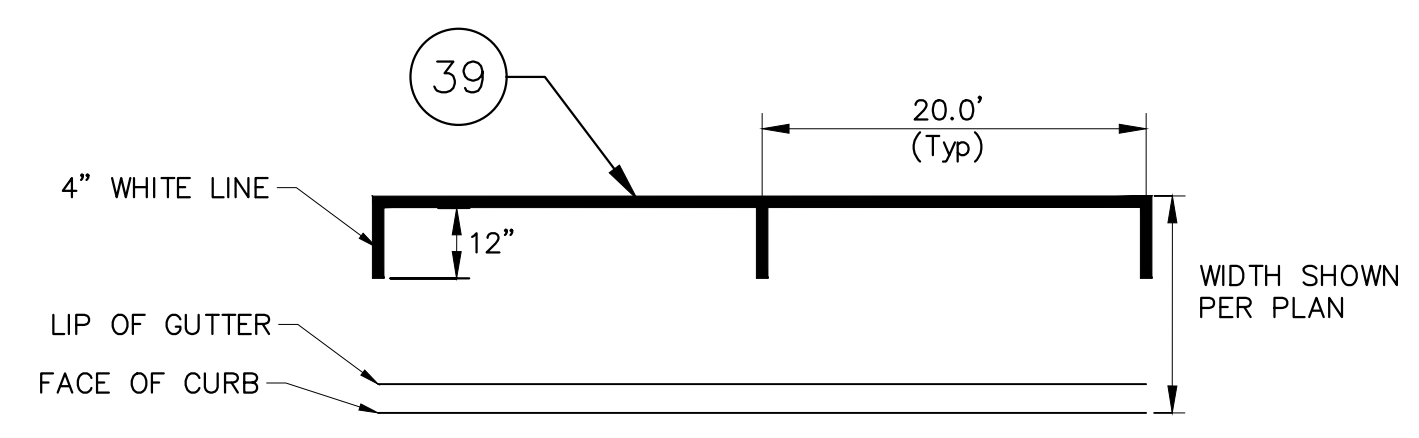

PARKING STALL DETAIL
 N.T.S. 1
SS-03

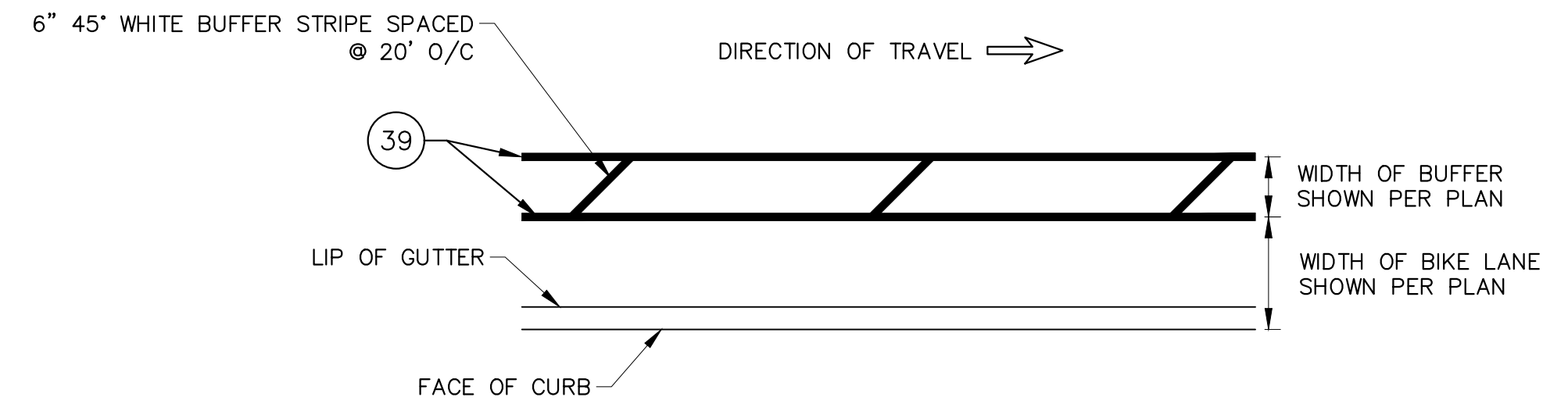

CLASS II BUFFERED BIKE LANE DETAIL
 N.T.S. 3
SS-03

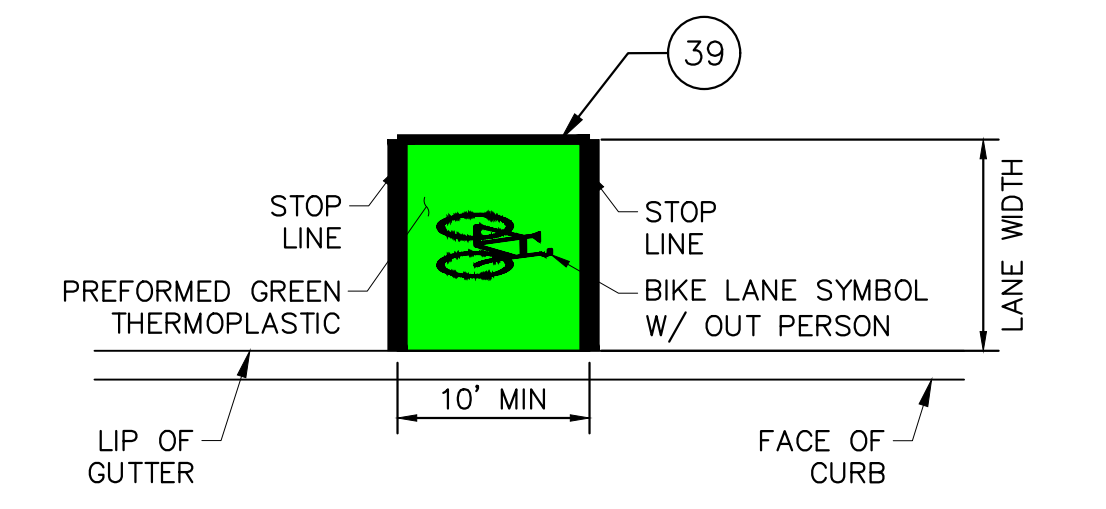

BIKE BOX
 N.T.S. 6
SS-03

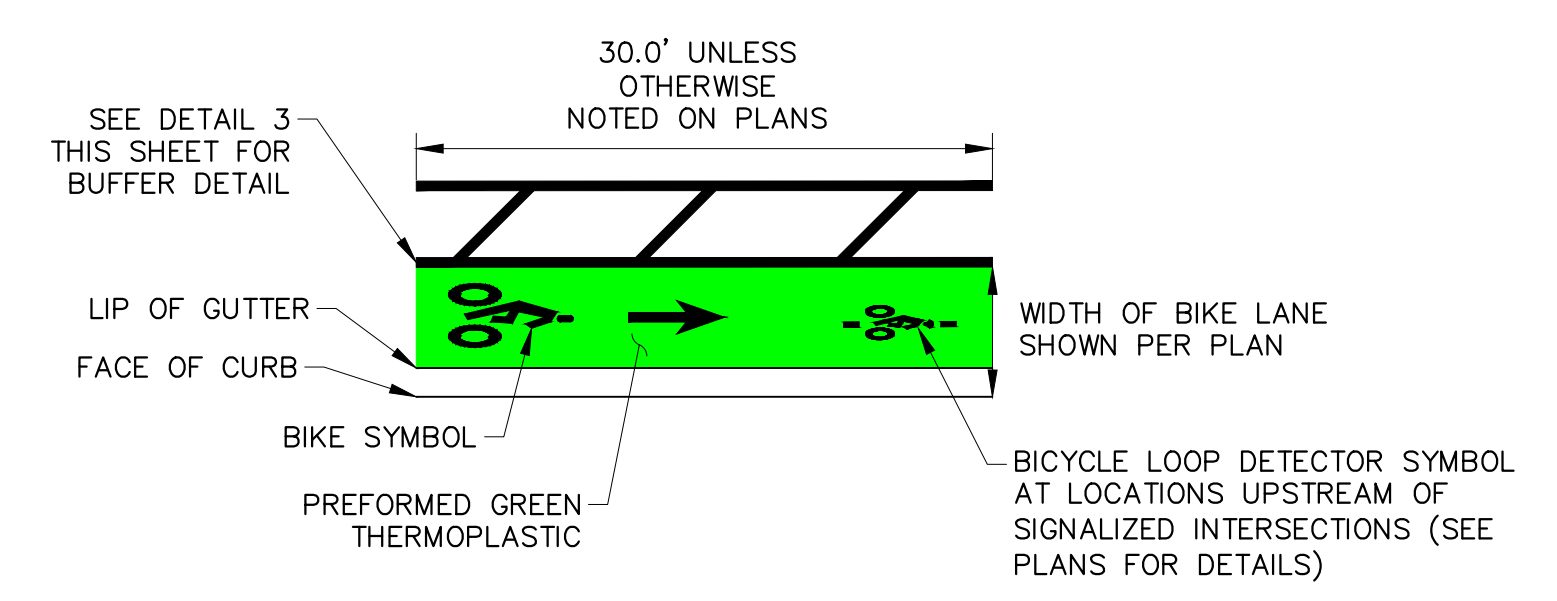

BIKE LEGEND WITH GREEN BACK DETAIL
 N.T.S. 4
SS-03

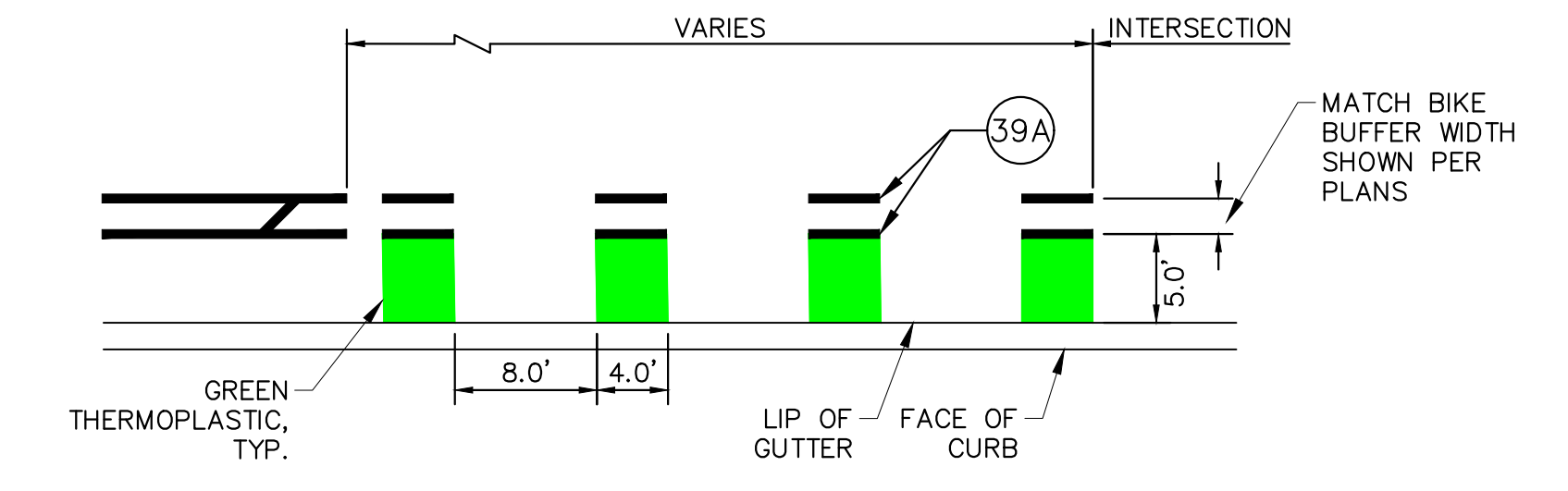

CLASS II GREEN THERMOPLASTIC DASHED BIKE LANE
 N.T.S. 7
SS-03

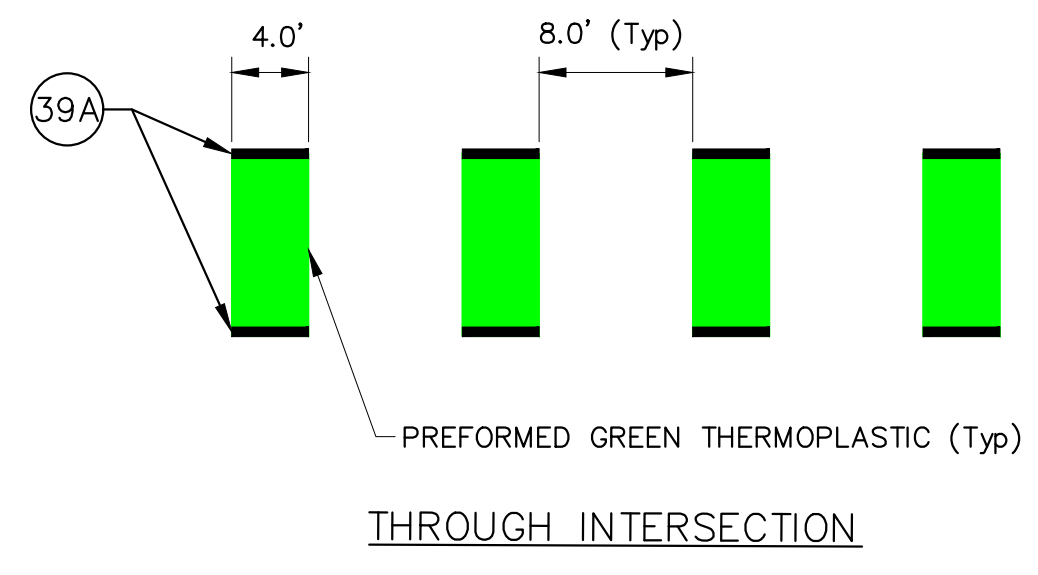

GREEN BIKE CONFLICT ZONE DETAIL
 N.T.S. 2
SS-03

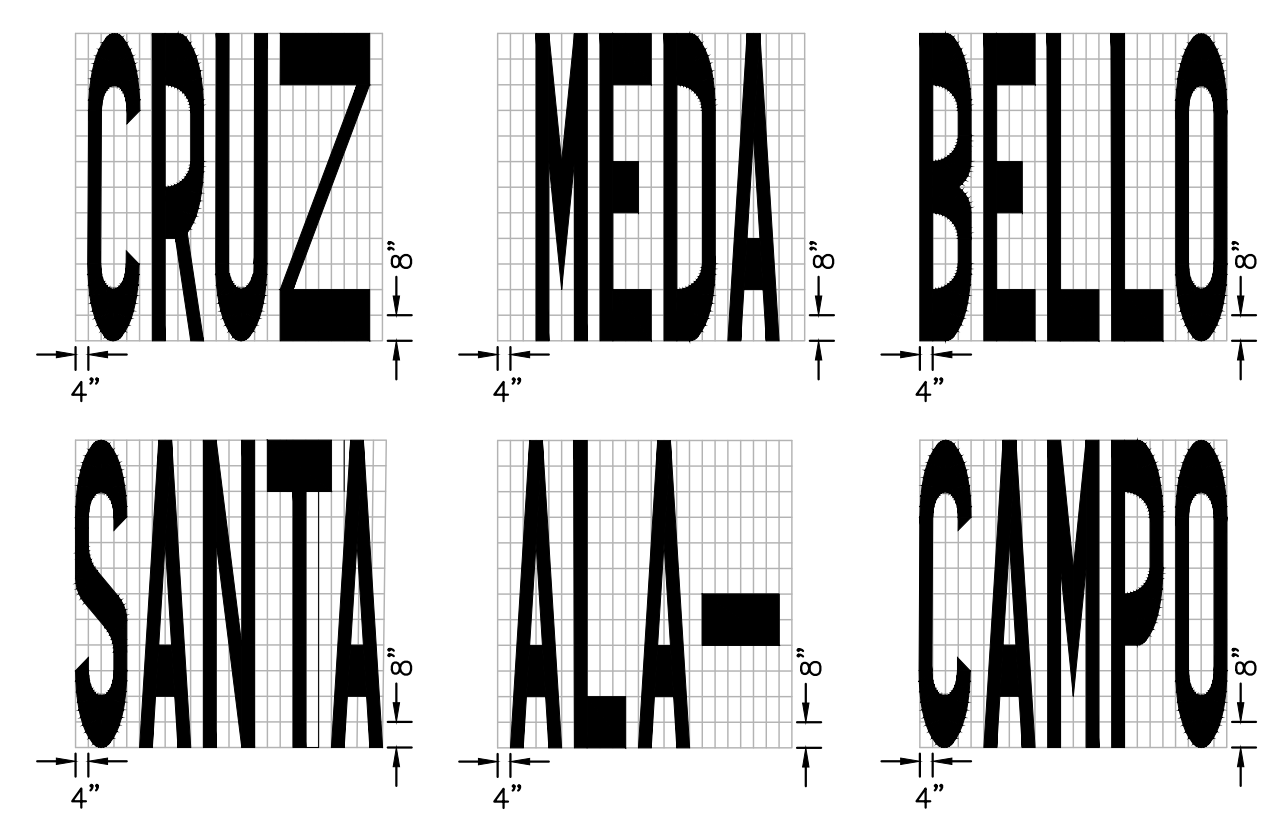

CUSTOM PAVEMENT MARKINGS
 *LETTERS TO FOLLOW STANDARDS SET BY 2014 CA MUTCD SECTION 3B.20
 N.T.S. 5
SS-03

APPROVED DATE: APRIL 19, 2024

SIGNATURE *[Signature]*
 JOHN PULLIAM
 KIMLEY-HORN
 R.C.E. # 68897 / EXPIRES 09-30-2025

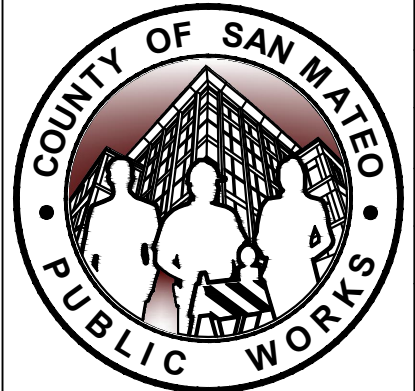

DESIGNED BY: CLH/ASP /HW	SANTA CRUZ AVENUE/ALAMEDA DE LAS PULGAS COMPLETE STREET PROJECT FROM AVY AVENUE TO SAND HILL ROAD	SCALE: AS SHOWN
CHECKED BY: JP	SIGNING AND STRIPING DETAILS	DATE: 04/19/2024
DRAWN BY: SD/KS		FILE NO.: E5043
ANN MADER STILLMAN, DIRECTOR OF PUBLIC WORKS COUNTY OF SAN MATEO	555 COUNTY CENTER, 5th FLOOR REDWOOD CITY, CALIFORNIA 94063	SS-03 SHEET 57 OF 68
REVISION	DATE	

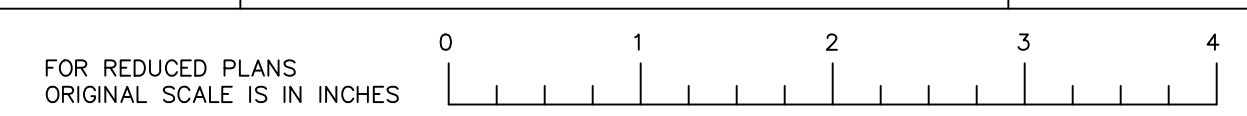

FILENAME: K:\BAY_ROW\097889107 - SANTA CRUZ AVE - JP\08 CADD\PLANSHEETS\SS-01.DWG (SS-03)