



July 1, 2025

Rob Bartoli, Executive Officer
San Mateo LAFCo
455 County Center, 2nd Floor
Redwood City, CA 94063

Re: Letter Authorizing Application to the San Mateo Local Agency Formation Commission Requesting Approval for Extension of Water Service to 3865 Jefferson Avenue, APN: 057-270-110 Outside of Jurisdictional Boundaries Pursuant to Government Code Section 56133

The City of Redwood City has received a request to authorize water service to the property located at 3865 Jefferson Avenue, APN: 057-270-110 (“Property”). The Property is located in Unincorporated San Mateo County, California, and is outside the jurisdictional boundaries of the City of Redwood City (“City”), but inside the City’s sphere of influence and water service area. The County of San Mateo has approved an application to subdivide the Property. County of San Mateo’s approval of the building permits is conditioned upon the property owner obtaining authorization for water service on the Property.

On April 28, 2025, Redwood City Council Resolution No. 16293 approved a master resolution for all future applications to the San Mateo Local Agency Formation Commission (“LAFCo”) upon request from individual property owners located within a defined Affected Territory. The proposed service extension to the Property is within the Affected Territory and meets the requirements of Resolution No. 16293. The City Engineer is hereby authorized to submit an application to LAFCo requesting approval of the water service outside the City’s jurisdictional boundaries but within the City’s sphere of influence and water service area to the Property, pursuant to California Government Code Section 56133 of the Cortese-Knox-Hertzberg Local Government Reorganization Act of 2000. This approval is subject to the conditions in Attachment B.

LAFCo is requested to take proceedings in the manner provided by California Government Code Section 56133 for this application for extension of water service.

Sincerely,

A handwritten signature in blue ink that reads "Melissa Stevenson Diaz".

Melissa Stevenson Diaz
City Manager
City of Redwood City

ATTACHMENTS

Attachment A – Project Vicinity Map
Attachment B – Conditions of Approval

cc: Tanisha Werner, Director of Engineering and
Transportation Paolo Baltar, Senior Civil
Engineer Christian Craig, Assistant Engineer

ATTACHMENT A – PROJECT VICINTY MAP

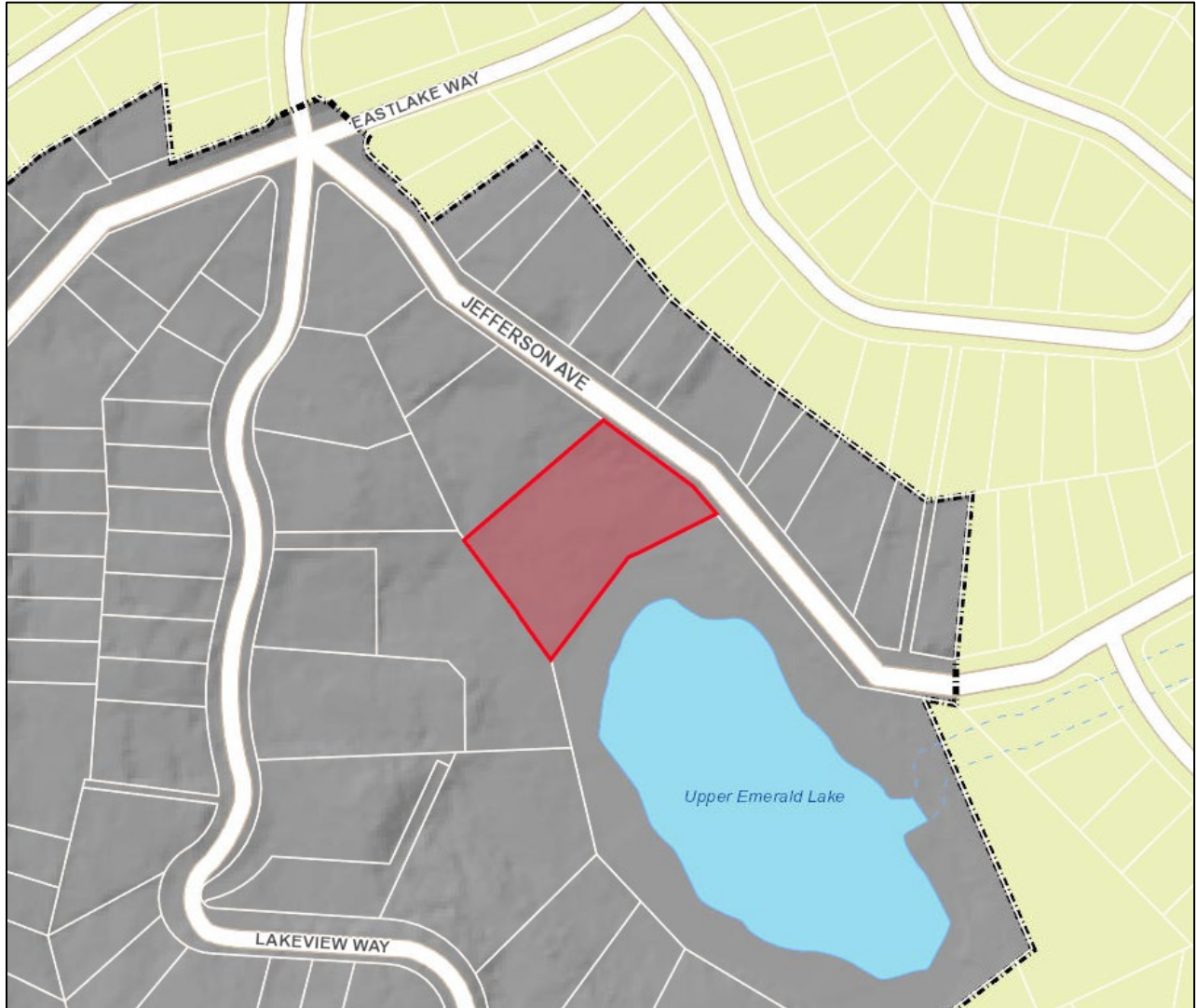

ATTACHMENT B – CONDITIONS OF APPROVAL

- a. Individual property owner shall obtain LAFCo approval of the application for the proposed water and/or sewer service connection;
- b. Individual property owner shall pay LAFCo fees;
- c. After approval of the construction drawings by the San Mateo County Building Department and upon application for new or extended water and/or sewer service, individual property owner shall pay all applicable City fees, including connection fees associated with proposed water and/or sewer service;
- d. Individual property owner shall pay the City's water and/or sewer service annexation fees;
- e. Individual property owner shall install new water and/or sewer service lines;
- f. Individual property owner shall be responsible for the design, construction, and connection of any water and/or sewer main modifications or extensions necessary to provide adequate flow for domestic use and fire suppression, in accordance with City Code Chapter 38 (Water System Regulations) for water and City Code Chapter 27 (Sanitary Sewerage Facilities) for sewer and as determined by the City and the Fire Marshal within the local jurisdiction;
- g. Individual property owner shall pay the fees for any construction permit in connection with improvements for new water and/or sewer service and shall pay associated costs for plan review and inspections;
- h. Individual property owner shall obtain a City encroachment permit prior to commencement of construction work within the public right of way for work relating to the water and/or sewer line connection and pay deposit/fees in accordance with the City's master fee schedule along with the service connection request;
- i. Individual property owner shall adhere to all the review comments and conditions of service stated by the City;
- j. Individual property owner shall execute a Declaration of Restriction and record it with the County of San Mateo;
- k. Individual property owner shall execute other agreements with the City, including but not limited to maintenance agreements for the new infrastructure installed, as may be necessary and determined by the City Engineer; and
- l. Individual property owner shall obtain any additional permits from other agencies that may be required for the construction work relating to the new service connection.