

COUNTY OF SAN MATEO CALIFORNIA

BUNKER HILL DRIVE AND AVENUE ALHAMBRA SAFE ROUTES TO SCHOOL PEDESTRIAN IMPROVEMENTS PROJECT COUNTY PROJECT NO. RW937, PROJECT FILE NO. E5049000, STATE FUND NO. HSIPSL-5935(086)

TO BE SUPPLEMENTED BY STATE OF CALIFORNIA DEPARTMENT OF TRANSPORTATION STANDARD PLANS
DATED 2018 AND ADOPTED BY SAN MATEO COUNTY, FEBRUARY 11, 2020, BY RESOLUTION NO. 077227



APPROVED:
DATE: FEBRUARY 24, 2023
Ann Mader Stillman
ANN MADER STILLMAN,
DIRECTOR OF PUBLIC WORKS
R. C. E. # 47882 / EXPIRES 12-31-2023

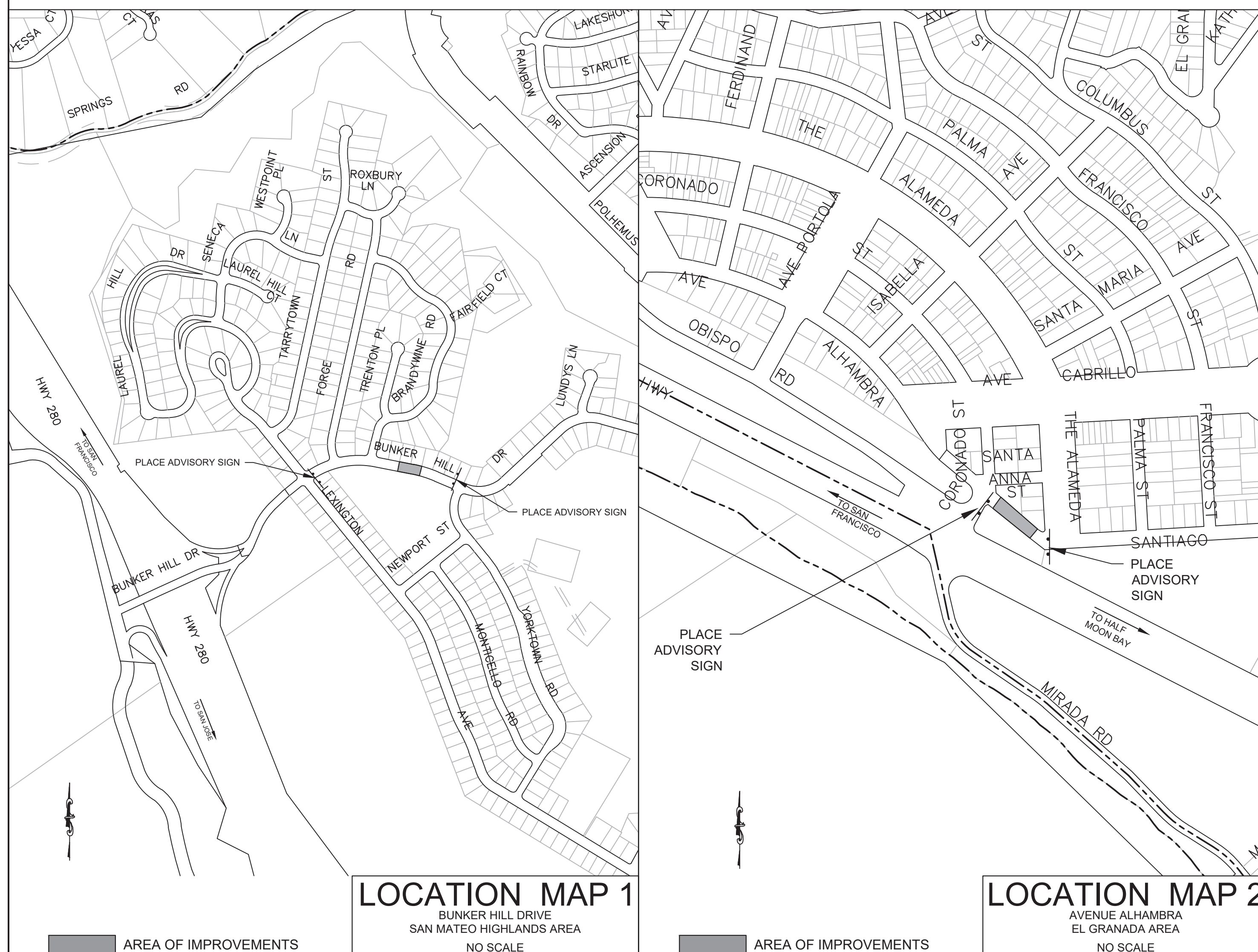
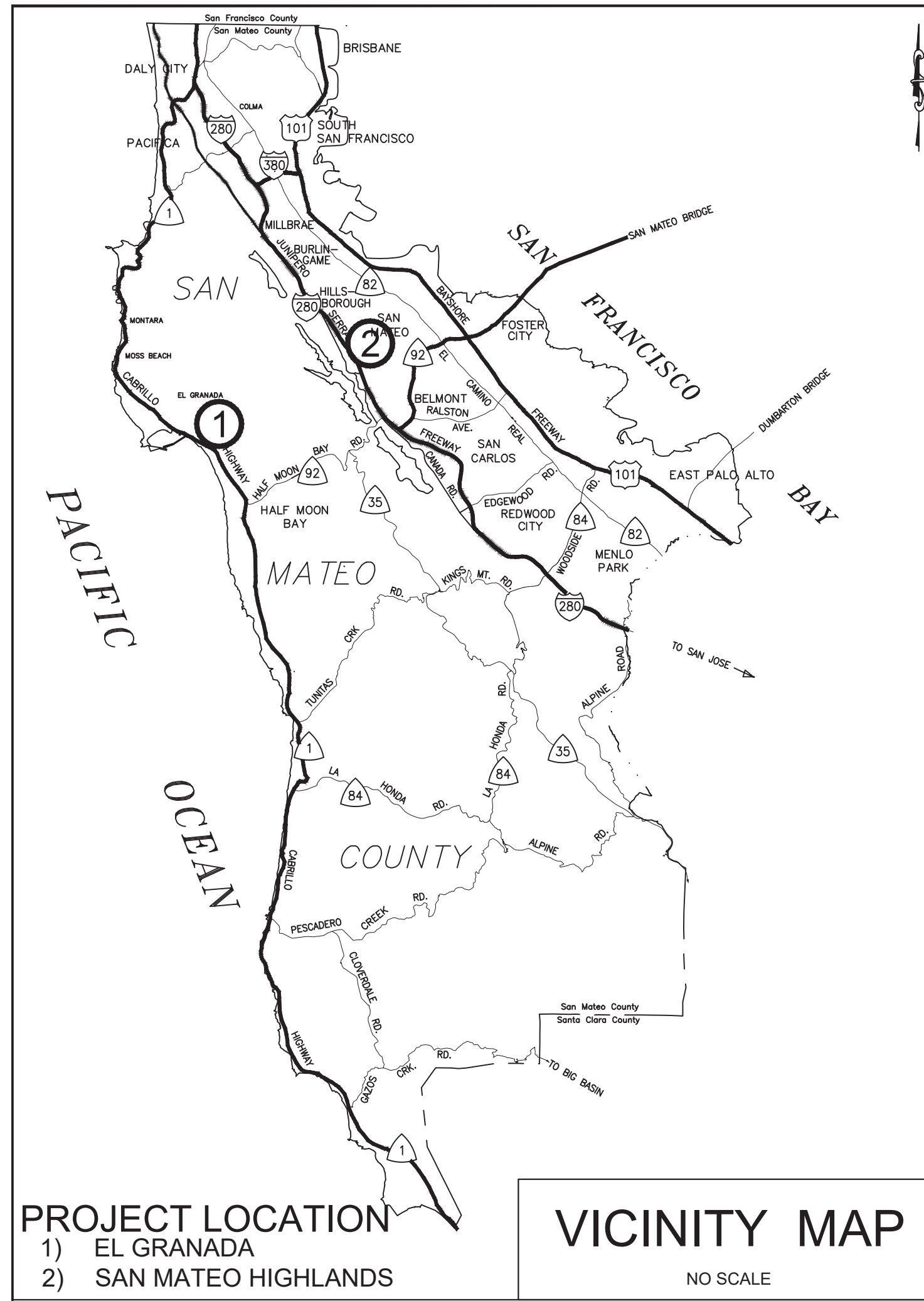

ABBREVIATIONS:

AB	AGGREGATE BASE
AB (CL.2)	AGGREGATE BASE (CLASS 2)
Abn	ABANDON
AC	ASPHALT CONCRETE (TYPE A HOT MIX ASPHALT)
AC (TYPE A HMA)	ASPHALT CONCRETE (TYPE A HOT MIX ASPHALT)
ADA	AMERICANS WITH DISABILITIES ACT
AGG	AGGREGATE
AV	AVENUE
BC	BACK OF CURB
BW	BACK OF WALK
C	CENTER
CA	CALIFORNIA CONCRETE
CONC	CONCRETE
C&G	CURB AND GUTTER
CRF	CODE OF FEDERAL REGULATIONS
CL	CENTERLINE, CLASS
DIA.	DIAMETER
ELE	ELEVATION
ETW	EDGE OF TRAVEL WAY
EP	EDGE OF PAVEMENT
EX, EXIST	EXISTING
FD	FOUND
FLG	FLOWLINE GUTTER
FH	FIRE HYDRANT
FL	FLOW LINE
G	GAS LINE
GB	GRADE BREAK
GV	GAS VALVE
HMA	HOT MIX ASPHALT
I.D.	INSIDE DIAMETER
JP	JOINT UTILITY POLE
LB	POUNDS
LG, LIP	LIP OF GUTTER
LT, L	LEFT
LN/FT	LINEAR FEET
MAX	MAXIMUM
MB	MAILBOX
MIN	MINIMUM
MON	MONUMENT
MONWELL	MONUMENT WELL
MPH	MILES PER HOUR
N/S	NAIL & SHINER
NO, #	NUMBER
O.C.	ON CENTER
O.D.	OUTSIDE DIAMETER
O.G.	ORIGINAL GROUND, ON GRADE
P.B.A	PUSH BUTTON ASSEMBLY
PCC	PORTLAND CONCRETE CEMENT
PNT	POINT
PR	PROPOSED
RC	RELATIVE COMPACTION
RCE	REGISTERED CIVIL ENGINEER
RRFB	RECTANGULAR RAPID FLASHING BEACON
RSP	REVISED STANDARD PLAN
RT, R	RIGHT
R/W, ROW	RIGHT OF WAY
SEC	SECTION
SF	SQUARE FEET
SHT	SHEET
SMC	SAN MATEO COUNTY
SS	SANITARY SEWER
SSCO	SANITARY SEWER CLEANOUT
SSMH	SANITARY SEWER MANHOLE
ST	STREET
STA	STATION
APX STA	APPROXIMATE STATION
TC	TOP OF CURB
TS	TOP OF SIDEWALK
TYP	TYPICAL
UND	UNDERGROUND
UNK	UNKNOWN
VG	VALLEY GUTTER
W/	WITH
WM	WATER METER
WV	WATER VALVE

LEGEND:

---	RIGHT OF WAY
▨	ACCESS RAMP DOMES
▨	CLASS 2 AGGREGATE BASE - AB (CL. 2) (GRAVEL)
▨	CLASS 3 CONCRETE
▨	MISCELLANEOUS ASPHALT CONCRETE 6" (HMA TYPE A)
▨	NATIVE SOIL
▨	REMOVE AND REPLACE CONCRETE
▨	THERMOPLASTIC CROSSWALK
▨	CLASS 3 CONCRETE - 12 INCH RETAINER
⊕	FIRE HYDRANT
⊕	FIRE HYDRANT MARKERS
⊕	MAILBOX
⊕	EXISTING SIGN
⊕	PROPOSED SINGLE POST SIGN
⊕	MONUMENT
000	HOUSE NUMBER ADDRESS
⊕	DETAIL NUMBER AND SHEET
⊕	EXISTING TREE
⊕	EXISTING FENCE / WALL
⊕	WATER VALVE
⊕	GAS VALVE
⊕	JOINT UTILITY POLE
⊕	SANITARY SEWER MANHOLE
LEGEND	NEW PAVEMENT MARKINGS
LEGEND	EXISTING PAVEMENT MARKINGS

NOTES:

- CONTRACTOR SHALL CONFINE HIS OPERATIONS AND ACTIVITIES WITHIN THE PROJECT LIMITS, CONSISTING OF ROAD RIGHT-OF-WAY, RIGHTS OF ENTRY AND/OR PROJECT CONFORMS, AS SHOWN ON THE PLANS AND AS DIRECTED BY THE ENGINEER.
- CONTRACTOR SHALL BE RESPONSIBLE FOR CONTACTING THE UTILITIES TO DETERMINE EXACT LOCATIONS AND DEPTHS. CONTRACTOR SHALL CALL USA NORTH 811 (USA) UNDERGROUND SERVICE ALERT A MINIMUM OF FORTY-EIGHT (48) HOURS IN ADVANCE OF ANY EXCAVATION OR TRENCHING WORK. USA MAY BE CONTACTED EITHER ON-LINE AT USANORTH811.ORG OR BY PHONE BY DIALING (800) 227-2600 OR 811. WHEN CALLING, BE PREPARED TO GIVE LOCATION AND NATURE OF WORK, START DATE, COMPANY NAME, ADDRESS AND TELEPHONE NUMBER.
- PLANS MAY NOT SHOW ALL EXISTING WATER, GAS OR SANITARY SEWER LATERALS. CONTRACTOR SHALL BE RESPONSIBLE FOR VERIFICATION AND PRESERVATION OF ALL SUCH FACILITIES WHICH ARE NOT TO BE RELOCATED.
- CONTRACTOR IS ADVISED THAT EXCAVATION MAY CONFLICT WITH SANITARY SEWER LATERALS, GAS LINES, WATER LINES AND OTHER UNDERGROUND UTILITIES. ANY DAMAGE TO EXISTING FACILITIES CAUSED BY THE CONTRACTOR SHALL BE REPAIRED AT THE CONTRACTOR'S EXPENSE.
- DRIVEWAY OPENINGS AND CONFORM LOCATIONS SHOWN ARE APPROXIMATE ONLY. EXACT LOCATIONS WILL BE DETERMINED IN THE FIELD BY THE ENGINEER.
- NO TREES, VEGETATION OR IMPROVEMENTS (INCLUDING FENCES) SHALL BE REMOVED WITHOUT THE PRIOR WRITTEN CONSENT AND APPROVAL OF THE ENGINEER. VEGETATION AND IMPROVEMENTS WHICH ARE DESIGNATED TO BE REMOVED SHALL BECOME THE PROPERTY OF THE CONTRACTOR, UNLESS OTHERWISE DIRECTED BY THE ENGINEER.
- WHEN DIRECTED BY THE ENGINEER, CUT AND FILL SLOPE RATIOS SHALL BE VARIED TO AVOID TREES OR OTHER EXISTING IMPROVEMENTS.
- ANY DAMAGE, AS A RESULT OF THE CONTRACTOR'S OPERATION, TO PAVEMENT AND BASE MATERIAL THAT IS TO REMAIN SHALL BE REPAIRED, OR REMOVED AND REPLACED WITH SAME TYPE OF MATERIAL OR APPROVED EQUAL, AS DIRECTED BY THE ENGINEER, AND AT THE SOLE EXPENSE OF THE CONTRACTOR. THE ENGINEER SHALL BE THE SOLE JUDGE OF THE ADEQUACY OF THE COMPLETED REMEDIAL WORK.

APPLICABLE STANDARD PLANS:

CALTRANS
A20A, RSP A20B, A24D, RSP A24E, A24F, 27B, A73A, A88A, A88B, ES-7A, RS-1, RS-2, RS-3, RS-4, RSP T13

MUTCD
SECTION 3B.16 (STOP AND YIELD LINES), FIGURE 3B-16 (RECOMMENDED YIELD LINE LAYOUTS), FIGURE 3B-17 (EXAMPLES OF YIELD LINES AT UNSIGNALIZED MIDBLOCK CROSSWALKS), SECTION 4D.14 (LONGITUDINAL POSITIONING OF SIGNAL FACES), SW24-2 (CA) (SCHOOL CROSSWALK WARNING ASSEMBLY), R1-6B, (FIGURE 2B-2, IN-STREET AND OVERHEAD PEDESTRIAN CROSSING SIGNS)

SHEET INDEX:

- TITLE SHEET / GENERAL NOTES
- PLAN SHEET - BUNKER HILL DRIVE
- PLAN SHEET - AVENUE ALHAMBRA
- MISCELLANEOUS DETAILS



DESIGNED BY: JS	BUNKER HILL DRIVE AND AVENUE ALHAMBRA	SCALE: AS SHOWN
CHECKED BY: WN	SAFE ROUTES TO SCHOOL PEDESTRIAN IMPROVEMENTS PROJECT	DATE: 02-24-2023
DRAWN BY: JS	TITLE SHEET / GENERAL NOTES	FILE NO.: 1/5049
ANN MADER STILLMAN, DIRECTOR OF PUBLIC WORKS COUNTY SAN MATEO		555 COUNTY CENTER, 5th FLOOR REDWOOD CITY, CALIFORNIA 94063
REVISION	DATE	
FOR REDUCED PLANS ORIGINAL SCALE IS IN INCHES		1 SHEET 1 OF 5

FILENAME: F:\USERS\DESIGN\VC\ID\E5049000_HSIP_CYCLE_10_SRTS\11_DWG\SHEETS\E5049000.DWG (1-5049000)



APPROVED:
 DATE: FEBRUARY 24, 2023
 ANN MADER STILLMAN,
 DIRECTOR OF PUBLIC WORKS
 R. C. E. # 47882 / EXPIRES 12-31-2023

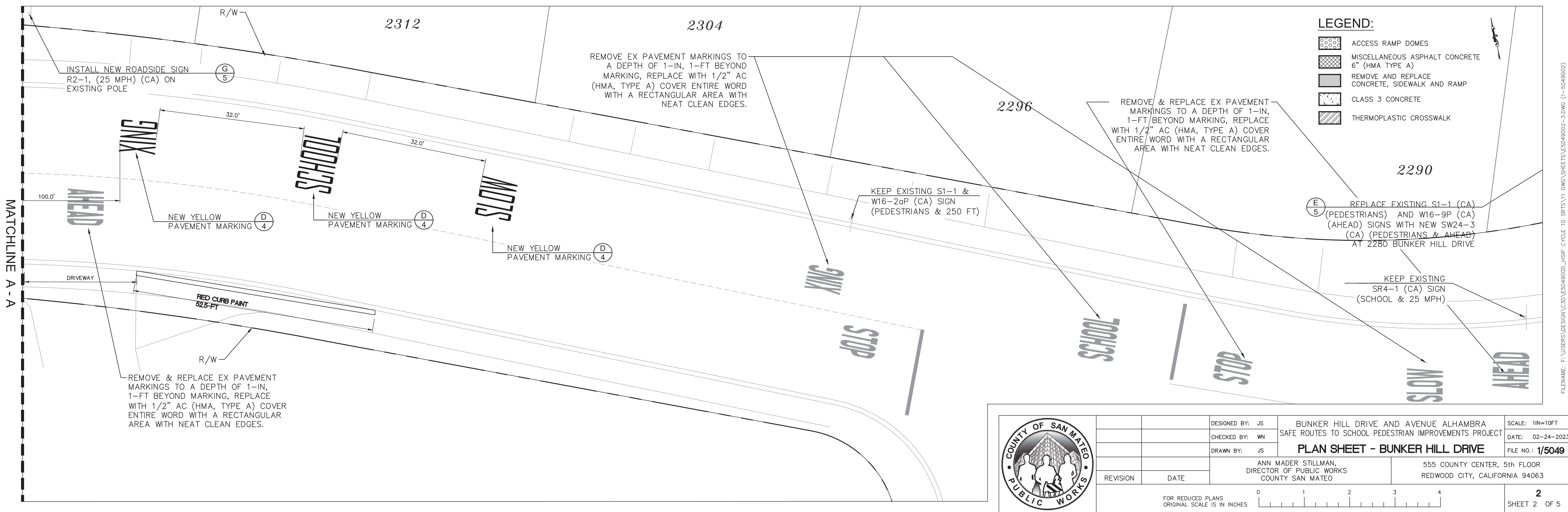
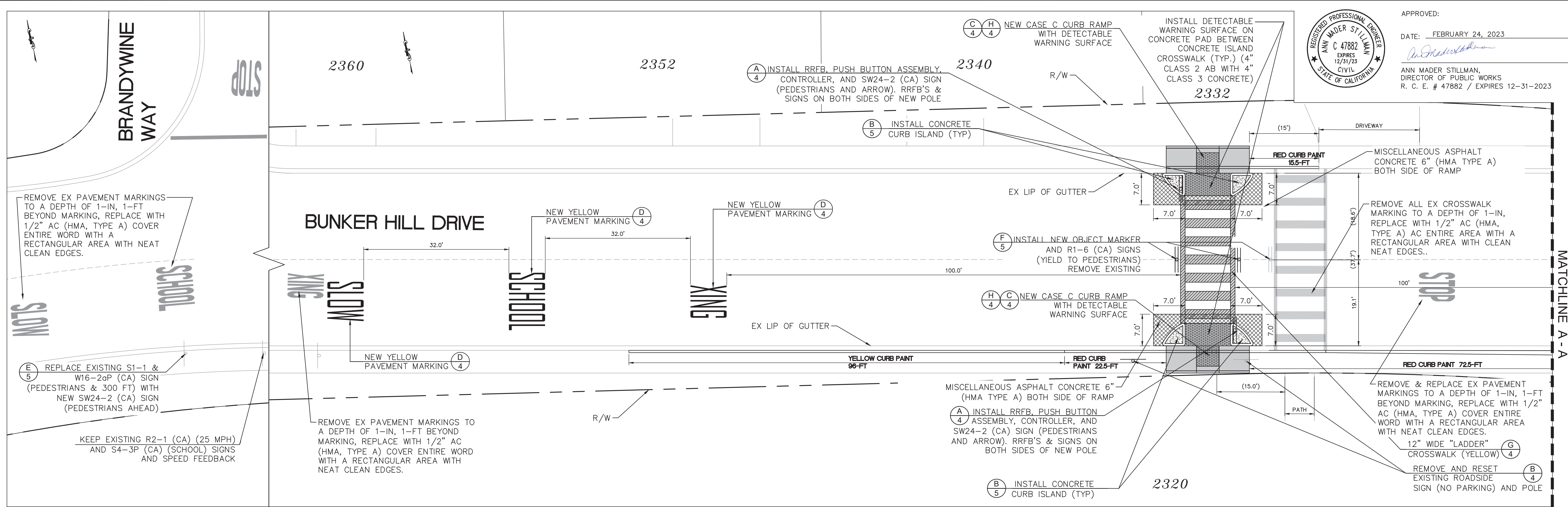

- LEGEND:**
- ACCESS RAMP DOMES
 - MISCELLANEOUS ASPHALT CONCRETE 6" (HMA TYPE A)
 - REMOVE AND REPLACE CONCRETE, SIDEWALK AND RAMP
 - CLASS 3 CONCRETE
 - THERMOPLASTIC CROSSWALK



DESIGNED BY: JS	BUNKER HILL DRIVE AND AVENUE ALHAMBRA		SCALE: 1IN=10FT
CHECKED BY: WN	SAFE ROUTES TO SCHOOL PEDESTRIAN IMPROVEMENTS PROJECT		DATE: 02-24-2023
DRAWN BY: JS	PLAN SHEET - BUNKER HILL DRIVE		FILE NO.: 1/5049
ANN MADER STILLMAN, DIRECTOR OF PUBLIC WORKS COUNTY SAN MATEO		555 COUNTY CENTER, 5th FLOOR REDWOOD CITY, CALIFORNIA 94063	
REVISION	DATE	FOR REDUCED PLANS ORIGINAL SCALE IS IN INCHES	
		0 1 2 3 4	
			2 SHEET 2 OF 5

FILENAME: F:\USERS\DESIGN\C:\D\ES049000_HSPF CYCLE TO SRTS\11 DWG\SHEETS\5049002-3.DWG (1-5049002)



APPROVED:
 DATE: FEBRUARY 24, 2023
 ANN MADER STILLMAN,
 DIRECTOR OF PUBLIC WORKS
 R. C. E. # 47882 / EXPIRES 12-31-2023

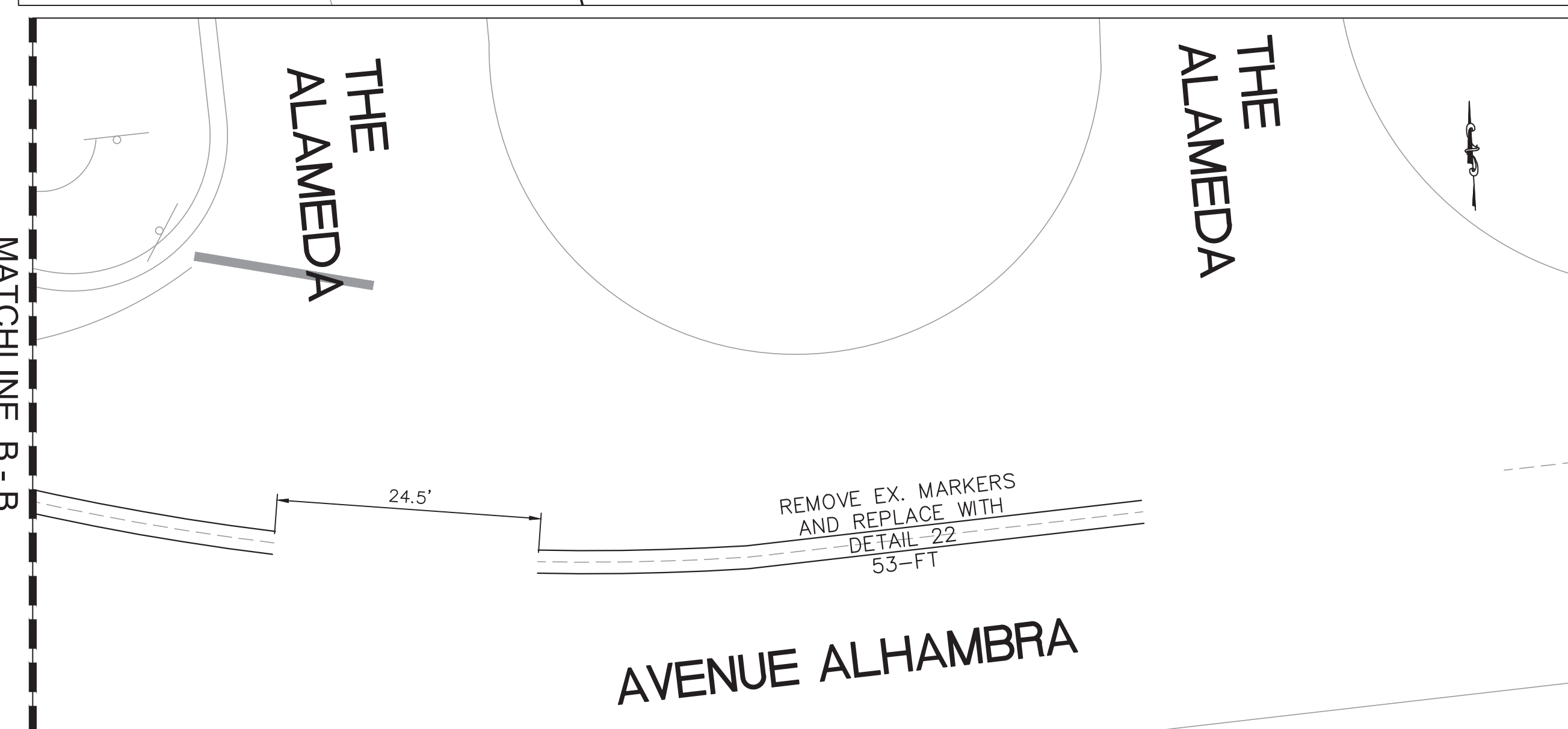
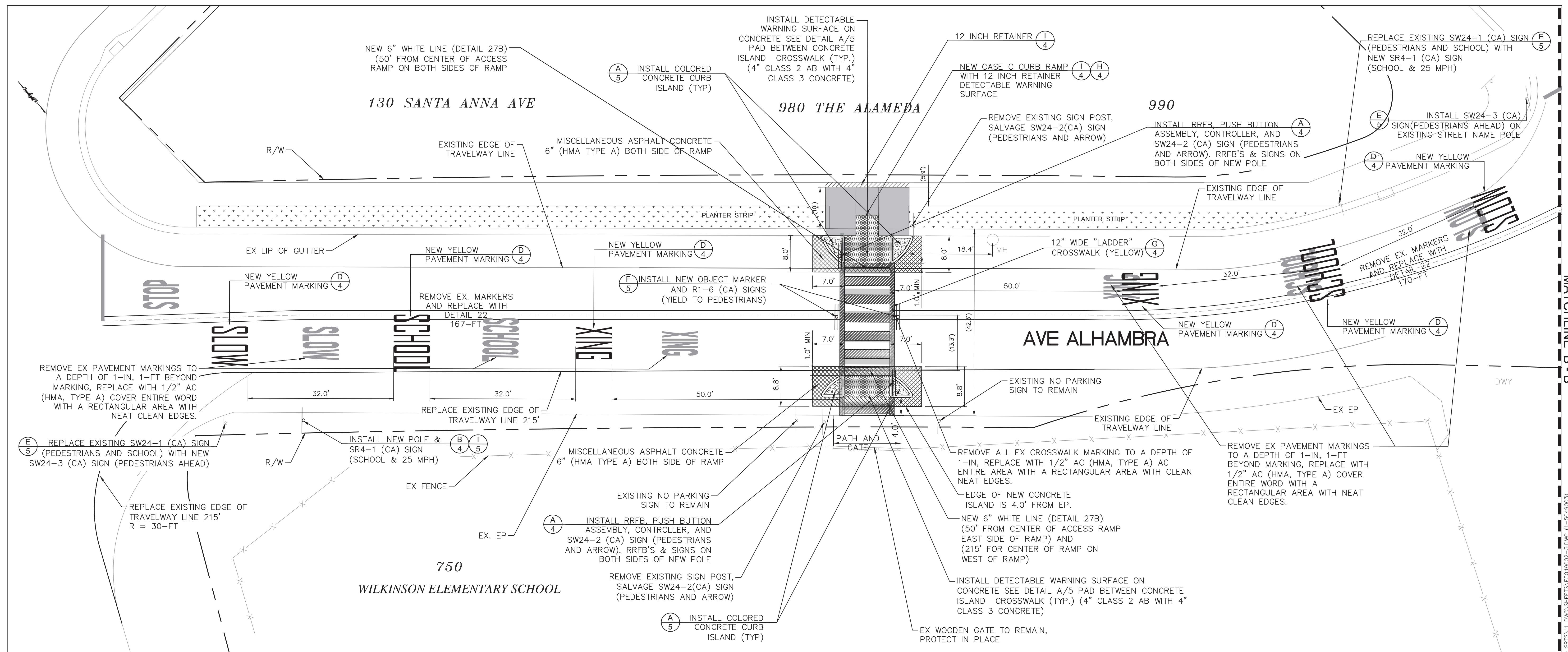

- LEGEND:**
- ACCESS RAMP DOMES
 - CLASS 3 CONCRETE - 12 INCH RETAINER
 - MISCELLANEOUS ASPHALT CONCRETE 6" (HMA TYPE A)
 - REMOVE AND REPLACE CONCRETE, SIDEWALK AND RAMP
 - CLASS 3 CONCRETE
 - THERMOPLASTIC CROSSWALK



DESIGNED BY: JS	BUNKER HILL DRIVE AND AVENUE ALHAMBRA SAFE ROUTES TO SCHOOL PEDESTRIAN IMPROVEMENTS PROJECT		SCALE: 1IN=10FT
CHECKED BY: WN			DATE: 02-24-2023
DRAWN BY: JS	PLAN SHEET - AVENUE ALHAMBRA		FILE NO.: 1/5049
ANN MADER STILLMAN, DIRECTOR OF PUBLIC WORKS, COUNTY SAN MATEO		555 COUNTY CENTER, 5th FLOOR, REDWOOD CITY, CALIFORNIA 94063	
REVISION	DATE		
FOR REDUCED PLANS ORIGINAL SCALE IS IN INCHES		0 1 2 3 4	
			3 SHEET 3 OF 5

FILENAME: F:\USERS\DESIGN\C:\D\ES049000_HSPF CYCLE TO SR\1511.DWG SHEETS\ES049002-3.DWG (1-5049003)

NOTES:

- BACK CASTING SHAPE TO FIT CURVATURE OF POLE.
- PROVIDE COVER FITTING FOR TOP OF POST, WHEN PUSH BUTTON ASSEMBLY (PBA) IS MOUNTED ON PUSH BUTTON ASSEMBLY POST.
- INSTALL PUSH BUTTON ON CROSSWALK SIDE OF STANDARD. USE R10 SERIES REGULATORY SIGNS AND PLAQUES FOR PEDESTRIAN AND BICYCLE FACILITIES.
- FOR ADDITIONAL NOTES, DETAILS AND STANDARDS, SEE STANDARD PLAN.
- HANDHOLE SHALL BE LOCATED ON THE DOWNSTREAM SIDE OF TRAFFIC.
- CONTRACTOR WILL BE RESPONSIBLE FOR POTHOLING TO ENSURE THERE ARE NO UTILITY CONFLICTS WITH FOOTING.
- ASSEMBLY TO INCLUDE "CHIRPER" AUDIBLE DETECTION.
- RRFB'S & SIGNS ON BOTH SIDES OF NEW POLE

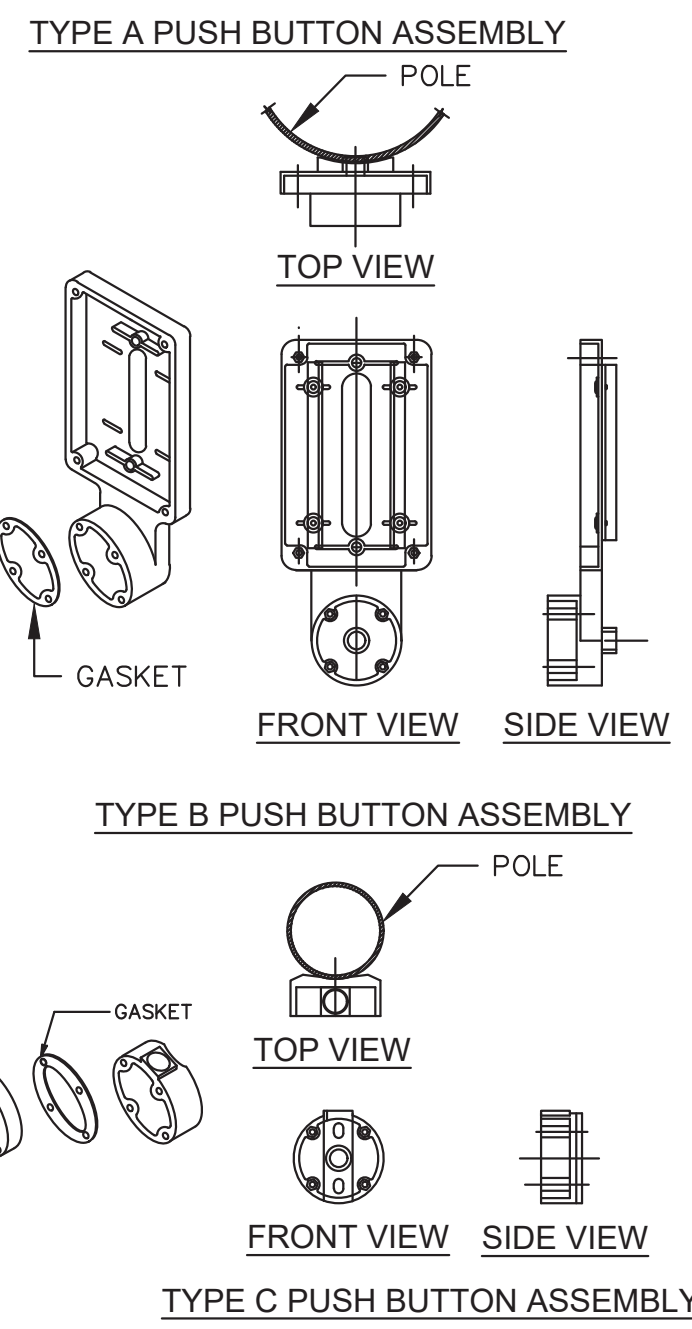
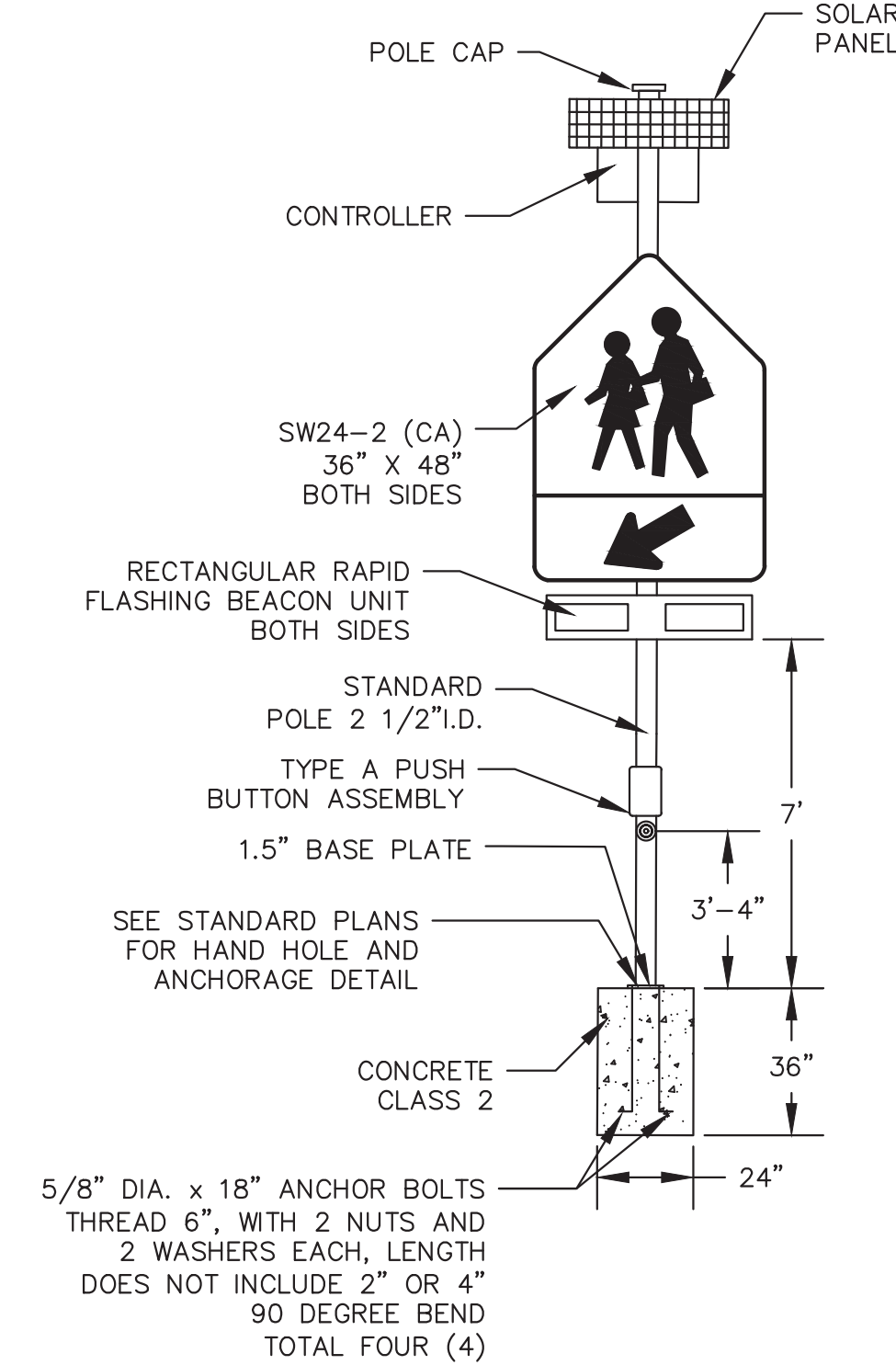
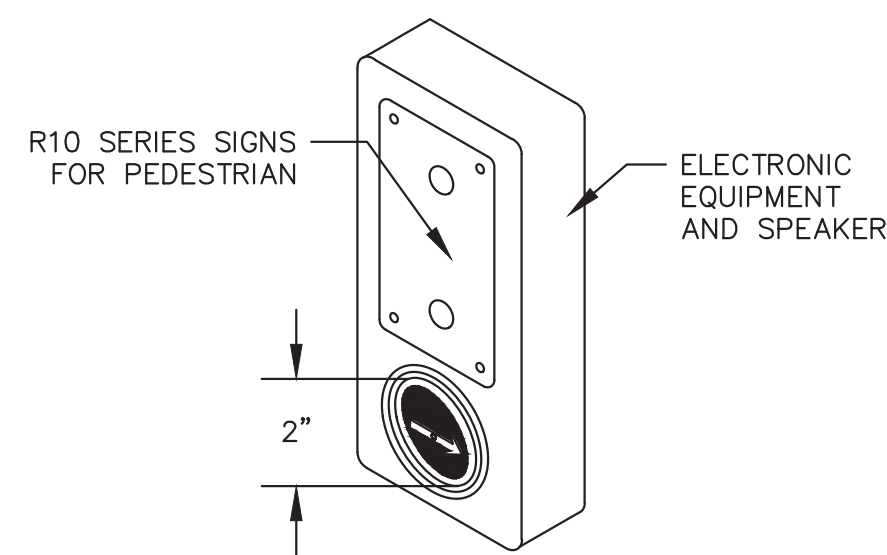

STREET SIGN NOTES:

WHEN A ROADSIDE SIGN IS MOUNTED BENEATH A STREET SIGN, 7-FOOT MINIMUM HEIGHT TO BOTTOM OF SIGN SHALL APPLY, WITH SIGN POST EXTENDED ABOVE ROADSIDE SIGN 6", OR AS DIRECTED BY THE ENGINEER, TO ACCOMMODATE STREET SIGN MOUNTING HARDWARE.

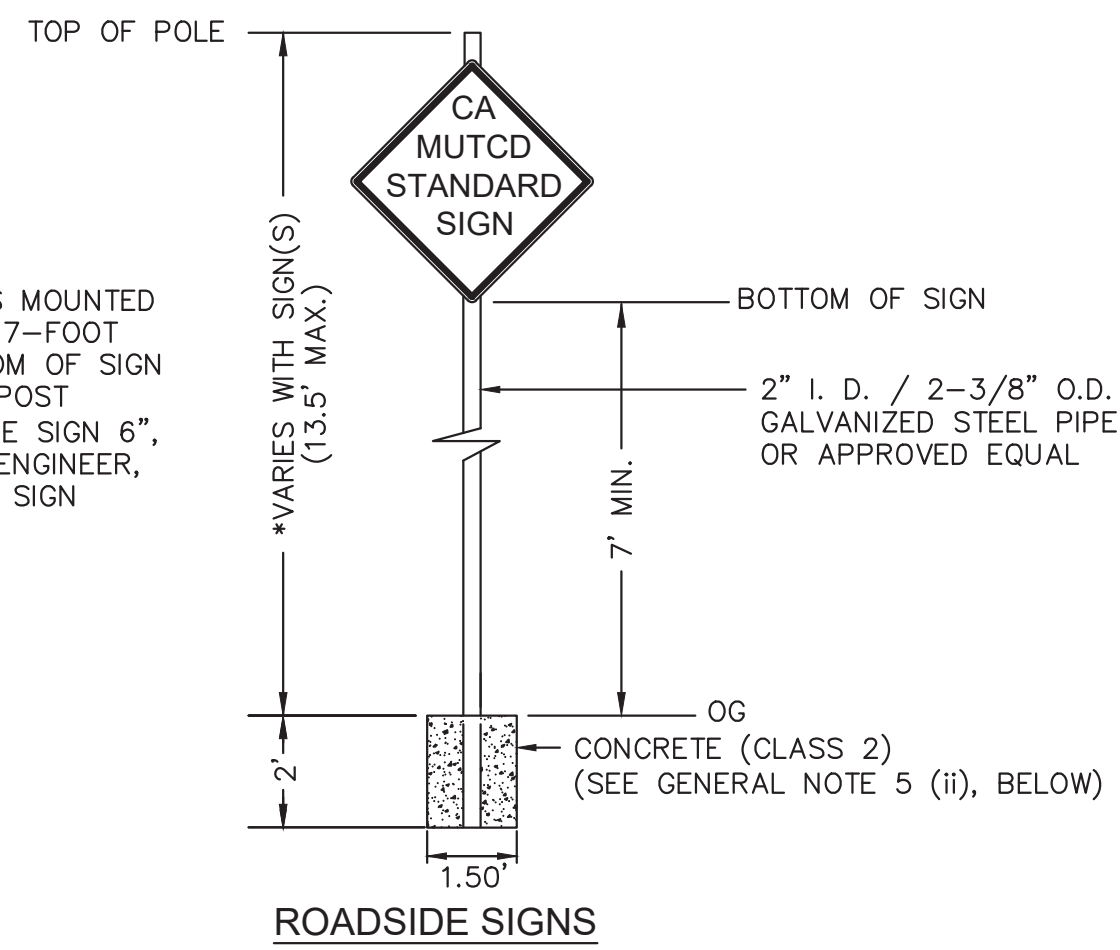

NOTES:

- HEIGHT DIMENSIONS SHALL BE AS SHOWN, OR AS DIRECTED BY THE ENGINEER.
- ANTI-THEFT HARDWARE SHALL BE USED ON ROADSIDE SIGNS, AND SHALL BE HAWKINS TRAFFIC TYPE M2G-C2B-TP, OR APPROVED EQUAL.
- FOR ADDITIONAL NOTES, DETAILS SEE STANDARD PLAN RS1-RS4.
- CONTRACTOR WILL BE RESPONSIBLE FOR POT HOLING TO INSURE THERE ARE NO UTILITY CONFLICTS WITH FOOTING.
- FOR NEW INSTALLATIONS AND RELOCATIONS:
 - PRIOR TO INSTALLATION, THE END OF THE PIPE TO BE BURIED SHALL BE DEFORMED INTO AN OVAL SHAPE, AS DIRECTED BY THE ENGINEER, TO PREVENT POST ROTATION IN THE CONCRETE.
 - METHOD SHOWN IS FOR SIGN INSTALLATION IN SOIL. WHEN NEW SIGNS ARE TO BE INSTALLED IN EXISTING CONCRETE, A 2-FOOT DEEP, 3.5" DIAMETER CORE SHALL BE DRILLED IN THE EXISTING CONCRETE, AND FILLED WITH SPEEDCRETE, SPEEDPLUG OR OTHER APPROVED RAPID SETTING CONCRETE SHALL BE USED AS FILL TO SET THE SIGN POST IN.
- FOR EXISTING ROADSIDE SIGNS TO REMAIN: WHEN NECESSARY, SIGN POSTS SHALL BE EXTENDED BY ATTACHING A SECONDARY LENGTH OF PIPE OF THE APPROPRIATE LENGTH, AS DIRECTED BY THE ENGINEER. METHOD OF ATTACHMENT SHALL BE AS FOLLOWS:
 - WHERE EXISTING PIPE HAS INNER THREADS AT THE TOP OF POST, AN EXTENSION WITH 1.5" EXTERIOR THREADING SHALL BE USED.
 - WHERE THERE IS NO EXISTING THREADING, A SLIP-ON COUPLING SHALL BE USED. SLIP-ON COUPLING SHALL BE HAWKINS TRAFFIC TYPE M1G-4-EX, OR APPROVED EQUAL.

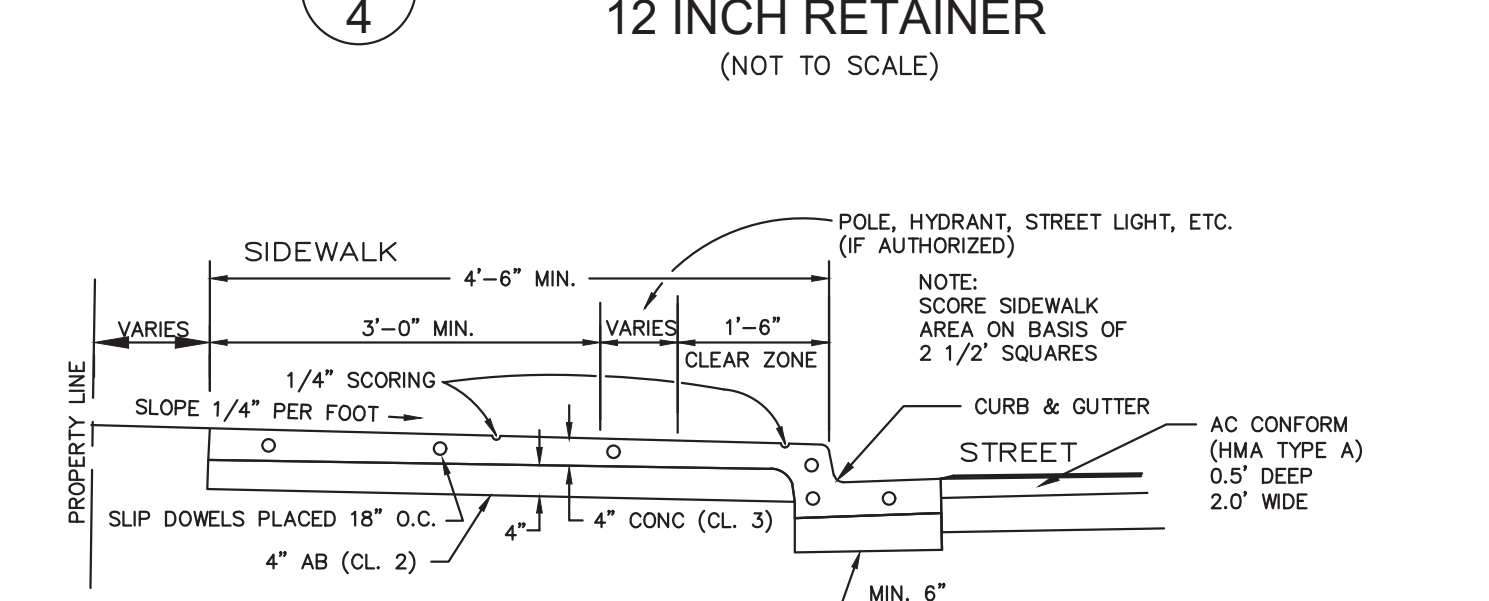
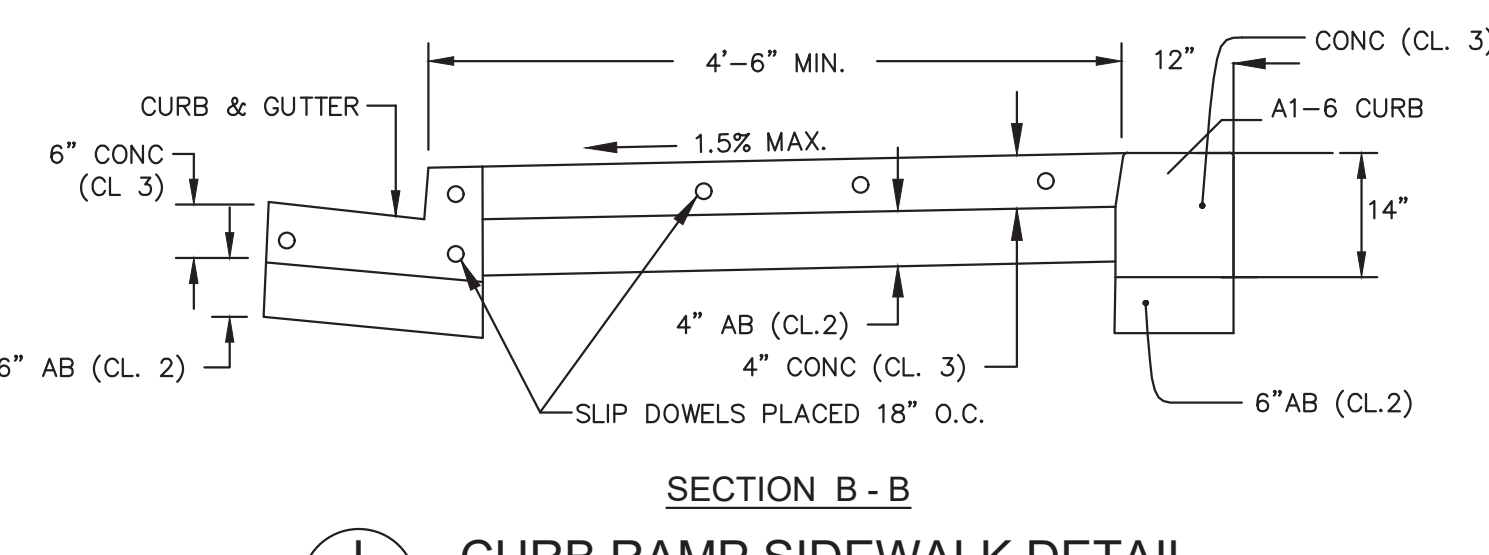
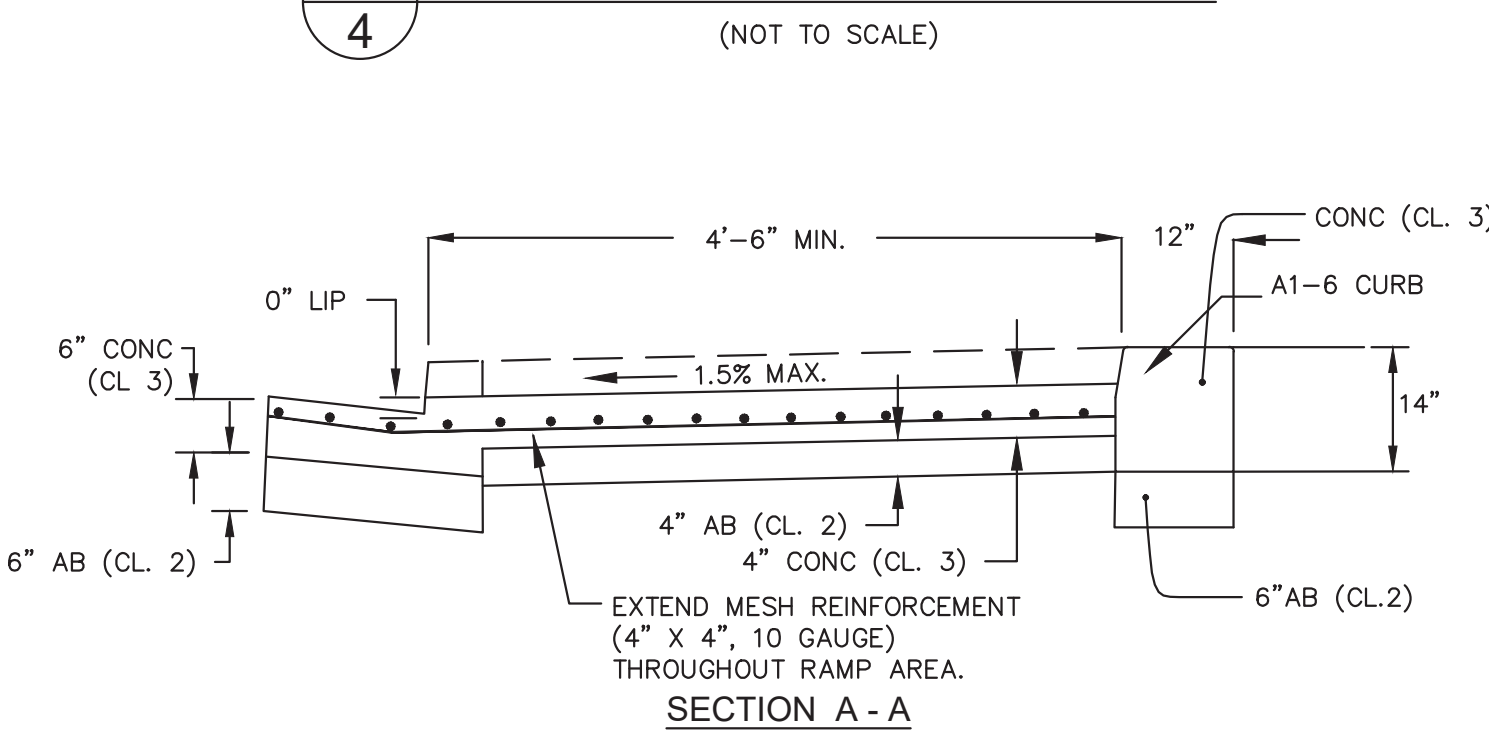
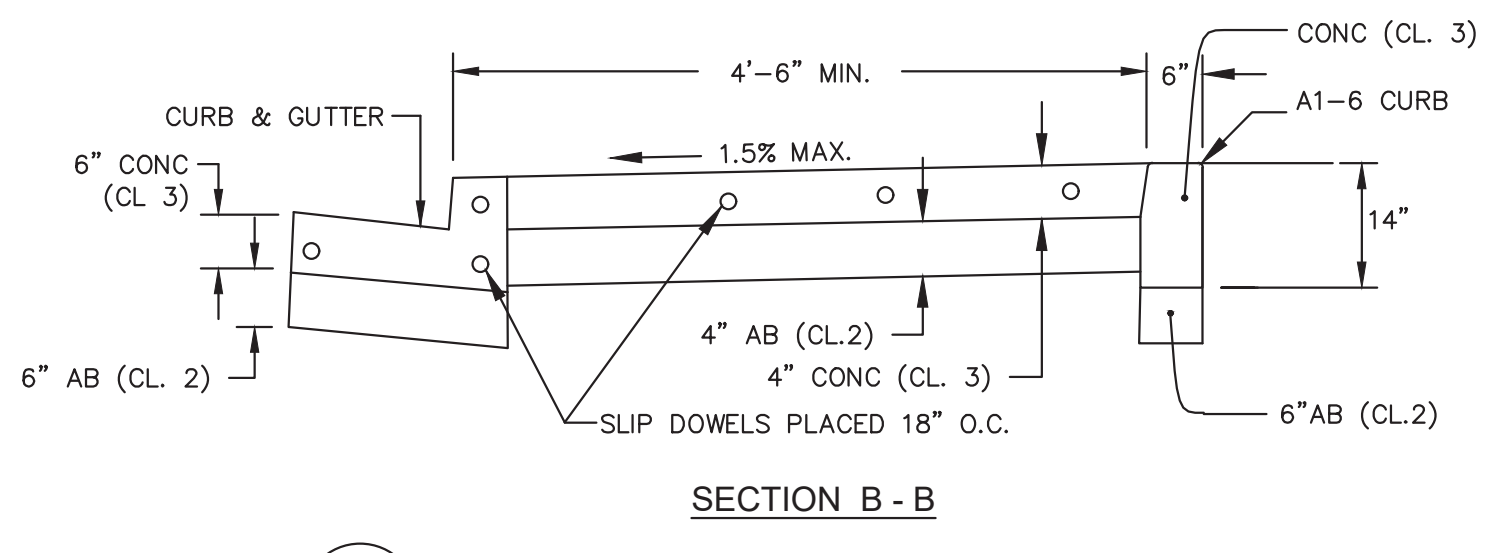
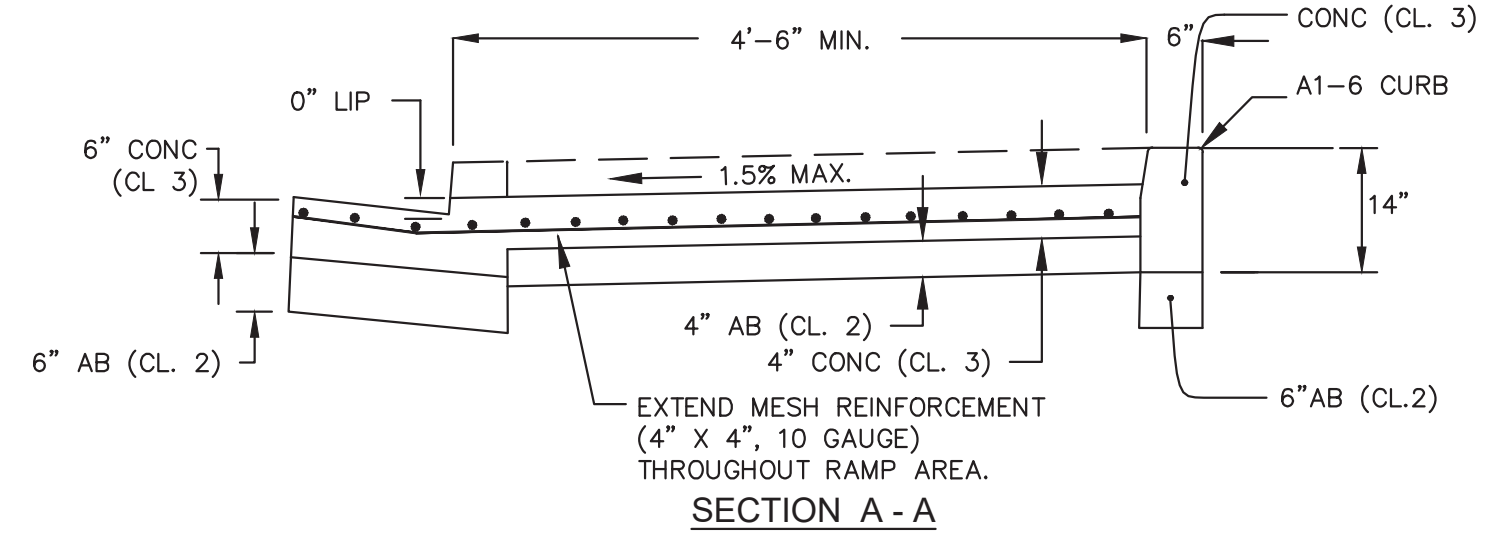
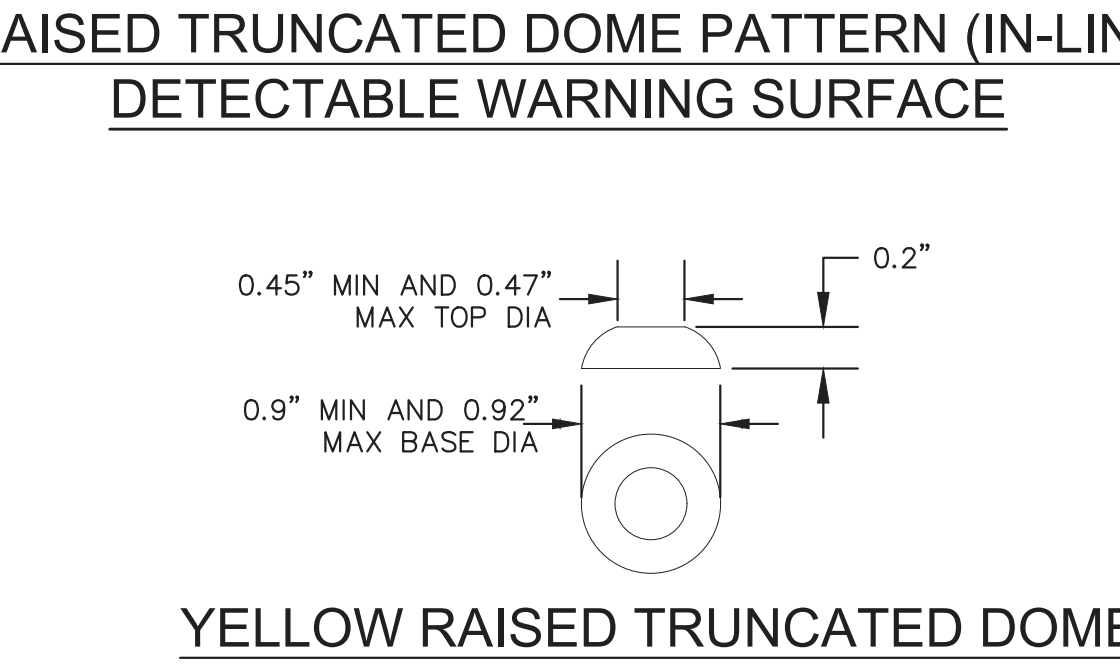
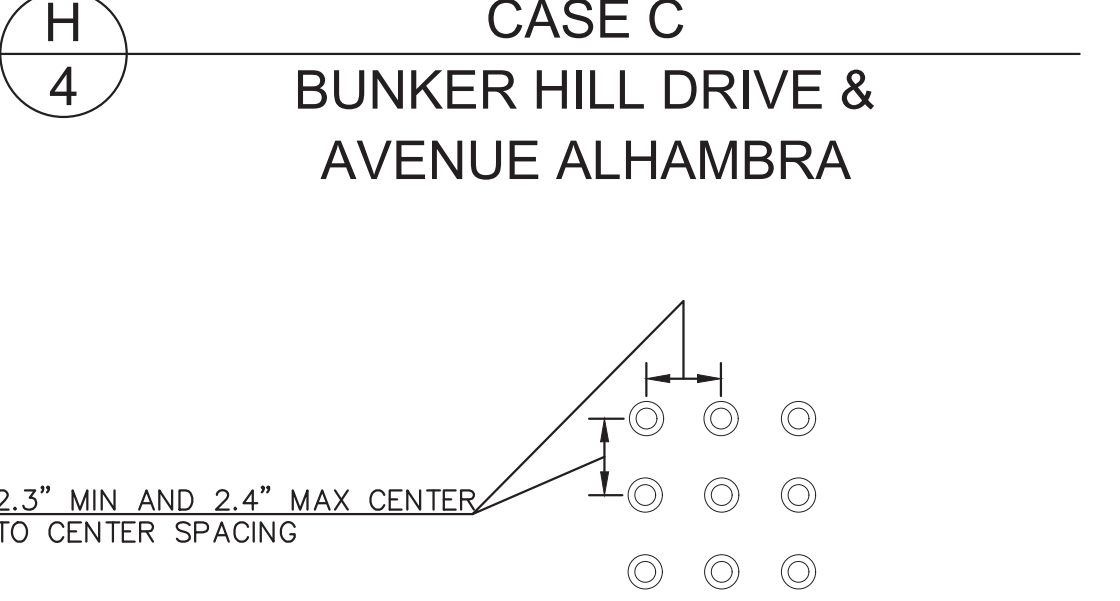
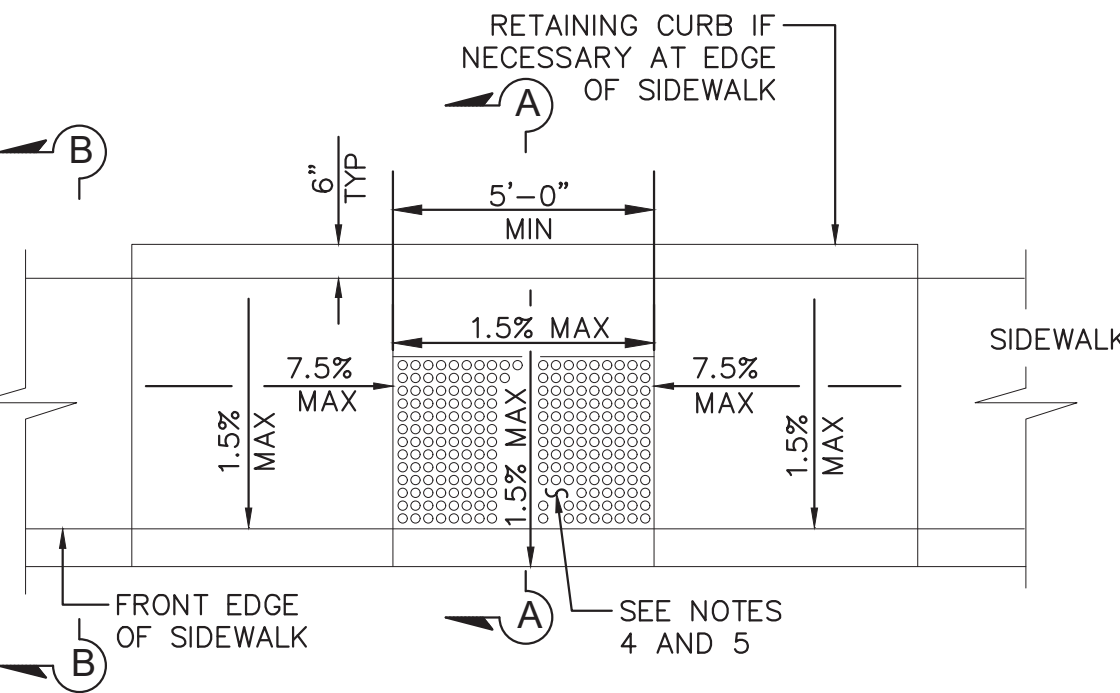

APPROVED: _____
DATE: FEBRUARY 24, 2023

ANN MADER STILLMAN, DIRECTOR OF PUBLIC WORKS
R. C. E. # 47882 / EXPIRES 12-31-2023

REGISTERED PROFESSIONAL ENGINEER
ANN MADER STILLMAN
C 47882
EXPIRES 12/31/23
CIVIL
STATE OF CALIFORNIA

NOTES:

- AS SITE CONDITIONS DICTATE, MODIFIED CASE C CURB RAMP MAY BE USED FOR CORNER INSTALLATIONS AND AT MID-BLOCK LOCATIONS.
- IF LOCATED ON A CURVE, THE SIDES OF THE RAMP NEED NOT BE PARALLEL, BUT THE MINIMUM WIDTH OF THE RAMP SHALL BE 4'-2".
- TRANSITIONS FROM RAMP AND LANDING TO WALKS, GUTTERS OR STREETS SHALL BE FLUSH AND FREE OF ABRUPT CHANGES. THE BOTTOM OF THE RAMP SHALL HAVE NO LIP AND CONFORM TO THE GUTTER FLOWLINE.
- CURB RAMP SHALL HAVE A DETECTABLE WARNING SURFACE THAT EXTENDS THE FULL WIDTH AND 3'-0" DEPTH OF THE RAMP DETECTABLE WARNING SURFACES SHALL BE YELLOW AT BUNKER HILL DRIVE AND AVENUE ALHAMBRA AND CONFORM TO THE DETAILS ON THIS PLAN, THE REQUIREMENTS OF THE SPECIAL PROVISIONS AND THE DIRECTIONS OF THE ENGINEER.
- THE EDGE OF THE DETECTABLE WARNING SURFACE NEAREST THE STREET SHALL BE EXTENDED THROUGH GUTTER.
- RECONSTRUCT SIDEWALK TO NEAREST SCORE LINE AND INSTALL EXPANSION JOINT, UNLESS OTHERWISE DIRECTED BY THE ENGINEER.
- UNLESS OTHERWISE SHOWN ON OR DIRECTED BY THE ENGINEER, IN WRITING, UTILITY PULL BOXES, MANHOLES, VALVE BOXES AND ALL OTHER FACILITIES WITHIN THE BOUNDARIES OF THE CURB RAMP SHALL BE ADJUSTED BY THE CONTRACTOR.
- ADDITIONAL NOTES:
 - TYPICAL FIXED OBJECTS INCLUDE BUT ARE NOT LIMITED TO THE FOLLOWING:
 - TRAFFIC SIGNAL POLE
 - UTILITY POLE
 - PULL BOXES
 - PHONE OR UTILITY BOXES
 - CATCH BASINS
 - RELATIVE COMPACTION OF NOT LESS THAN 95% SHALL BE OBTAINED FOR MINIMUM DEPTH OF 2.5 FEET BELOW FINISH GRADE.
 - A 5'-6" WIDTH FROM FACE OF CURB TO BACK OF SIDEWALK IS THE COUNTY STANDARD WIDTH FOR SIDEWALKS AND ACCESS RAMP, WITH A PREFERRED MINIMUM CLEAR SIDEWALK WIDTH OF 48" FROM BACK OF CURB TO BACK OF SIDEWALK. IF A CLEAR SIDEWALK WIDTH OF 48" IS NOT POSSIBLE TO CONSTRUCT DUE TO NATURAL BARRIERS AND OTHER EXISTING CONDITIONS, THE CLEAR SIDEWALK WIDTH MAY BE REDUCED TO 36", AS STIPULATED BY TITLE 28 CODE OF FEDERAL REGULATIONS (CRF), PART 36: ADA (AMERICANS WITH DISABILITIES ACT) STANDARDS FOR ACCESSIBLE DESIGN.
 - RECONSTRUCT SIDEWALK TO NEAREST EXPANSION JOINT OR, AS APPROVED BY THE ENGINEER IN WRITING, TO THE NEAREST SCORE LINE AND INSTALL EXPANSION JOINT.
 - INSTALL SLIP DOWELS 18" O.C. AT EXPANSION JOINTS.
 - CONSTRUCT MONOLITHIC CURB, GUTTER, AND SIDEWALK.
 - SCORE SIDEWALK AREA WITH 1/4" SCORING ON BASIS OF 2.5' SQUARES (CRACK CONTROL JOINTS), OR AS DETERMINED BY THE ENGINEER.
 - BACKFILL MATERIAL TO BE REPLACED IN KIND AND FLUSH WITH TOP OF CURB, OR AS DIRECTED BY THE ENGINEER.
 - 4' WIDTH MINIMUM CLEARANCE FOR PEDESTRIAN PATH OF TRAVEL SHALL BE MAINTAINED FROM WITHIN THE PROPOSED SIDEWALK.
 - AC PLUG SHALL BE 1.5' WIDE AND 0.5' DEEP. SUBGRADE SHALL BE COMPACTED TO 95% R.C. OR REPLACED WITH CLASS 2 AGGREGATE BASE AS NEEDED AND AS DETERMINED BY THE ENGINEER.
 - AC PLUGS ARE REQUIRED FOR ALL CURB RAMP, VALLEY GUTTERS, AND OTHER CONCRETE STRUCTURES WHICH CONFORM TO THE EXISTING ROADWAY.
 - ALL CONCRETE IN THE EL GRANADA AREA AT AVENUE ALHAMBRA SHALL BE TERRA COTTA (COLOR NO 10134 - DAVIS COLORS) COLORED CONCRETE.

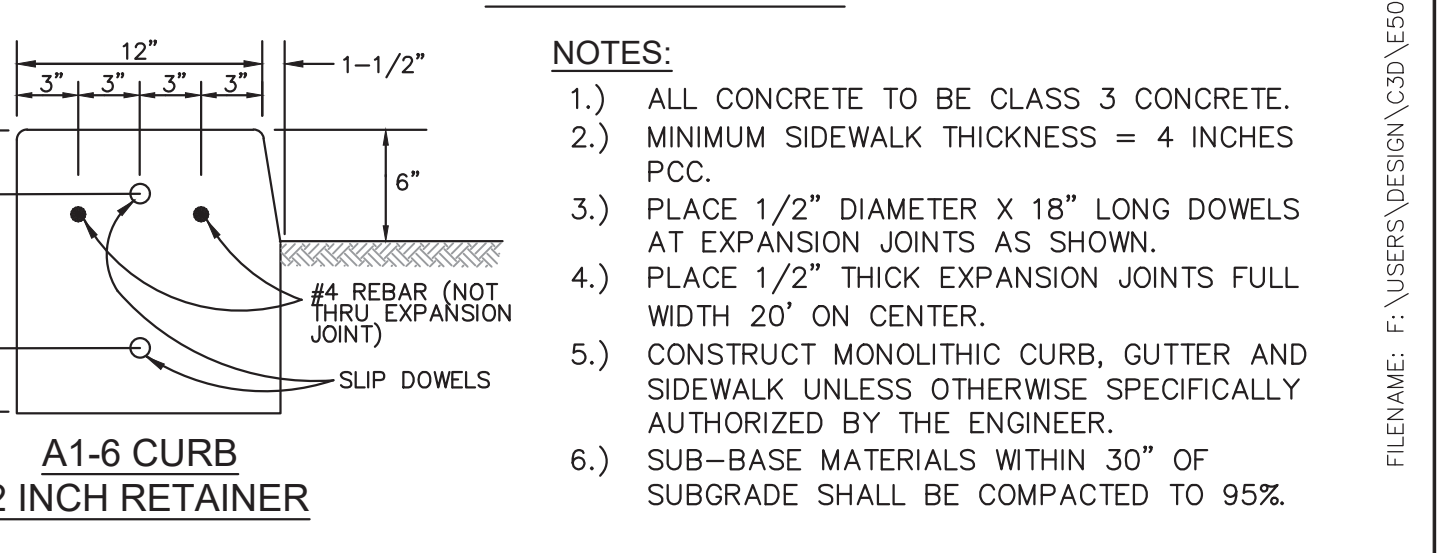
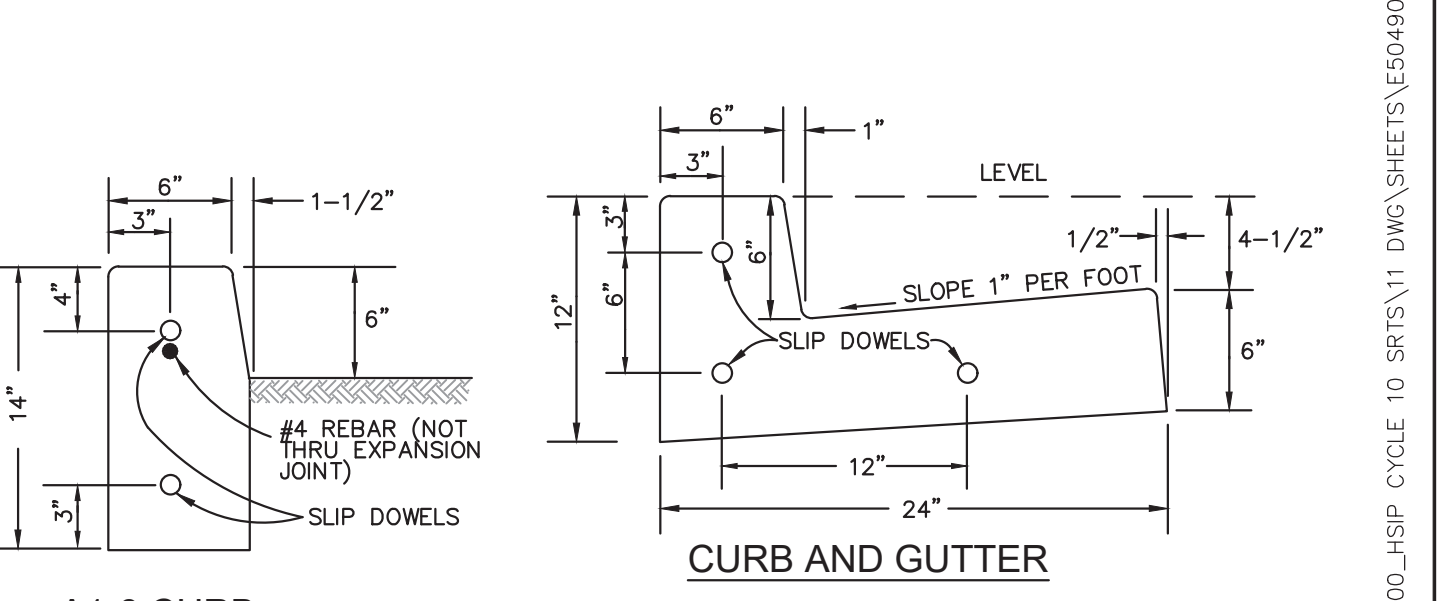

DESIGNED BY: JS
CHECKED BY: WN
DRAWN BY: JS

BUNKER HILL DRIVE AND AVENUE ALHAMBRA
SAFE ROUTES TO SCHOOL PEDESTRIAN IMPROVEMENTS PROJECT

MISCELLANEOUS DETAILS

ANN MADER STILLMAN, DIRECTOR OF PUBLIC WORKS
COUNTY SAN MATEO

555 COUNTY CENTER, 5th FLOOR
REDWOOD CITY, CALIFORNIA 94063

SCALE: AS SHOWN
DATE: 02-24-2023
FILE NO: 1/5049

FOR REDUCED PLANS ORIGINAL SCALE IS IN INCHES

0 1 2 3 4

4
SHEET 4 OF 5

FILENAME: F:\USERS\DESIGN\C3D\ES049000_HSPF_CYCLE_10_SRTS\11_DWG\SHEETS\ES049004-5.DWG (1-5049004)



APPROVED:

DATE: FEBRUARY 24, 2023

ANN MADER STILLMAN,
DIRECTOR OF PUBLIC WORKS
R. C. E. # 47882 / EXPIRES 12-31-2023



G
5 SIGN R2-1 (25 MPH) (CA)
(NOT TO SCALE)



H
5 SIGN S4-3P (CA)
(NOT TO SCALE)



I
5 SIGN SR4-1 (CA)

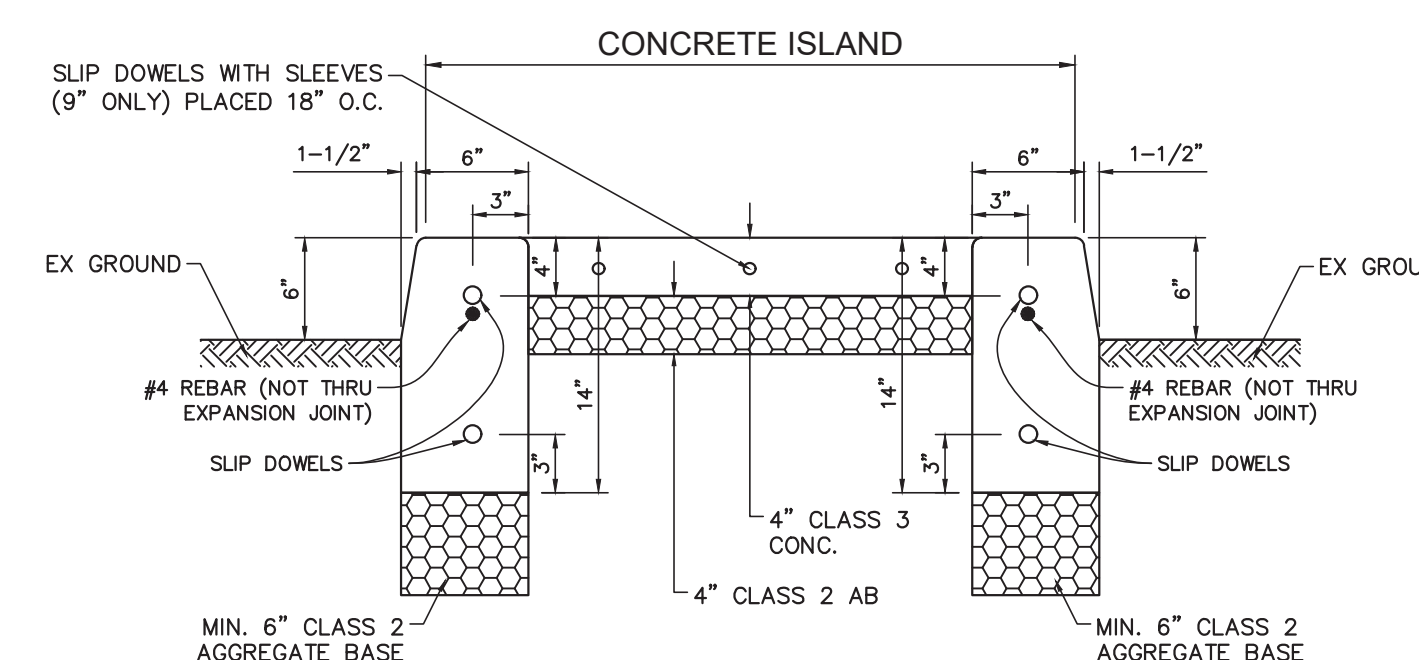

D
5 VERTICAL CURB AND ISLAND DETAIL
(NOT TO SCALE)

- NOTES:
1. ALL CONCRETE TO BE CLASS 3 CONCRETE.
 2. MINIMUM SIDEWALK THICKNESS = 4 INCHES PCC.
 3. PLACE 1/2" DIAMETER X 18" LONG DOWELS AT EXPANSION JOINTS AS SHOWN.
 4. PLACE 1/2" THICK FELT EXPANSION JOINTS FULL WIDTH 20' ON CENTER.
 5. CONSTRUCT MONOLITHIC CURB, GUTTER AND SIDEWALK UNLESS OTHERWISE SPECIFICALLY AUTHORIZED BY THE DIRECTOR OF PUBLIC WORKS.
 6. SUB-BASE MATERIALS WITHIN 30" OF SUBGRADE SHALL BE COMPACTED TO 95%.

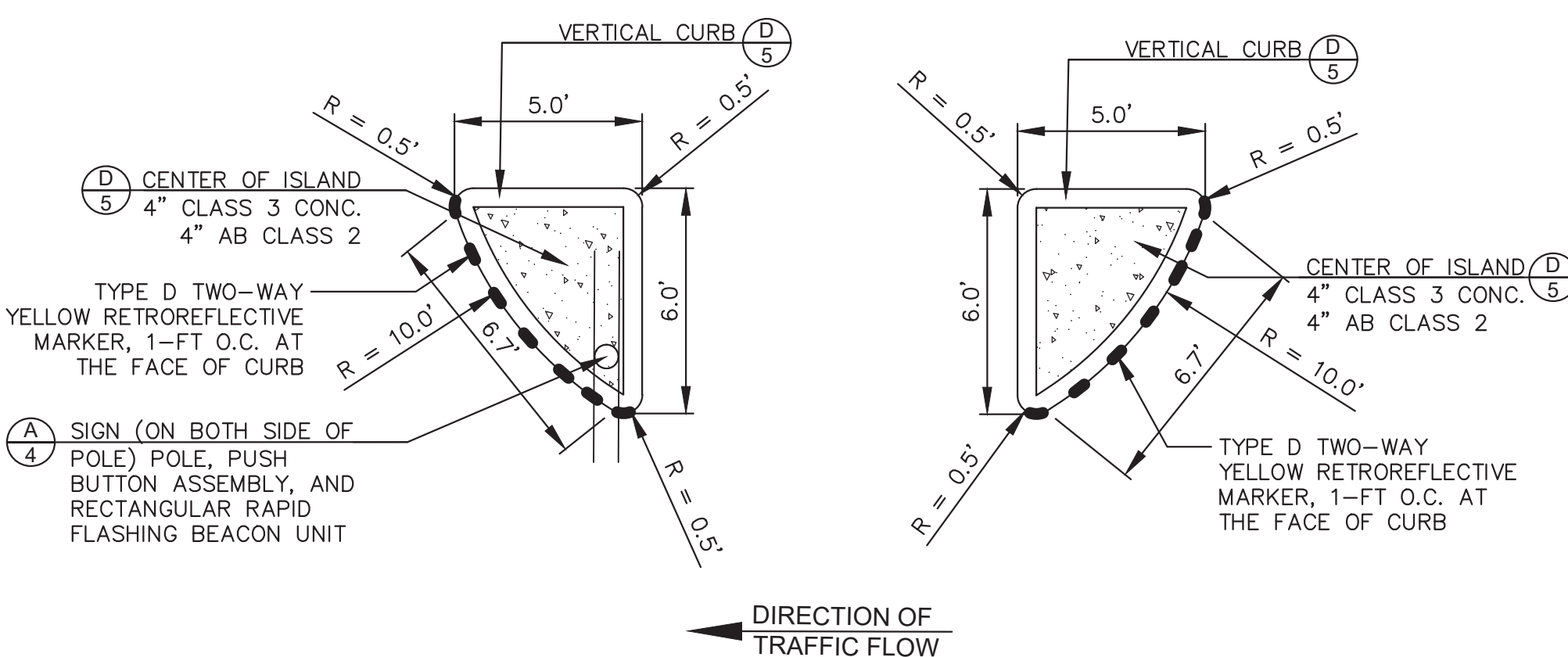

A
5 CONCRETE CURB ISLAND DETAIL
AVENUE ALHAMBRA
(NOT TO SCALE)

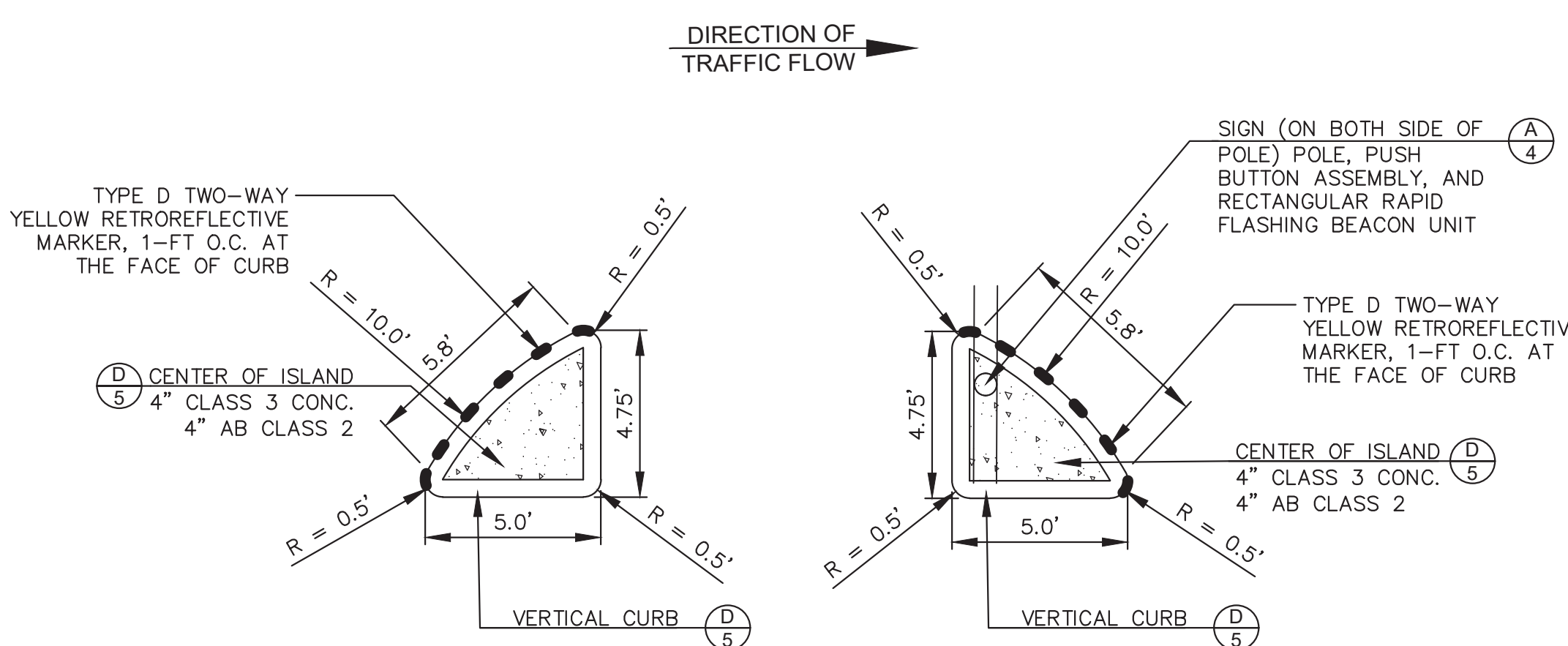

- NOTES:
- 1.) ALL CONCRETE IN THE EL GRANADA AREA AT AVENUE ALHAMBRA SHALL BE TERRA COTTA (COLOR NO 10134 - DAVIS COLORS) COLORED CONCRETE.
 - 2.) CURB RAMPS SHALL HAVE A DETECTABLE WARNING SURFACE THAT EXTENDS THE FULL WIDTH AND 3'-0" DEPTH OF THE RAMP. DETECTABLE WARNING SURFACES SHALL BE YELLOW AT BUNKER HILL DRIVE AND AVENUE ALHAMBRA AND CONFORM TO THE DETAILS ON THIS PLAN, THE REQUIREMENTS OF THE SPECIAL PROVISIONS AND THE DIRECTIONS OF THE ENGINEER.

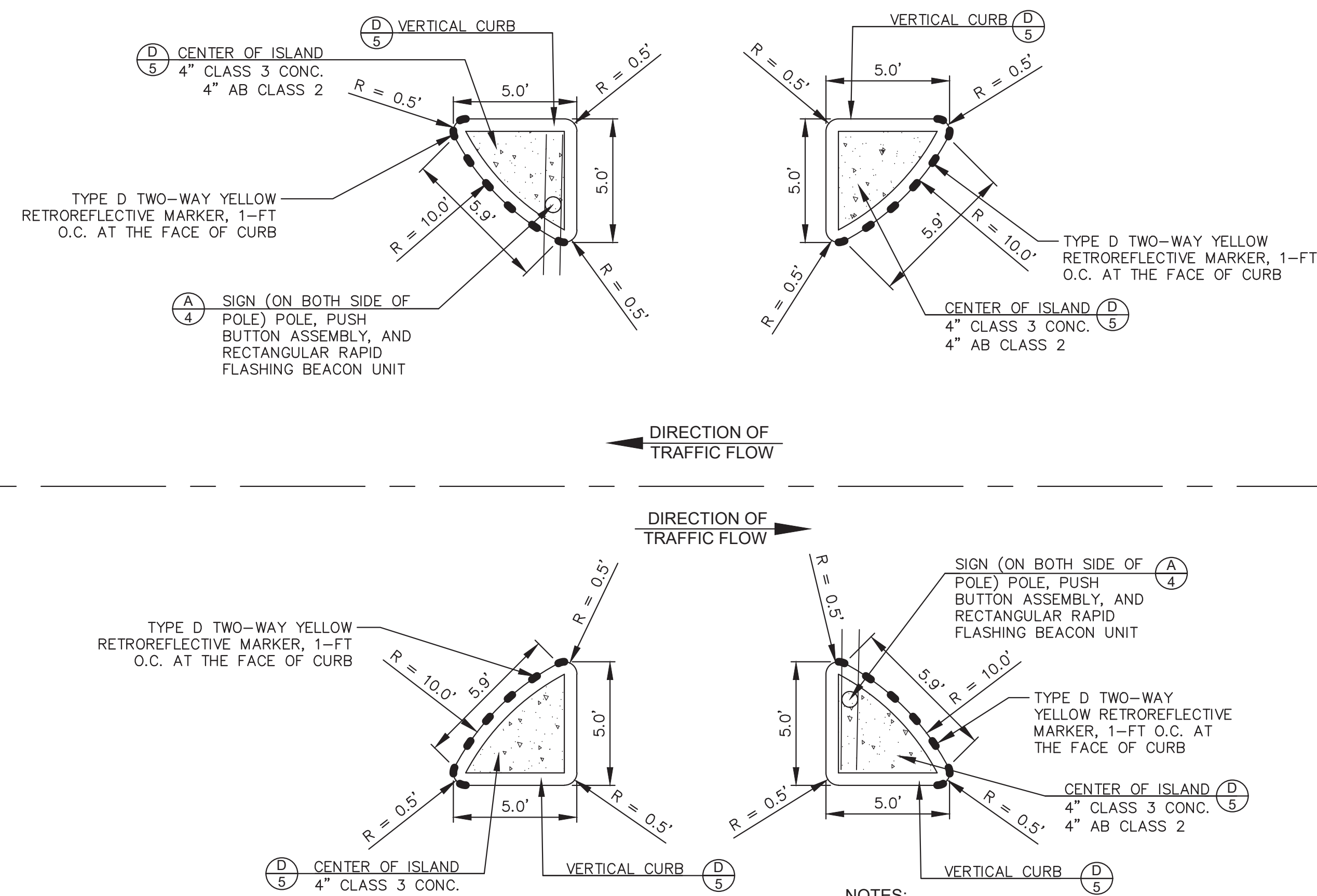

B
5 CONCRETE CURB ISLAND DETAIL
BUNKER HILL DRIVE
(NOT TO SCALE)

- NOTES:
- 1.) ALL CONCRETE IN THE EL GRANADA AREA AVENUE AT ALHAMBRA SHALL BE TERRA COTTA (COLOR NO 10134 - DAVIS COLORS) COLORED CONCRETE.
 - 2.) CURB RAMPS SHALL HAVE A DETECTABLE WARNING SURFACE THAT EXTENDS THE FULL WIDTH AND 3'-0" DEPTH OF THE RAMP. DETECTABLE WARNING SURFACES SHALL BE YELLOW AT BUNKER HILL DRIVE AND AVENUE ALHAMBRA AND CONFORM TO THE DETAILS ON THIS PLAN, THE REQUIREMENTS OF THE SPECIAL PROVISIONS AND THE DIRECTIONS OF THE ENGINEER.



E
5 SIGN SW24-3 (CA)
(NOT TO SCALE)

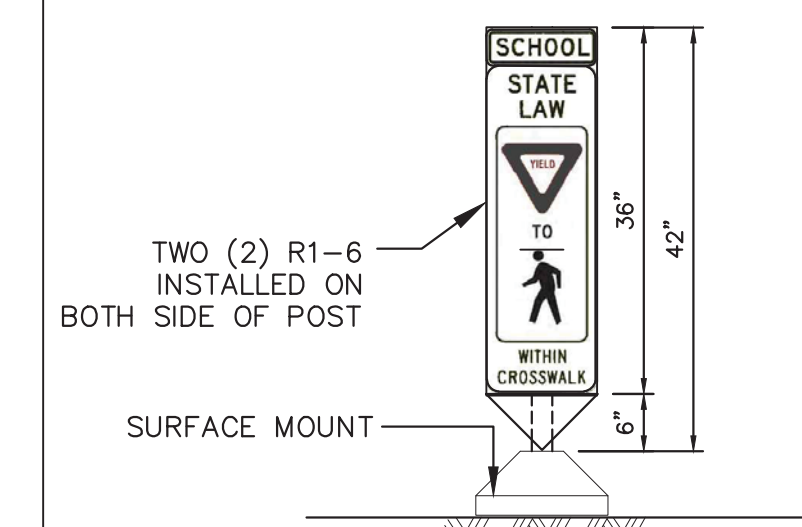

F
5 SIGN R1-6 (CA)
DELINEATOR DETAIL
(NOT TO SCALE)



DESIGNED BY: JS	BUNKER HILL DRIVE AND AVENUE ALHAMBRA	SCALE: AS SHOWN
CHECKED BY: WN	SAFE ROUTES TO SCHOOL PEDESTRIAN IMPROVEMENTS PROJECT	DATE: 02-24-2023
DRAWN BY: JS	MISCELLANEOUS DETAILS	FILE NO.: 1/5049
ANN MADER STILLMAN, DIRECTOR OF PUBLIC WORKS COUNTY SAN MATEO		555 COUNTY CENTER, 5th FLOOR REDWOOD CITY, CALIFORNIA 94063
REVISION	DATE	
FOR REDUCED PLANS ORIGINAL SCALE IS IN INCHES		5 SHEET 5 OF 5

FILENAME: F:\USERS\DESIGN\CD\ES049000_HSIF_CYCLE_10_SRTS\11_DWG\SHEETS\ES049004-5.DWG (1-5049005)